



# The Elton Echo

A voice for everyone in Elton and Gratton

Winter 2016/17

[www.eltonderbyshire.com](http://www.eltonderbyshire.com)

Issue No. 48

## THE EDITORIAL TEAM

would like to wish all our  
**Readers, Contributors, Advertisers**  
**Distributors and Printers**

**A VERY MERRY CHRISTMAS**  
**and a**  
**HAPPY, HEALTHY &**  
**PROSPEROUS**  
**NEW YEAR**

### Editorial Policy

We welcome your news, views and articles of interest, provided they are not anonymous, libellous or offensive. Views expressed are not necessarily those of the editorial team. Items may be condensed where necessary.

News items, for sale/wanted adverts and announcements are free to Parish residents. For business advertising rates please contact John Wellington 650857.

If you would like to join the editorial team please contact one of us.

### Echo Editorial Team

John Moseley 650760

John Wellington 650857

Faith Johnson 650760

Please send us your news, views, stories and diary events (for March, April, May & June) no later than:-

#### Next Copy Date

**Monday - 27th February 2017**

to: John Wellington

Stride Cottage,  
Main Street, Elton.

Preferably by email in MSWord to:  
[eltonecho@tiscali.co.uk](mailto:eltonecho@tiscali.co.uk)  
or on CD or handwritten

## Diary Dates

### December

- 1 Parish Council meeting 7.30pm VH
- 4 Turning on the Christmas Lights 6pm then mulled wine & mince pies in the village hall
- 9 Quiz Night 7.30pm VH
- 12 School Christmas Concert 6pm CH
- 24 Crib Service 4pm CH
- 25 Christmas Day Service 8am CH
- 31 Ringing in the New Year 11.45pm CH

### January

- 5 Parish Council meeting 7.30pm VH
- 13 Quiz Night 7.30pm VH
- 17 ELHG 7.30pm VH

### February

- 2 Parish Council meeting 7.30pm VH
- 10 Quiz Night 7.30pm VH
- 21 ELHG 7.30pm VH

### March

- 2 Parish Council meeting 7.30pm VH
- 10 Quiz Night 7.30pm VH
- 21 ELHG 7.30pm VH

### Weekly events

**Tea/Coffee & Toast in Church** - every Thursday 10.30am - 12.00pm

**Gentle Keep Fit** - every Tuesday at 2pm in the Village Hall

### Fortnightly events

#### **Grey Bin & Food Caddy Collection**

Every other Wednesday - from 14th September

#### **Blue & Green Bin & Food Caddy Collection**

Every other Wednesday - from 7th September

**Four-weekly Mobile Library** - see back page

# Village News and Views

## Councillors Corner

### Christmas tree light-up

This year's Christmas Tree Light-up will take place on Sunday 4 December at 6pm. Everybody is welcome to join us.

The evening will start with a gathering at the Village Mere (by the telephone box) where carols will be sung and we will light-up the first of Elton's Christmas trees. We will then move on to the church to light-up the second. Once the trees have been lit, everyone is warmly invited for mulled wines and mince pies at the Village Hall.

Following the success of last year's visit, we are delighted that the Tideswell Silver Band will be joining us again to play Christmas carols and music for all to enjoy. The Duke of York pub will also be open from 7pm so that those who want to continue celebrating the start of Christmas can do so.

### Winter maintenance

The cold has arrived and weather reports are already threatening snow. The Parish Council will soon be receiving a tonne of grit from Derbyshire County which will allow us to independently refill grit bins and salt our pavements and roads in the event of heavy snowfall.

As in previous years, the Parish Council is looking for volunteers who would be willing to participate in the snow clearing scheme. We would be happy to provide households with several sacks of grit so that when it does snow you can help to clear snow and salt the pavements around your home. Please contact me if you think you can help.

The Parish Council will aim to refill all grit bins by the end of November or the start of December. Throughout the winter, should you find a grit bin that needs restocking, please contact me and I will try to fill it as quickly as possible. Again, any help you can give with refilling grit bins would be greatly appreciated.

### Consultation on charging for replacement waste & recycling containers

I would like to thank everybody who took part in the District Council's consultation about plans to introduce charges for new waste and recycling containers. I would also like to thank those people who contacted me directly to let me know their views on this matter. A good number of points were made, with the majority being opposed to charging for new bins. The Council will make a decision on this issue early in the New Year. I will report back on the outcome.

### Gratton Lane

Works have recently been carried out to Gratton Lane to fill a large number of potholes and repair damage to the road. Although there has been a significant improvement, the Parish Council and I are asking for further repairs to be carried out where works have been poorly done and to those parts that have been missed.

*Continued on page 4*

#### Parish Councillors

John Moseley	Chair	650760	All correspondence to the Clerk:
Colin Swindell	V.Ch	07816 986956	Janice Jackson Tel: 650727
Cath Dawe		650649	8 Bradley Close
Nigel Mason		650440	Birchover
Janet Mallichan		650034	DE4 2BG
Maralyn Marsden		650589	

#### District Councillor

Colin Swindell 07816 986956

#### County Councillor

Simon Spencer 01335 324324

#### Member of Parliament

Patrick McLoughlin,  
Derbys West Constituency Office  
01332 558125

## Village News and Views

### All Saints Church

Team Rector: Canon David Truby 824707  
 Church Warden: John Spreadborough 650829  
 Anne Wellington 650857

### Monthly Services

1st Sunday 9.30am Book of Common Prayer  
 2nd Sunday 6.00pm Sanctuary  
 3rd Sunday 9.30am Parish Eucharist  
 4th Sunday 6.00pm Evensong  
 5th Sunday Where this occurs, we will join with the Methodists. Please refer to church notice board for details.

For me, November is the month where everything changes. The autumn is well on, and the cold frosts of early winter often greet us in the morning. I have a birthday early in the month; a reminder of the passage of time and how I'm changing as time goes on. All Souls, the time when the church remembers the departed, is marked with memorial services when people come to reflect upon their loss and shed tears for one remembered with love. Remembrance Sunday is the day of national remembrance and a reminder of how conflict has shaped and changed our nation over the years. It's on 13<sup>th</sup> November at 10.50 am, and everyone is welcome to join us.

As the month goes on, then there is a change of mood, from the sober, sombre days early in the month of reflection to a gathering pace towards Christmas. Shops are filled with "stuff" for us to buy, and lights that invite us in on the dark days of the new winter. In church, the end of the month marks the beginning of Advent, a time of preparation for the celebration of a Saviour's birth, when the service starts in darkness and gradually the church is lit by candle light, passed amongst the congregation.

No matter what the time of the year, there is always something to look forward to; something to plan for; the next thing on the agenda. At least, it may be so for most people, but as the nights get darker and longer there are many who fear the winter, not just because of the cold, but the long days of darkness and the sense of isolation, for who wants to go out "on a day like this?"

Amidst the busyness of Christmas preparations and the desire to get back to the fire, please spare a thought for that person who is on their own or isolated in some way. A kind thought or gesture, or even a call to make sure that they are "OK" is worth its weight in gold—perhaps the best sort of present we can give to anyone in the dark days of winter.

With every good wish

Canon David Truby

### Christmas Services in December

**Tuesday 13<sup>th</sup> at 8pm Compline – a short service of quiet evening prayer by candlelight**

**Sunday 18<sup>th</sup> at 6pm Lessons and Carols by candlelight with the choir**

**Christmas Eve at 4pm The Children's Crib Service (includes animals)**

**plus The Wyns Tor Singers Please dress up Children!**

**Mulled wine, soft drinks & mince pies afterwards!**

**Christmas Day at 8am The Book of Common Prayer Communion Service**

**New Year's Eve at 11.45pm – an Elton tradition, meet outside the church for**

**Bell ringing and Auld Lang Syne**

*Continued from page 2*

## **Defibrillator**

The Parish Council is now in the process of purchasing the defibrillator. Once a number of small issues have been dealt with and all paperwork is in order, we hope to see things moving very soon and the device installed.

## **Christmas wishes**

This will be the last piece I write for the Elton Echo before Christmas, so on behalf of the Parish Council and I, we would like to take this opportunity to wish everybody a Merry Christmas and a Happy New Year.

On a personal note, I would like to express my gratitude to everybody who has helped and supported me to carry out my role as District Councillor throughout 2016.

## **Can I help you?**

I am always here to help in any way I can. If you need help, have an issue of concern or know of a problem that needs fixing, please contact me. My contact details are below. If I can't help you, I will always try to point you in the right direction.

Thank you

Colin Swindell

**District Councillor**

**Winster and South Darley Ward**

Address: Laburnum Cottage, Well Street, Elton, Matlock DE4 2BY

Telephone : 07816 986 956

Email : [colin.swindell@derbyshiredales.gov.uk](mailto:colin.swindell@derbyshiredales.gov.uk)

**£850 raised for Ashgate Hospice  
Thank you for your support!**

On Saturday 29 October, we held a coffee morning fundraiser in Winster in aid of Ashgate Hospice.

At the event we served tea, coffee and cakes for local residents to sit and eat together. Alongside this we sold homemade jams, cakes and crumbles and there was also a raffle.

The event was a great success raising £650 on the day and a further £200 from donations received in the days afterwards.

We want to say a BIG THANK YOU to Elton and Gratton residents who gave so generous to the charity. We were overwhelmed with the support we got and the amount raised.

Thanks also to the rest of the family and others who helped on the day.

Thank you

**Colin and Diane Swindell**

## Elton WI...

The highlight of our Autumn programme has been a visit to Quarry Bank Mill in Styal, Cheshire, a former cotton mill and the setting for the TV play "The Mill".

We travelled via Buxton and Macclesfield and were welcomed on our arrival by a National Trust volunteer who outlined our programme for the day and set us off in the right direction. We were booked for a tour of the Apprentices house but before that there was time for a coffee and visits to the flower garden and then to the vegetable garden and orchard, at one time providing food for the apprentices, but now a source of fruit and vegetables for the Restaurant.

At the appointed time, the ringing of an old school handbell summoned us to the schoolroom where we sat at desks to be given a very informative talk on the life of the former apprentices. These were not apprentices as we know them today, but were cheap labour for the mill owner, children brought from workhouses in Manchester and further afield to work long hours in the mill in dangerous conditions and not allowed to leave until they were eighteen years of age. They also received a minimum of instruction in the 3Rs, hence the schoolroom. We were also shown upstairs to a Spartan dormitory and a medical room with the "cures" of the time including a bowl with leeches in it. Lunch followed, served to us very efficiently in a private room.

In the afternoon we toured the mill itself. There are information boards with lots of information about the rise and fall of the cotton industry in this country and the history of Quarry Bank itself. There is also some old machinery including Arkwright's spinning frame and we were able to see cotton being spun and woven as it was in homes and later in mills.

Afterwards there was the choice between taking a short walk by the river Bollin, the source of water power for the mill, browsing in the gift/bookshop or sitting in the shade eating an icecream before returning to the coach. If you have never been to Quarry Bank we recommend it for a good day out.

On the 8<sup>th</sup> December we hold our annual Christmas party, our last meeting before Elton WI is suspended. We have tried hard to keep going, but after 65 years and having made a significant contribution to life in the village we have reluctantly decided to call it a day.

Winifred Woodward  
Secretary, Elton WI

### *Editor's Note:*

*A huge round of applause must go to all the past and present ladies of Elton WI. Their contribution to village life in Elton since the early 50s is to be commended. This is a sad day for the village.*



## Outreach Service, Elton

The service is located at:

**The School House, Elton Primary School,  
Main Street, Elton**

**NEW** Opening time

**Every Thursday between 12:30pm and 2:30pm**

### Services include:

Postal services, stamps, pensions, benefits, council tax & bill payments,  
Plus car tax & cash withdrawals

*(Some services may be subject to change)*

## Village News and Views

### ELTON JUBILEE FIELD

As a member of Elton community I would like to acknowledge the good work that the Jubilee committee have carried out over many years under the stewardship of Cathy Banks.

The building of the new pavilion and all that it has entailed is a credit to all concerned. The beer festival has raised large sums of money to help with the building of the pavilion.

The village owes a huge debt of gratitude to David and Patrick Musgrave for the contribution they have made with providing workmen to carry out the installations and all the goods which they have donated. Without this help the pavilion would not be as near completion as it is.

The combined efforts of everyone concerned have made such a tremendous success in providing the village with a great building, which will be used by generations to come.

So a heartfelt thanks on behalf of the village.

John and Anthea Bent

### SHOP DEPARTURE

After almost 3 years of working as the Manager of Winster Shop, I have decided it is time to move on to new employment. My last day at the shop will be Friday 18 November.

It has been a privilege to serve as the manager of a much-valued community asset and I would like to take this opportunity to thank all the customers from Elton and Gratton who have supported the shop and I over the past few years.

I know many people will be disappointed with my decision to leave, but I will take many happy memories with me. I hope that I leave the shop in a better state than when I first started and I will continue to support the shop in any way I possibly can in the future.

Thank you

Colin Swindell

**Want to see family and friends  
without the hassle?**

**Homestead Farm  
B&B and Self-catering Cottage**

Book them in with Jean or Alan Carson

**Tel. 650359**

### The Secret @ Peak Serenity

A Christian retreat for 2 people situated in a tranquil, rural setting, 'Off the beaten track', on Harthill Moor, near Chatsworth and Bakewell. Family owned and run.

Idyllic location perfect for walkers, lovers of wildlife, photographers, artists, etc.

For details and bookings, phone/text me on 07837 725337

Email: [relax@peakserenity.co.uk](mailto:relax@peakserenity.co.uk)

Web: [www.thesecret-peakserenity.co.uk](http://www.thesecret-peakserenity.co.uk)

Thank you...

Christine Earl, Cliff Farm, nr. Elton, DE45 1LL

## Latest Elton Jubilee Field Update

Following the success of our Beer Festival and August Bank Holiday Fundraiser, work has once again commenced on the new pavilion. We are happy to report that since the last update the veranda roof, clock and stone steps have been installed. All upstairs toilets are now fully functional and minor tiling will see them completed. The ladies and gents toilets boast marble topped vanity units (marble kindly donated by AGM of Stanton in Peak).

Over 80% of the roof has been insulated and the main club room has been plasterboarded, plastered and painted. Interior woodwork, such as door frames and serving hatch, has been generously installed by R Stone Joinery. The main kitchen is complete and we also have a secondary kitchen (donated) located near the rear storeroom, which proved most useful during our summer functions.

John Buxton has been successful in securing a £500 grant towards kitchen equipment. He has also obtained various wooden tables and chairs, which again have been kindly donated.

All the lighting has been installed on the first floor including mandatory fire alarms and emergency lights. On the ground floor external lights have been wired and installed. Work on the car park continues. Gabion baskets have been constructed to form a retaining wall in the car parking area.

The electricity meter has been removed from the old pavilion and the power cable disconnected.

Many thanks must go to P&D Specialist Services whose help on this project has been invaluable.

N.B. Although dog fouling continues to be a problem, we would like to clarify that during August and September we experienced a number of badgers fouling on the field, which some people may have mistaken for dog mess. However, if you use the field to exercise your dog, please, please make sure you have a bag in your pocket, before you go out, so that you can clear up any mess your dog makes and then place it in the bin by the gate. It's called "responsible dog ownership". Don't forget the field is also a play area for children.

*The Jubilee Field Trustees*

**SCRIVENER'S**  
BOOKBINDING  
& SECONDHAND  
BOOKS AT  
42 HIGH STREET  
BUXTON  
SK17 6HB

**01298 73100**

Perhaps Derbyshire's largest second-hand bookshop with thirty thousand volumes.

## **Peak Pre School**

**A happy, friendly  
learning environment  
Ofsted rated us as 'GOOD'**

**To book a private visit or attend an open day,  
please contact Jessica Lathwood - Manager,  
School Lane, Stanton-in-Peak, DE4 2LX  
07799084244 [peakpreschool@outlook.com](mailto:peakpreschool@outlook.com)**

## **South Darley Pre-School**

At

The Burton Institute, West Bank, Winster

A safe, secure friendly home from home pre-school setting offering fun, stimulating learning experiences to children aged from 2 years to 4 years, recently moved from South Darley to Winster has spaces available. Free places available for 3 and 4 year olds and eligible 2 year olds.

Monday 9am – 3pm

Tuesday 9am – 12pm

Wednesday 9am – 3pm

Thursday 9am – 3pm

Friday 9am – 12pm

Please contact Kirsty on 07863771636 or email  
[info@southdarleypreschool.co.uk](mailto:info@southdarleypreschool.co.uk) for information,  
or pop in during opening times and see us.

Have a look at our website [www.southdarleypreschool.co.uk](http://www.southdarleypreschool.co.uk)



## Dudwood Head

"He's not from Elton, he's from Dudwood". Centuries ago no-one would have smiled at this remark, overheard at the Duke of York, because there was formerly a separate hamlet within Elton parish called Dudwood Head, and it wasn't on Dudwood Lane. Dudwood Head was located just south of Wattscliff quarry on Cliff Lane, down the path opposite the access to Cliff Farm. It was a hamlet of three houses near the barn that's there now and close to a small, square plantation. The houses in their gardens are shown in the middle of the map, which dates from about 1800. Dudwood Farm, further down the hill, wasn't built until after 1800.

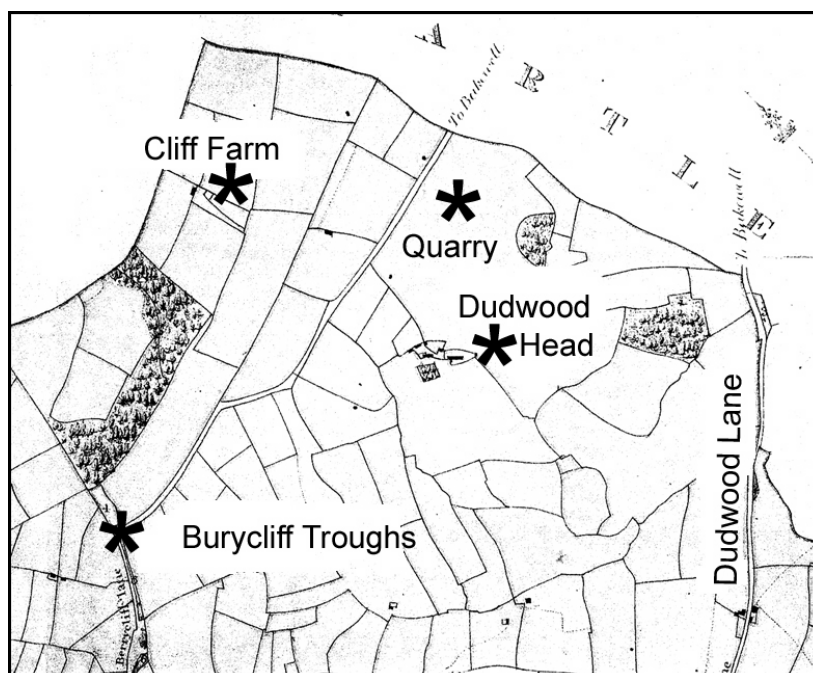

We know the hamlet existed in 1576 when a list of tithe payers included 16 householders in Elton and three at Dudwood Head, Thomas Robinson, John Robinson and Robert Staley. Towards the end of the 17th century a Robinson and a Staley family were still there and the third house was occupied by a weaver called Richard Wardlow, his wife and five children and Richard's brother, also a weaver. In their wills these people described themselves as being 'of Dudwood' not 'of Elton'.

In those days when a person died a relative or neighbour was required to take an inventory of the deceased person's goods and livestock. It is clear from these inventories that the houses at Dudwood Head were 2-up, 2-down cottages probably stone-built and almost certainly thatched. At least one of the houses was occupied until the death of John Wardlow, the last of three generations of Dudwood weavers, in 1767. The buildings shown on the map were probably ruinous by 1800.

The Robinsons and Staleys were lead miners and all three families kept a few cows and a flock of sheep. Dudwood Head would be a relatively comfortable place to live, situated on a south facing slope and close to a freshwater spring, the head of Dudwood Brook. It is now easily accessible across the fields from Elton via a recently improved footpath.

*Lynn Burnet*

**[www.eltonderbyshire.com](http://www.eltonderbyshire.com)**

The Elton village website has now been up and running for 4 years and the number of people visiting the site continues to grow.

The website provides a lot of helpful information for village residents and visitors. This includes notices about up and coming events, waste collections dates, contact details for village groups, 172 bus timetable, present and past copies of the Elton Echo, Parish Council minutes and agendas, holiday accommodation and much more.

We want to encourage more people and local groups to make use of the site. So, if you have an event you want people to know about, a business to advertise, details about your local club or a notice that you want to publish, please email it to [elton@live.co.uk](mailto:elton@live.co.uk) and we will put on the website free of charge.

If you have any comments about what we could include on the website or how to improve it, please let us know.

As well as the website, the Parish Council also has an email distribution list through which we communicate with Elton and Gratton residents. This could be information about local events or general information relating to the parish and its residents. We also send out emails on behalf of local people and organisations.

There are many households in Elton and Gratton already signed up to the email list, but if you haven't already, please send your email address to [elton@live.co.uk](mailto:elton@live.co.uk). You can send your notices for distribution to this address as well. We promise not to send you lots of emails and only things that we believe are relevant and important to Elton and Gratton. You can also unsubscribe at any time.

Any messages sent by the Parish Council on your behalf must be for the information of others only and cannot be anonymous, libellous or offensive.

Thanks

**Elton Parish Council**

**JOE REDFERN  
STONEMASONRY**

All aspects of stone work undertaken  
from restoration of historical buildings  
to new build

**Mob: 07932 654011**  
7 Elm Avenue, Matlock, DE4 3BE

**Frances Burton** Medical Herbalist

BSc (Hons) MNIMH

**Herbal Medicine Consultations**

Consultation: £40, follow-ups £20 plus herbal medicine @ £7/week

Elton residents: 25% discount on consultations, home visits available

Practice based in Ashbourne and Wirksworth

Tel: 07791326212  
[francesburton.burton@gmail.com](mailto:francesburton.burton@gmail.com)



## Helen's Trust launches campaign to celebrate 15 years service

Derbyshire based charity Helen's Trust is launching a £150,000 fundraising campaign to help secure their ongoing success as they celebrate fifteen years service this October.

The charity was established in 2001, and named after Helen Louise Lyon from Froggatt who sadly passed away with cancer, but due to a unique set of circumstances was able to achieve her wish of dying at home. She passionately believed that others should have that choice, and the charity was founded shortly after her funeral by members of her family and her doctor, Louise Jordan.

Helen's Trust has a history of supporting people with terminal illness, deemed to be within their final 6 months of life, enabling them to achieve their wish of remaining at home at the end of their illness. The charity helps up to 150 people every year, providing care, equipment and support and will consider requests for anything that will make the difference in enabling someone to stay in their own home.

Founding Trustee and Chair of Helen's Trust Board of Trustees, Dr Louise Jordan says: "It is amazing to think how fast things change in just 15 years. When the charity was set up, the great passion and determination to enable those who were terminally ill to stay in their own home was seen as ambitious.

"Now much publicity and research has been undertaken to support our vision. Yet sadly far too many people still are unable to stay in their own home, and often for the want of some imagination or flexibility or rapid response all of which Helen's Trust provides itself on providing.

"We are incredibly proud of the support we are able to give, and incredibly grateful to all of those that support us. Our latest campaign is to mark our success for the past 15 years and help to ensure our ongoing work in the years to come."

Helen's Trust needs £230,000 each year to provide their current level of services and is appealing to the public to help them raise an ambitious £150,000 through their Fifteenth Birthday Campaign.

Helen's Trust Fundraising and Business Manager Zoe Woodward says "One great thing about supporting a local charity is that you know your efforts are impacting on the people who live around you. We would love individuals, community groups and businesses to support our Fifteenth Birthday Campaign.

"Raising funds can really be fun, as well as rewarding, and there are so many ways to support a charity like Helen's Trust. You could bake 15 cakes and sell them, or run 15 miles. We will encourage and help anyone who wishes to support us through fundraising.

"Every penny or pound raised really does make a difference. £15 can fund one hour of care. £150 will pay for a whole night of a carer sitting with someone with terminal illness, ensuring their family is able to rest, safe in the knowledge their loved one is in safe hands."

We have a BT My Donate page set up that anyone who is fundraising can join in on to help us reach our £150,000 target. If you'd like to help but you're stuck for what to do, please get in touch. We have lots of ideas. Just call us on 01629 812759."

To find out more about the work of Helen's Trust and how you can support their Fifteenth Birthday Campaign visit their website [www.helenstrust.org.uk](http://www.helenstrust.org.uk).

**For further information contact:** Heidi Hawkins Chief Executive at Helen's Trust 01629 812759  
[heidi@helenstrust.org.uk](mailto:heidi@helenstrust.org.uk)



## Winster Village Shop New Winter Opening Hours

After a review of trading patterns during the Winter periods, the shop will now be open at the following times from November 1<sup>st</sup> to March 31<sup>st</sup> :

**Monday -Thursday: 8am to 6pm**

**Friday and Saturday: 8am to 7pm**

**Sunday: 8am to 5pm**

**Bank Holidays: 8am to 6pm**

Thank you for your continued support.  
**Winster Village Shop**

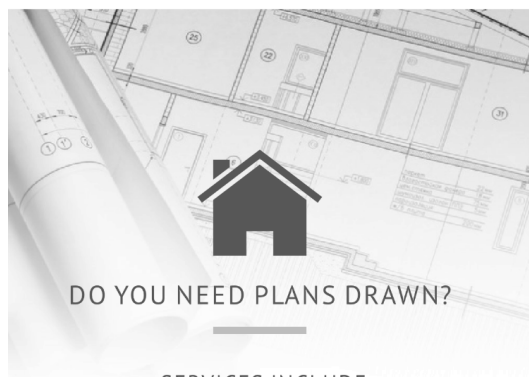

### SERVICES INCLUDE

- Site Consultation & Design Advice
- Drawings for: Conversions, Extensions, refurbishments etc.
- Sketch to CAD Drawings
- Planning Advice and Application Submission
- Building Regulations Advice & Submission
- Planning Appeals

Please call: 01629 700487

For a free site consultation.

[enquiries@apestates-design.co.uk](mailto:enquiries@apestates-design.co.uk)

[www.apestates-design.co.uk](http://www.apestates-design.co.uk)

## Calling all holiday accommodation providers in Elton and Gratton

If you would like copies of the Elton Village Guide leaflet and the Elton Village Trail booklet for your clients please contact [eltonhistory@talk21.com](mailto:eltonhistory@talk21.com) or phone Lynn on 650015.

### The Sanctuary

Cliff Farm, Cliff Lane, between Elton and Alport. DE45 1LL

Here at Cliff Farm, a Christian place of peace has been created for use by anyone in need of relief from the worries of everyday life, or relaxation.

Come for a coffee and experience the stillness and the quietness.

Small community groups, church groups (for away days), small businesses with little funds looking for a place to meet are welcome (great for workshops, seminars, fundraising, etc.)

Phone or text me Christine Mob. 07837 725337

Email 1: [thesanctuary@peakserenity.co.uk](mailto:thesanctuary@peakserenity.co.uk)

2: [relax@peakserenity.co.uk](mailto:relax@peakserenity.co.uk)

Christine Earl

07816 201746 / 07541 541708

# Neils Taxis

Personal logistics

Reliable Private hire / Hackney carriage  
Airports - Business / Holidays



Comfortable & spacious 6 seated Galaxy's

[www.neils-taxi.co.uk](http://www.neils-taxi.co.uk)

[neilstaxi@btinternet.com](mailto:neilstaxi@btinternet.com)

## BETTY WRIGHT - THE LAST LINK

It may be a rather sleepy area now but – trust me – Ivy Lane was the beating heart of this village in the 1960's. It was choc-full of very large families. This was perhaps best exemplified by no fewer than 25 residents in what were then the four Council Houses in the top half of the Lane. As you can imagine Ivy Lane could get very busy at school bus time!

Until she sadly passed away towards the end of September at the age of 93, Betty Wright was the very last of those 25 residents still in situ. In the last few weeks of her life Mrs Wright suffered a broken wrist and then a broken hip, but until then she had lived proudly and independently at number 4. Frail but still feisty would be a fair description of Mrs Wright in her final years.

I say Mrs Wright not Betty. Always Mrs Wright because this woman consistently commanded the utmost respect. I learnt this very early on. With six children of her own to control I soon noticed the stick she kept propped up by the back door. Rather appropriately, it had the words 'Heat for the Seat' engraved on it. Take it from me it was not for show. I witnessed its use! Though small in stature and great fun to be with – I sensed from a very early age that Mrs Wright was not one to be messed with.

But those were very happy times in Ivy Lane. The four back gardens were much bigger in those days before large chunks of them were swallowed up some years later by the Chapel Croft development. On summer Sunday afternoons there would be communal cricket on the Wright's back lawn. Their Uncle Alf would come over from Chesterfield most Sundays to visit and he was generally in charge of the game. We kids from the other three properties would peer longingly at the laughing and shrieking through the gap in the privet hedge and Mrs Wright would always encourage us to come through and join in the fun. If anyone batting was 'in' for too long a favourite trick was for Alf to engage them in conversation while Mrs Wright's husband Johnnie would bowl them out while they were distracted. It was all very chaotic but tremendous fun.

But time passes and, as I said, of those original 25 residents 24 of us had moved away or passed on leaving Mrs Wright alone as the last proud remaining link with those happy days gone by in Ivy Lane. Though a little deaf since she passed 90, her mind was still razor sharp and her sense of humour undiminished. Mrs Wright was a special lady who will be very sadly missed, not just by her large family, but by everyone who came into contact with her.

JOHN STONE

### R. Stone - Joinery

*All types of joinery work undertaken  
Free Quotations*

**Robert Stone**

3, Ivy Lane, Elton, DE4 2BX

**Mobile: 07971 815683**

### FIREWOOD FOR SALE

Seasoned hardwood logs cut & split

Builders bulk bag (1m<sup>3</sup>) £60; £5 deposit on bag

Free delivery in Elton and Gratton

Elsewhere £10 for one, £15 for 2 or 3 bags

**Tel: Simon 650209 or 07889 107008**

**Email: [simonfowler1@btinternet.com](mailto:simonfowler1@btinternet.com)**



**ELTON KWIK CRICKET TEAM**

This photo is of the Elton Kwik cricket squad taken at Wirksworth just prior to their last match of the 1998 season. Pictured are (back row left to right) Joe Redfern, Stacey Redfern, Amy Mellor, Nicola Porter, William Paine, Adam Mellor and (front row left to right) James Millward, Jack Stone, Jojo Oliver, James Lightfoot, Oliver Millward and Katie Oldfield.

For those who are not familiar with it, Kwik cricket is played with plastic equipment by children up to eleven years old. It is designed so that everyone gets to bat and bowl the same number of balls irrespective of ability. There were eight teams in our league including Parwich, Wirksworth, Clifton, Baslow, Bakewell and of course Elton. Each team would take their turn to be 'host' club which involved dividing their ground into four quarters and cutting and marking out four pitches enabling each of the eight teams to play two short games that particular evening.

The logistics for the host club were challenging to say the least. It involved approximately eighty kids arriving at the same time along with parents, grandparents and rather a lot of cars (causing quite a snarl up in Elton on those Friday evenings when it was our turn). Many of those attending had missed their tea in order to get to the venue by 6.15pm. Consequently the barbeque stall generally did a roaring trade and we always made a point of keeping the profits back to buy fish and chips for the kids (and officials!) after play on the last evening of the season. This was always keenly anticipated. Suffice to say that approximately one hour after this photo was taken, Wirksworth chippie did not quite know what had hit it.

Elton kwik cricket ran for five years from 1996 and provided fabulous enjoyment for the kids at that time. It would be really nice if some enterprising parent could revive it.

JOHN STONE

## Across

1. Decorator's seasonal bliss (4)
3. Needs an awful lot of flakes (7)
9. Rudimentary stocking hangers (5)
10. Always well received (7)
11. Appraise (8)
12. Muslim prince (4)
15. Divine messenger back (5)
16. Well-cooked bird (5)
20. Dart throwers line (4)
21. Passed through backwards (8)
23. See in the minds eye (7)
25. Disentangle (5)
26. One of Rudolph's team (7)
27. Fewer (4)

## Down

1. As 1 across (6)
2. Well spoken on the day (9)
4. Catmint (6)
5. Sunday to Saturday (4)
6. Top dog (3)
7. Obliquely (7)
8. Heavenly bodies (5)
13. Hanging for a kiss (9)
14. Firewood turned up (4,3)
17. That enigmatic wintry bird (5)
18. Fade (6)
19. Suggestions (6)
22. As 10 across (4)
24. Afflict (3)

## ROBIN'S KNOTTY CROSSWORD

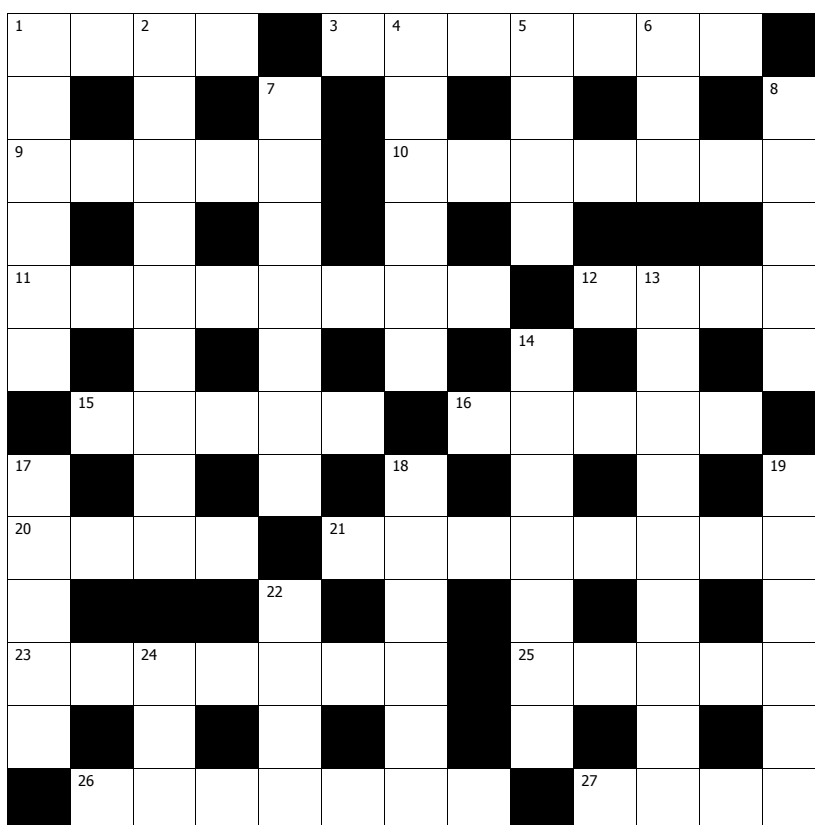

**Note:** This crossword is published here with the kind permission of its compiler, Robin Hemmingway.

**SOLUTION ON BACK PAGE**

## GARDENING SERVICE

- Garden Maintenance:- weeding borders, grass cutting, shrub pruning, planting, hanging baskets
- RHS qualified
- Small gardens only

Rate £15 per hour

- Planting Design - fixed fee on application.

Contact :- Mandy Tel. 07964 801271

Email :- mandyg3@sky.com

## DJG Taxis

**4 & 8 seater Taxi Service**

**Airports, Days/Nights out, etc.**

**Contact John Gladwin**

**Tel: 01629 650025 or**

**07767238331**

**Website: [www.djg-taxis.co.uk](http://www.djg-taxis.co.uk)**

**Email: [john@djg-taxis.co.uk](mailto:john@djg-taxis.co.uk)**

## The Small Ads

### For Sale/Wanted

**Floor Standing Pine CD unit** - holds 120 cd's in three columns - collect for FREE  
Contact John or Anne on 650857

**Child's Cot Bed** - Good quality cot with mattress. Second hand when we bought it 3 yrs ago and hardly used. £20 ono. Contact Anne or John on 650857

**Non-business adverts in this section are free to village residents**

**Contact the editor if you wish to place an advert here**

### Resources

#### Community Transport

A Dial-a-Bus service for elderly &/or disabled people operates on the 1st and 3rd Thursday each month to Buxton arriving 11.15am & departing 1.15pm. To reserve a seat, contact 641920

#### Jubilee Field

The pitches & pavilion are available for hire. For all bookings, contact Colin Swindell on 07816 986956

#### Mobile Library

Once every 4 weeks on a Friday from 2nd December 2016  
Duke of York - 10.10 - 10.45am  
Call 01629 533190 for details.

#### Post Office

#### Outreach Service

Every Thursday in the School House  
From 12.30 - 2.30pm

#### Village Hall

Hire of hall: £5.00 per session or £15 all day for residents & village organisations. Non-residents at reasonable rates.

For bookings or more information contact Sue Lightfoot 650641

#### Winster Surgery Hours

Mon – Fri 8.30am to 12noon  
Mon & Wed only 2.00pm to 6.00pm

## Village Directory

- **Badminton** Kate French 650273
- **Bell Ringers** Alastair Scrivener 650791
- **Bus services** Timetable 0870 6082608
- **Community transport** 641920
- **County Council** 08 456 058 058
- **Cricket Club** Glynn Yates 650494
- **Crime Stoppers** 0800 555 111
- **Darts Teams** Paul Carson 650359
- **District Council** 761100
- **Doctors** (Winster) 650207 Emergencies 733205 or NHS Direct 0845 4647
- **Electrical emergencies** 0800 6783 105 or New national 3 digit number 105
- **Energy Efficiency Grants** 761304
- **Fire advice** 582849
- **Gas leaks** 0800 111999
- **History Group** Lynn Burnet 650015
- **Hospital** The Whitworth, Darley Dale (minor injury only) 580211
- **Housing advice** 761311
- **Jubilee Field** Colin Swindell 07816 986956
- **Mobility Scooter** (Tissington Trail) for more details contact 01335 343156 - seasonal only
- **Pre-schools locally** - see page 8 for details
- **Police** For emergencies dial 999 otherwise dial the NEW number 101 (It's confidential)
- **Power Cut?** Call 105
- **Rail services** Enquiries 0845 7484950
- **Refuse collection** DDDC 761122
- **School** 650282
- **School PTFA** Amy Dabell 650948
- **Swimming pool** Bakewell - 814205  
Matlock - Arc Leisure - 581322
- **Taxi Service** - Kate or Neil 07816 201746
- **Tourist information** Bakewell - 813227  
Matlock - 583388
- **Village Hall** Bookings Sue Lightfoot 650641
- **Water emergencies** 0800 7834444

### CROSSWORD SOLUTION

Clues Across: 1. Tree 3. Snowman 9. Nails 10. Present 11. Evaluate 12. Amiga 15. Legna (Angel) 16. Goose 20. Oche 21. Derelict (Filtered) 23. Imagine 25. Untie 26. Blitzen 27. Less  
Clues Down: 1. Tinsel 2. Elizabeth 4. Nepeta 5. Week 6. Ace 7. Asquith 8. Stars 13. Mistletoe 14. Goleity (Yule log) 17. Robin 18. Recede 19. Offers 22. Gift 24. All