



View across Howden Reservoir

The Elton Echo

A voice for everyone in Elton and Gratton

Summer 2017

www.eltonderbyshire.com

Issue No. 50

ELTON'S ANNUAL BEER FESTIVAL

takes place on

SATURDAY 22nd JULY 2017

ON THE JUBILEE FIELD

**FROM 2 PM UNTIL MIDNIGHT
(bar closes at 11.30pm)**

A GREAT SELECTION OF REAL ALES

WITH LIVE MUSIC

FOOD SERVED ALL DAY

Camping available

Diary Dates

June

- 1 Parish Council meeting 7.30pm VH
- 20 ELHG 7.30pm VH

July

- 6 Parish Council meeting 7.30pm VH
- 18 ELHG 7.30pm VH
- 22 Elton Beer Festival 2pm to 11.30pm JF
- 29 Community Church BBQ 3pm on the Croft

August

Holiday time

September

- 7 Parish Council meeting 7.30pm VH
- 19 ELHG 7.30pm VH

Weekly events

Tea/Coffee & Toast in Church - every Thursday 10.30am - 12.00pm

Gentle Keep Fit - every Tuesday at 2pm in the Village Hall

Fortnightly events

Grey Bin & Food Caddy Collection

Every other Wednesday - from 1st March

Blue & Green Bin & Food Caddy Collection

Every other Wednesday - from 8th March

Four-weekly Mobile Library - see back page

Editorial Policy

We welcome your news, views and articles of interest, provided they are not anonymous, libellous or offensive. Views expressed are not necessarily those of the editorial team. Items may be condensed where necessary.

News items, for sale/wanted adverts and announcements are free to Parish residents. For business advertising rates please contact John Wellington 650857.

If you would like to join the editorial team please contact one of us.

Echo Editorial Team

John Moseley 650760
John Wellington 650857
Please send us your news, views, stories and diary events **(for September, October, November and December)** no later than:-

Next Copy Date

Monday - 31st July 2017

to: John Wellington
Stride Cottage,
Main Street, Elton.
Preferably by email in MSWord to:
eltonecho@tiscali.co.uk
or on CD or handwritten

Village News and Views

Councillors Corner

Thank you for your support

I want to say thank you to the residents of Elton and Gratton for their overwhelming support and votes in the recent County Council elections.

Although, I was not successful on this occasion, I am delighted with the number of votes I received across the Dovedale Division. In Elton and Winster alone, I got well over 90% of the votes cast and for that I am incredibly grateful. My vote was also good in Youlgrave and Middleton where I appeared to get the majority vote, as well as a very strong showing in Parwich. Sadly, things weren't so good the closer it got to Ashbourne!

I also want to say a big thank you to everybody who leafleted, put up posters, garden boards and encouraged me with messages of support during and after the election.

Despite not being successful in my bid to your County Councillor, it is a pleasure to continue serving and representing Winster as your District Councillor.

Councillor Simon Spencer was re-elected to serve as your County Councillor. I wish him well over the next 4 years and will work with him to address the issues affecting Elton and Gratton.

Thank you again for all your friendship and support.

Important reminder – caddy liners and black sacks

The annual delivery of free food caddy liners has started to all 34,000 homes in the Derbyshire Dales. This is being undertaken by a dedicated team – not bin collection crews – and the deliveries will take around three weeks to complete.

Elton and Gratton residents should have already received their annual supply of food caddy liners and, for those on the sack scheme, the annual supply of black and compostable sacks.

If you have not received them, please contact the District Council straightaway on 01629 761100. Anybody who has not received their liners and sacks must report it by 31 July – otherwise charges will apply after this date.

Local Projects Fund

The District Councillor's Local Projects fund has been topped up for 2017 and I am encouraging applications from Elton and Gratton.

Continued on page 4

Parish Councillors

John Moseley	Chair	650760	All correspondence to the Clerk:
Colin Swindell	V.Ch	07816 986956	Janice Jackson Tel: 650727
Cath Dawe		650649	8 Bradley Close
Nigel Mason		650440	Birchover
Janet Mallichan		650034	DE4 2BG
Maralyn Marsden		650589	

District Councillor

Colin Swindell 07816 986956

County Councillor

Simon Spencer 01335 324324

Member of Parliament

Patrick McLoughlin,
Derbys West Constituency Office
01332 558125

Village News and Views

All Saints Church

Team Rector: Canon David Truby 824707
 Church Warden: John Spreadborough 650829
 Anne Wellington 650857

Monthly Services

1st Sunday 9.30am Book of Common Prayer
 2nd Sunday 6.00pm Sanctuary
 3rd Sunday 9.30am Parish Eucharist
 4th Sunday 6.00pm Evensong
 5th Sunday Where this occurs, we will join with the Methodists. Please refer to church notice board for details.

Church News

The Wirksworth Team has two new recruits.

Well not quite! For the last few years the team has been well served by Rod Prince and John Spreadborough, who have acted as Readers. This means that they have had a licence from the Bishop to preach and assist with services and the pastoral work around the parishes that we serve.

John is well known to people in Elton as he lives in the village. Both have then have come from different directions to the conclusion that they wish to offer themselves for

ordination as priests within the Church of England, and having gone through a rigorous selection procedure, both have been accepted to begin training.

Neither John nor Rod will be leaving the Wirksworth Team once their training is over. They will continue to act in a similar capacity as before, though they will both be able to do more in that they will be able to preside at the Communion Service, baptise and marry. Their contribution, therefore, will be greater than before, and at a time when the number of full time clergy across the whole of the Church continues to fall, their services will remain invaluable to us.

As before, both Rod and John will be taking services around the team churches, though John will be more focused on Elton, whereas Rod will focus on Brassington which is where he currently lives.

It's a little while before their training will be complete, so no changes for the present, but we wish them well as they begin on this stage of their Christian journey.

Canon David Truby (Team Rector)

COMMUNITY CHURCH BBQ

With entertainment

On 29th JULY 2017

From 3pm ONWARDS

HELD ON THE CHURCH CROFT, WELL STREET

EVERYONE WELCOME

JUST BRING YOUR OWN TIPPLE

Continued from page 2

The scheme allows me to grant small sums of money to community groups, clubs and organisations in my council ward. This year I have £900 which applicants can use to fund one-off projects or purchases, such as trips out, buying equipment or funding an event.

The minimum grant that can be awarded is £100 and the maximum is £1000 but I am aiming to distribute funding as evenly as possible across the three parishes I represent – Elton, Winster and South Darley. I am also looking to grant money to groups that have not already done so.

Can I help?

I am always here to help in any way I can. If you need help, have an issue of concern or know of a problem that needs fixing, please contact me. My contact details are below. If I can't help you, I will always try to point you in the right direction.

Thank you

Colin Swindell
District Councillor
(and Independent Candidate for Dovedale Division 2017)

Address: Laburnum Cottage, Well Street, Elton, Matlock DE4 2BY
Telephone: 07816 986 956

County Council elections results

Elections were held on Thursday 4 May 2017 to elect a County Councillor for the Dovedale Division – which includes the parishes of Elton and Gratton.

The results were declared on Friday 5 May 2017 and were as follows:

Martin Aiton (Liberal Democrats) 241
Tom Barker (Labour) 433
Simon Spencer (Conservative) 1825 – ELECTED
Colin Swindell (Independent) 1250
John Robin Youatt (Green Party) 132

Simon Spencer holds the seat for the Conservatives. The turnout was 42.3%.

The overall result saw the Conservatives winning 37 seats, Labour 24, and Liberal Democrats 3. The Conservatives have a majority of 10 councillors and take back control of Derbyshire County Council from Labour who have been in control for the past 4 years.

For a full breakdown of the results, please visit the County Council website.

Village News and Views

Grateful Thanks

My belated but grateful thanks go to all the kind people who sent me such beautiful cards and messages when Doug died.

I have been greatly comforted by their sentiments and feel I am privileged to live in such a caring community. Elton is a very special village.

My sincere thanks.

Marjorie Griffith
Mere Close, Back Lane

The Winster And Elton Luncheon Club

Will be holding its AGM. on Monday 19 June at 2.30 in the Jubilee Room at the Burton institute in Winster. All interested parties are welcome!

Thank you
Rosie Strauss
Hon. Sec.

Weston Park Quiz, Winster - THANK YOU

A huge thank you to all who supported and donated to the quiz held 24th March.
A fantastic £740 was raised for Weston Park Cancer Charity.

Thanks again, Ros & Don

From the Editor

On our 50th edition, I would like to thank everyone who has contributed with copy for every issue over the years, whether that be with a one-off article or a regular feature.

Your contributions have enabled me to maintain a full 16 pages each time.

Please keep them coming.



Outreach Service, Elton

located at:

**The School House, Elton Primary School,
Main Street, Elton**

NEW Opening time

Every Thursday between 12:30pm and 2:30pm

Services include:

Postal services, stamps, pensions, benefits, council tax & bill payments,
Plus car tax & cash withdrawals

(Some services may be subject to change)



New Street
Bakewell
Derbyshire DE45 1DY

T 01629 813638
E medwaycentre@btconnect.com
W www.medwaycentre.co.uk

Medway Community Centre Fund Raiser

Bakewell's Medway Community Centre is holding their annual **Grand Garden Plant Bonanza** on Saturday 3rd 11am to 4pm and Sunday 4th June from 11am to 2pm. Garden Centre quality plants at bargain prices. Come along and buy everything you might need to complete your garden this summer. A great selection of plants from annuals and perennials, herbaceous plants, shrubs and trees will be on sale at this fundraising event. A scrumptious cafe will be available and entry is free. Come and support your local Community Centre. Margie Stuckey, Centre Administrator said "All proceeds raised on the day will go towards the upgrading of the facilities at the Centre. Due to the great success over the last two years this event has now become a regular feature on our calendar, and we look forward to continued support from the local community and visitors. Who can resist great value plants at this time of year?"

For any other information please contact Margie or Fiona on 01629 813638, email enquiries@medwaycentre.co.uk or visit the website at www.medwaycentre.co.uk

**Want to see family and friends
without the hassle?**

**Homestead Farm
B&B and Self-catering Cottage**

Book them in with Jean or Alan Carson

Tel. 650359

The Secret @ Peak Serenity

A Christian retreat for 2 people situated in a tranquil, rural setting, 'Off the beaten track', on Harthill Moor, near Chatsworth and Bakewell. Family owned and run.

Idyllic location perfect for walkers, lovers of wildlife, photographers, artists, etc.

For details and bookings, phone/text me on 07837 725337

Email: relax@peakserenity.co.uk

Web: www.thesecond-peakserenity.co.uk

Thank you...

Christine Earl, Cliff Farm, nr. Elton, DE45 1LL

Village News and Views

ELTON RESIDENTS ARE WARMLY WELCOMED TO WINSTER GARDEN AND COUNTRYSIDE GROUP'S MEETINGS IN 2017

June 22 nd	AGM and visit to Esther Cook's garden. NB 6.30pm start	
July	Day trip t.b.a.	
August	No meeting	
September 28 th	English Roses	Stuart Dixon
October 26 th	Woodturning - Art or Craft	Geoff Dalton
November 23 rd	Derbyshire Wild Life Trust	Kate Lemon

All meetings are held on a Thursday at the Burton Institute, Winster at 7.30pm unless indicated otherwise. Annual membership for 9 meetings £15, one meeting £4.

The Grand Pavilion Matlock Bath

First ever - LITTLE BIT SCRUFFY DRAMA FESTIVAL

Raising money for restoration

A series of workshops and plays taking place during June

Full details and tickets from Restoration Cafe or online

www.thegrandpavilion.co.uk



JPB SERVICES
Property Maintenance, Decorating & Gardening
4 East End
Elton
Matlock
Derbyshire
Home: 01629 650 593
Mobile: 07966526946
jpb-services@hotmail.co.uk

Peak Pre School

**A happy, friendly
learning environment
Ofsted rated us as 'GOOD'**

**To book a private visit or attend an open day,
please contact Jessica Lathwood - Manager,
School Lane, Stanton-in-Peak, DE4 2LX
07799084244 peakpreschool@outlook.com**

South Darley Pre-School

At

The Burton Institute, West Bank, Winster

A safe, secure friendly home from home pre-school setting offering fun, stimulating learning experiences to children aged from 2 years to 4 years, recently moved from South Darley to Winster has spaces available.
Free places available for 3 and 4 year olds and eligible 2 year olds.

Monday 9am – 3pm

Tuesday 9am – 12pm

Wednesday 9am – 3pm

Thursday 9am – 3pm

Friday 9am – 12pm

Please contact Kirsty on 07863771636 or email
info@southdarleypreschool.co.uk for information,
or pop in during opening times and see us.

Have a look at our website www.southdarleypreschool.co.uk

SAD GOODBYES

Sadly, the month of February saw the loss of two notable former residents of the village.

Aly Piggott, who was 77, originated from Youlgrave but moved here following his marriage to Elton girl Jennifer Walker. Their first home was on West End in a house which they romantically re-named 'Jenaly'. Later on – they moved to larger premises at the opposite end of the village where they raised their two sons Anthony and Richard, both of whom are always particularly welcome visitors when they come back to Elton.

At his funeral in Elton Church, Aly was very accurately described as community-focussed. There are too many village activities with which he was associated to list in this short piece but they ranged from running the youth club for a time at one end of the age spectrum, to being a member of the village fire brigade at the more mature end of things. But it is perhaps his development and organisation of the very successful 'Its a Knock-out' events for which he will be best remembered. This was at the time the village was striving to raise the funds required to purchase the playing field.

I was a member of Aly's Elton team but it is only now that I come to appreciate just how many arms he must have twisted, and how many favours he must have called in to persuade so many villages and organisations to turn up with teams and their supporters. This, combined with Aly's consistently good fortune with the weather, ensured that the events were always very well attended and were significant fundraisers. No-one who was there could ever forget the time when the water tank used in some of the events burst its sides with a mighty crash and caused a short-term flash flood!

Born in 1921, Joan Andrews hailed originally from Chilwell near Nottingham. As a young woman during the Second World War Joan did her bit as a 'Land Girl' in Leicestershire. For those who don't know – Land Girls were members of the 'British Women's Land Army' an organisation created to solve the problem of the shortage of agriculture workers with so many men in the forces. On a visit here to see her cousins in Moor Lane Joan caught the eye of Elton soldier Tom Andrews who was home on leave. The rest is history. Tom and Joan were married in 1943 with the war still underway. After an early stint in Ivy Lane, they spent most of their married life at Roseneath in Main Street where they raised two sons. Michael is a professional motor cyclist whose career I have described at some length in a previous article for the Echo. Mick's younger brother, Barry, is a (now retired) head teacher.

As a consequence of their wartime experiences Tom and Joan both took their Remembrance responsibilities very seriously. Along with Tom's sister Rene, Joan sold poppies door-to-door in Elton for more years than anyone can remember. Joan and Rene each received a special award from the Royal British Legion when they reached twenty-five years of poppy selling but they carried on for a good few years after that.

Joan had reached the age of 95 when she died. Sadly, she suffered from Alzheimers towards the end of her life and, as a consequence, spent her final years in residential care in Matlock Bath.

JOHN STONE

John Conolly Trawlertown

An affectionate portrayal in song and story
of the Grimsby fishing community

Friday 16 June at 8pm
in the

Burton Institute, Winster DE4 2DQ

Tickets £8 (£6 for children) from Winster Post Office or
01629 650090 or geoff@orchardmine.co.uk

Bar opens 7.15pm

JOE REDFERN

STONEMASONRY

All aspects of stone work undertaken
from restoration of historical buildings
to new build

Mob: 07932 654011

7 Elm Avenue, Matlock, DE4 3BE

GARDENING SERVICE

- Garden Maintenance:- weeding borders, grass cutting, shrub pruning, planting, hanging baskets
- RHS qualified
- Small gardens only

Rate £15 per hour

- Planting Design - fixed fee on application.

Contact :- Mandy Tel. 07964 801271

Email :- mandyg3@sky.com

Whose turn is it for a bath this week?



This photo was taken in Well Street probably towards the end of the 19th century. A notice was put on the pump at the bottom of the street in 1923 warning that the water was contaminated and should be used only for washing and other domestic purposes, not for drinking. In 1932, in an attempt to prevent dirty surface water draining into the well, the Parish Council recommended that the stone pavers covering it should be cemented and a wall should be built around the pump above it. That was when 5-year-old Harry Garner was living nearby in what is now Laburnum Cottage. As soon as he was old enough, his mother sent him every day after school down to the troughs at Burycliff to collect the family's drinking water. Harry once said to me, "When we got mains water to the village about 1940 I thought I was in heaven. I only had to carry my heavy bucket from the stand tap at the top of the street". All the village stand taps were in use as late as 1956 because many properties were still not connected to the mains.

On the left of the photo is the chimney of 'The Square' on West End. In the early 20th century the single-storey building in front was William Stone's grocery shop. The small light patch, just below the left arm of the lady's yoke is where a flight of steps came down from the rector's garden allowing a short cut to the church. Next time you walk past, look at the wall behind the telegraph pole; you can still see the bottom step. The building on the right of the photo was demolished about 1925. This was the end of a row of three cottages that stood where last summer there was a magnificent display of Dahlias. Recent activity there suggests we'll be in for a similar treat this summer!

Lynn Burnet

A copy of this photo has recently been given to Elton Local History Group. Please let Lynn know if you have any further information about it.

Frances Burton
BSc(Hons) MNIMH
Medical Herbalist



Herbal Medicine Consultations

Consultation: £40, follow-ups £20 plus herbal medicine @ £7/week

Elton residents: 25% discount on consultations, home visits available

Practice based in Ashbourne and Wirksworth

Tel: 07791326212

francesburton.burton@gmail.com

Facebook: Frances Burton the Herbalist Derbyshire Dales

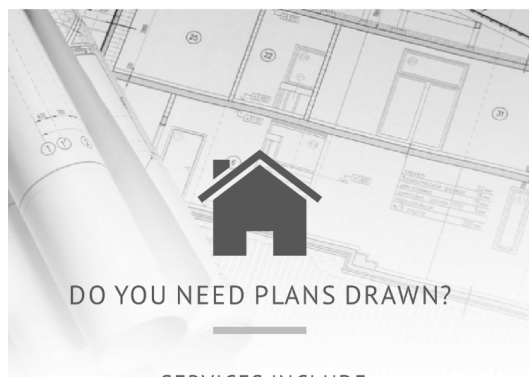

SERVICES INCLUDE

- Site Consultation & Design Advice
- Drawings for: Conversions, Extensions, refurbishments etc.
- Sketch to CAD Drawings
- Planning Advice and Application Submission
- Building Regulations Advice & Submission
- Planning Appeals

Please call: 01629 700487

For a free site consultation.

enquiries@apestates-design.co.uk

www.apestates-design.co.uk

Calling all holiday accommodation providers in Elton and Gratton

If you would like copies of the Elton Village Guide leaflet and the Elton Village Trail booklet for your clients please contact eltonhistory@talk21.com or phone Lynn on 650015.

The Sanctuary

Cliff Farm, Cliff Lane, between Elton and Alport. DE45 1LL

Here at Cliff Farm, a Christian place of peace has been created for use by anyone in need of relief from the worries of everyday life, or relaxation.

Come for a coffee and experience the stillness and the quietness.

Small community groups, church groups (for away days), small businesses with little funds looking for a place to meet are welcome (great for workshops, seminars, fundraising, etc.)

Phone or text me Christine Mob. 07837 725337

Email 1: thesanctuary@peakserenity.co.uk

2: relax@peakserenity.co.uk

Christine Earl

07816 201746 / 07541 541708

Neils Taxi

Personal logistics

Reliable Private hire / Hackney carriage
Airports - Business / Holidays



Comfortable & spacious 6 seated Galaxy's

www.neils-taxi.co.uk

neilstaxi@btinternet.com



Hansons Auctioneer's Valuation Days In Support Of Helen's Trust

Hansons Auctioneers are delighted to support Helen's Trust by holding free valuation days each month until November.

The valuation days will take place at Ashford in the Water Memorial Hall, please bring along any antiques, jewellery, watches, gold, silver, ceramics and collectables, for a free valuation, however we would welcome a monetary donation on the day to Helen's Trust.

Helen's Trust has a history of supporting people with terminal illness, deemed to be within their final 6 months of life, enabling them to achieve their wish of remaining at home at the end of their illness. The charity helps up to 150 people every year, providing care, equipment and support and will consider requests for anything that will make the difference in enabling someone to stay in their own home.

Dates for your diary: Tuesday 27th June, Tuesday 29th August, Tuesday 26th September, Tuesday 31st October and Tuesday 28th November. Time 2-4pm.

We look forward to welcoming you and your treasures.

For further information contact:

Zoe Woodward - Fundraising and Business Manager at Helen's Trust

01629 812759 or email zoe@helenstrust.org.uk

R. Stone - Joinery

*All types of joinery work undertaken
Free Quotations*

Robert Stone
3, Ivy Lane, Elton, DE4 2BX
Mobile: 07971 815683

FIREWOOD FOR SALE

Seasoned hardwood logs cut & split

Builders bulk bag (1m³) £60; £5 deposit on bag
Free delivery in Elton and Gratton
Elsewhere £10 for one, £15 for 2 or 3 bags

Tel: Simon 650209 or 07889 107008
Email: simonfowler1@btinternet.com

Village News and Views

Bakewell Choral Society and Buxton Musical Society to perform Verdi's *Requiem*

Two renowned Derbyshire choirs, Bakewell Choral Society and Buxton Musical Society, will join forces to sing Verdi's *Requiem* at St John's Church, Buxton on Sunday, 18 June 2017, at 7:30pm.

Founded in 1944, the Buxton Musical Society draws on the rich cultural life of the area to form a group of singers and players who regularly perform orchestral and choral works. Under the direction of Michael Williams MBE the Society performs five or six concerts a year at St John's Church and at the Buxton Opera House.

Bakewell Choral Society is a mixed choir of around 80 members, which was founded by Richard Barnes MBE in 1978. Richard died of cancer in 2012 and Alan Eost became Musical Director and Conductor in 2013. The choir performs four public concerts each year in and around Bakewell. Concerts are a blend of sacred and secular choral music, covering a wide repertoire from classical to contemporary works.

It will be the first collaboration between the two groups, and fourteen years since Bakewell Choral Society sang in Buxton.

The *Requiem* has been described as a milestone of the choral repertoire. Verdi used all his considerable skills gained in composing 25 operas to produce this deeply felt tribute to the Italian poet and novelist Alessandro Manzoni. Sometimes criticised as being too operatic in style for the religious subject matter ("an opera in ecclesiastical robes") no-one can complain about the conviction of the composer in creating this masterpiece.

Tickets cost £12 (students and accompanied children FREE) and available from Buxton Opera House: 01298 72190 buxtonoperahouse.org.uk, members of the choir, Bakewell Bookshop, Matlock Street, Bakewell, 01629 812818, or on the door.

For further information, contact –

Liz Holloway

eholloway3@yahoo.com

Tel: 01629 582591

Winster Wakes Week Sunday 25 June to Saturday 1 July

Sunday: Crowning of the Queen 2.30. Brass band concert 4pm. Car treasure hunt, starting at Miners Standard 6pm.

Monday: Pet show 6pm. Cycle hill climb time trial 7pm.

Tuesday: Art exhibition and jazz in church 6-8pm. Quiz in Bowling Green 9.15.

Wednesday: *Bloody Murder*, folk drama about the Brittlebank duel 7.30.

Thursday: Country show in marquee (entry details in shop) 2.30-4.30. Hill race 7.30. Music quiz in Bowling Green 9.15.

Friday: Duck hunt 5pm. Talent night in marquee 7.30.

Carnival Day: Fancy dress, street stalls, entertainment, morris dancing, juggler, tug-o-war, brass band, etc 1.30 start. Children's disco and games in marquee 6.30 start. Dance to music by The Vipers in marquee 9pm.

This is just a selection. Full details in the programme, available in the shop.

Across

1. Sulky protrusion (4)
3. Tart (7)
9. Nationality of Jonathon Swift (5)
10. A true gobbler (7)
11. Relating to eggs (8)
12. Itchy escape (4)
15. Hackneyed (5)
16. Protuberance (5)
20. Requirement (4)
21. Left the straight and narrow (8)
23. Chest (7)
25. Dispatches (5)
26. Legal authorisation (7)
27. Close turnaround (4)

Down

1. Grey celled Belgian (6)
2. Apples' foundation (2,2,1,4)
4. Martial art on the up (4,2)
5. Rather sullen (4)
6. Catcher (3)
7. Careful (7)
8. Addendum (5)
13. Speedy discharge (9)
14. Samurai system (2,5)
17. Vex (5)
18. Milk curdler (6)
19. Favourite (4,2)
22. Curved top served up (4)
24. Afternoon refreshment (3)

ROBIN'S KNOTTY CROSSWORD

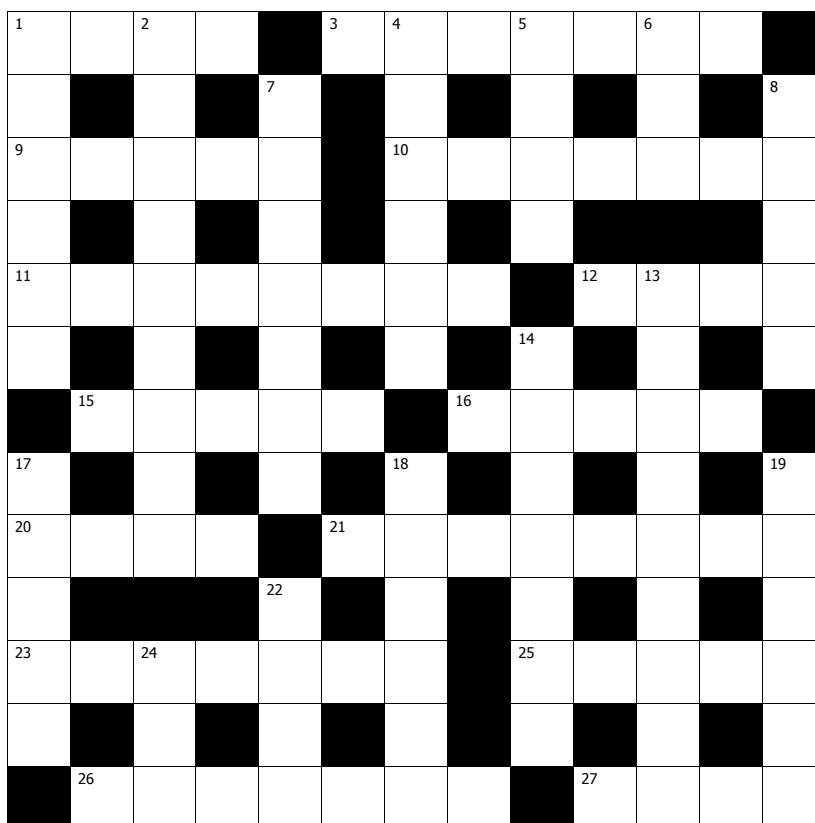

Note: This crossword is published here with the kind permission of its compiler, Robin Hemmingway.

SOLUTION ON BACK PAGE



A J Kidd
Plumbing and Heating

Reliable, local professional service from a fully-qualified and experienced tradesman

Call Alex on
07873 583550 for a free, no obligation quotation

DJG Taxis

4 & 8 seater Taxi Service

Airports, Days/Nights out, etc.

Contact John Gladwin

Tel: 01629 650025 or
07767238331

Website: www.djg-taxis.co.uk

Email: john@djg-taxis.co.uk

The Small Ads

For Sale/Wanted

Non-business adverts in this section are free to village residents

Contact the editor if you wish to place an advert here

Resources

Community Transport

A Dial-a-Bus service for elderly &/or disabled people operates on the 1st and 3rd Thursday each month to Buxton arriving 11.15am & departing 1.15pm. To reserve a seat, contact 641920

Jubilee Field

The pitches & pavilion are available for hire. For all bookings, contact Colin Swindell on 07816 986956

Mobile Library

Once every 4 weeks on a Friday from 23rd June 2017
Duke of York - 10.10 - 10.45am
Call 01629 533190 for details.

Post Office

Outreach Service

Every Thursday in the School House
From 12.30 - 2.30pm

Village Hall

Hire of hall: £5.00 per session or £15 all day for residents & village organisations. Non-residents at reasonable rates.

For bookings or more information contact Sue Lightfoot 650641

Winster Surgery Hours

Mon – Fri 8.30am to 12noon
Mon & Wed only 2.00pm to 6.00pm

CROSSWORD SOLUTION

24.Tea
8.Annex 13.Lighting 14.Ju Jitsu 17.Annoy 18.Rennet 19.Odds on 22.Emod (Dome)
Clues Down: 1.Poiet 2.Up in a tree 4.Ufgnuk (Kung Fu) 5.Dour 6.Net 7.Thriftly
16.Bulge 20.Need 21.Deviated 23.Ottoman 25.Ships 26.Mandate 27.Hgin (Nigh)
Clues Across: 1.Pout 3.Pudding 9.Irish 10.Glutton 11.Ovarious 12.Flee 15.Trite

Village Directory

- **Badminton** Kate French 650273
- **Bell Ringers** Alastair Scrivener 650791
- **Bus services** Timetable 0870 6082608
- **Community transport** 641920
- **County Council** 08 456 058 058
- **Cricket Club** Glynn Yates 650494
- **Crime Stoppers** 0800 555 111
- **Darts Teams** Paul Carson 650359
- **District Council** 761100
- **Doctors** (Winster) 650207 Emergencies 733205 or NHS Direct 0845 4647
- **Electrical emergencies** 0800 6783 105 or New national 3 digit number 105
- **Energy Efficiency Grants** 761304
- **Fire advice** 582849
- **Gas leaks** 0800 111999
- **History Group** Lynn Burnet 650015
- **Hospital** The Whitworth, Darley Dale (minor injury only) 580211
- **Housing advice** 761311
- **Jubilee Field** Colin Swindell 07816 986956
- **Mobility Scooter** (Tissington Trail) for more details contact 01335 343156 - seasonal only
- **Pre-schools locally** - see page 8 for details
- **Police** For emergencies dial 999 otherwise dial the NEW number 101 (It's confidential)
- **Power Cut?** Call 105
- **Rail services** Enquiries 0845 7484950
- **Refuse collection** DDDC 761122
- **School** 650282
- **School PTFA** Amy Dabell 650948
- **Swimming pool** Bakewell - 814205
Matlock - Arc Leisure - 581322
- **Taxi Service** - Kate or Neil 07816 201746
- **Tourist information** Bakewell - 813227
Matlock - 583388
- **Village Hall** Bookings Sue Lightfoot 650641
- **Water emergencies** 0800 7834444