



Spring Daffodils

The Elton Echo

A voice for everyone in Elton and Graton

Spring 2018

www.eltonderbyshire.com

Issue No. 53

ELTON VILLAGE QUIZ NIGHTS

Instead of only running during the winter months, due to popular demand, it has been decided to continue with the quiz nights throughout the year.

Starting from the 9th March the quizzes are on the second Friday of every month.

They are held in the village hall starting at 7.30pm prompt. Entry is £2 per person.

Everyone is welcome.

Bring along a team or just yourself and we'll fit you in.

Bring your own drinks and nibbles
And a raffle prize would be much appreciated.

All proceeds are donated to local causes.

Editorial Policy

We welcome your news, views and articles of interest, provided they are not anonymous, libellous or offensive. Views expressed are not necessarily those of the editorial team. Items may be condensed where necessary.

News items, for sale/wanted adverts and announcements are free to Parish residents. For business advertising rates please contact John Wellington 650857.

If you would like to join the editorial team please contact one of us.

Echo Editorial Team

John Moseley 650760
John Wellington 650857
Please send us your news, views, stories and diary events **(for March, April, May & June)** no later than:-

Next Copy Date
1st May 2018

to: John Wellington
Stride Cottage,
Main Street, Elton.
Preferably by email in MSWord to:
eltonecho@tiscali.co.uk
or on CD or handwritten

Diary Dates

March

- 1 Parish Council meeting 7.30pm VH
- 9 Elton Quiz Night 7.30pm VH
- 20 ELHG 7.30pm VH

April

- 2 Easter Monday - Refreshments in VH
- 5 Parish Council meeting 7.30pm VH
- 13 Elton Quiz Night 7.30pm VH
- 17 ELHG 7.30pm VH

May

- 3 Parish Council meeting 7.30pm VH
- 11 Elton Quiz Night 7.30pm VH
- 15 ELHG 7.30pm VH

June

- 7 Parish Council meeting 7.30pm VH
- 8 Elton Quiz Night 7.30pm VH
- 19 ELHG 7.30pm VH

Weekly events

Tea/Coffee & Toast in Church - every Thursday morning 10.30am - 12.00pm
Everyone is welcome

Gentle Keep Fit - every Tuesday from 1.45pm to 2.45pm in the Village Hall - £3.00 per session. See full details on page 5

Fortnightly events

Grey Bin & Food Caddy Collection
Every other Wednesday - from 14th March
Blue & Green Bin & Food Caddy Collection
Every other Wednesday - from 7th March

Four-weekly Mobile Library - see back page

Village News and Views

Councillors Corner

Elton's Defibrillator

Elton's defibrillator has now been installed and is live. It is located in the telephone kiosk on the village green, Main Street, Elton (DE4 2BW).

The device should only be accessed and used on the advice of the emergency services. If you suspect that somebody is having a heart attack, dial 999 immediately.

The Elton defibrillator has been registered with the East Midlands Ambulance Service and they will advise whether the device is needed, how to access it and how to use it. Do not try to access or use the defibrillator without the advice of the emergency services.

The device uses verbal and visual instructions on how to use it. The defibrillator will also detect whether or not the patient is having a cardiac arrest. The device will not activate if it is not needed. You cannot get it wrong or cause greater harm using a defibrillator.

At the time of writing, a community training session has been arranged to demonstrate how to use the new defibrillator. It is taking place on 28 February 2018 in Elton Village Hall starting at 7pm prompt. In case this copy of the Elton Echo does not reach you before this date, each household will have an invite posted through their door. Everybody is welcome to attend.

Notices showing the location of the defibrillator have been put up at each entrance to the village and each of the public venues – school, village hall, pavilion and church.

Finally, for those of you who are interested, a short video by Saint John's Ambulance has been posted on the Elton website demonstrating how to use a defibrillator. To view this, go to www.eltonderbyshire.com and click on the defibrillator image on the right-hand side of the webpage.

If you have any further questions or queries about the defibrillator, please do not hesitate to contact me.

Council Tax for 2018/19

Derbyshire Dales District Council is proposing to increase its share of Council Tax bills by 2.99%. At present, this is a recommendation that is being put forward by officers of the council. This proposal will be debated and voted on by Councillors at their budget meeting on 5 March 2018. A 2.99% would see a band D property paying on average 11p more a week for District Council services in 2018/19.

Like all local authorities, Derbyshire Dales District Council has seen its grant funding from the Government reduce year-on-year. This has led to the need to increase council tax and fees and charges to ensure enough money is raised to keep services running.

Continued on page 10

Parish Councillors

John Moseley	Chair	650760	All correspondence to the Clerk:
Colin Swindell	V.Ch	07816 986956	Janice Jackson Tel: 650727
Cath Dawe		650649	8 Bradley Close
Nigel Mason		650440	Birchover
Janet Mallichan		650034	DE4 2BG
Maralyn Marsden		650589	

District Councillor

Colin Swindell 07816 986956

County Councillor

Simon Spencer 01335 324324

Member of Parliament

Patrick McLoughlin,
Derbys West Constituency Office
01332 558125

Village News and Views

All Saints Church

Team Rector: Canon David Truby 824707

Church Wardens:
Anne Wellington 650857

Monthly Services

1st Sunday 9.30am Book of Common Prayer
2nd Sunday 6.00pm Sanctuary
3rd Sunday 9.30am Parish Eucharist
4th Sunday 6.00pm Evensong
5th Sunday See church noticeboard

Easter, with the preceding drama of Holy Week, takes up the vast majority of space in the record of Jesus' life. Despite the importance of what had gone on before, each of the evangelists makes considerable space for what happened from Palm Sunday onwards. Jesus' teaching, and the miraculous events which surrounded his ministry are second place in comparison with the weight that is given to his passion, death and resurrection. Why? Well, in the end, what separates Jesus from any of the other prophets who were around at the time is the claim that in some way death wasn't the end of his story, and the Gospel writers wanted to make sure that the resurrection accounts were put down

on record for everyone to see. That resurrection has proved to be a stumbling block for many who would otherwise have no problems in accepting much of what Jesus taught. What still remains hard to accept is that it is possible for him to have been raised from the dead.

The actual nature of that resurrection remains a subject of great discussion, a discussion which began soon after the historical events which led the disciples from being a defeated group of followers to highly motivated group of people determined to share the "Good News." St Paul grapples with his understanding of resurrection in his letters to the early church. Theologians continue to do so in our own day.

In the end, those who believe do so having taken a step of faith, for there can be no proof other than the change in the lives of those first followers seen in the record of scripture. Easter will remain the great mystery which is in the nature of all great truths. In the Eastern Church that mystery is summed up in the great shout of praise on Easter Day, a shout which has been taken up by the Church throughout the world. "Alleluia Christ is Risen—he is risen indeed!"

Please come and join us at our Holy Week and Easter Services:

Wednesday 28th March at 8pm Plainsong Compline

Good Friday (30th March) 2pm 'The Watch'

Easter Day (1st April) 11.15am Easter Communion – an open table so everyone is welcome

Happy Easter

Canon David Truby (Team Rector)

Easter Monday

Refreshments in the Village Hall

Homemade Sandwiches and Cakes

Tea and Coffee

From 11.30 to 2.30pm

All proceeds to Elton Church

Easter Flowers in Church

We would be grateful for any donations towards the cost of flowers to decorate the church during the Easter period.

Please give your donations to
Anne Wellington or Jean Spreadborough
Contact them on 650857 or 650829

ELTON – THE 1960's AND ALL THAT

'Elton never changes' is a familiar refrain. A visitor returning to Elton for the first time since the 1960's might beg to differ.

Almost inevitably our visitor would be struck by the reduced number of farms compared with the 1960's when they were sprinkled liberally throughout the village. As now, the largest of these by some distance was Oddo Farm which then employed a good number of men and women from the village. The women worked part-time in three large hen batteries.

But who else was farming in Elton in the 1960's? Off the top of my head I can think of Arnold Glossop (who farmed on West End), George Carson (on Main Street) and Roy Moseley (in Ivy Lane). On Moor Lane there was George Marsden with George Furniss next door. The Boam brothers farmed on Back Lane as did (on a smaller scale) Owen Carson. Then there were the Stone brothers at Woodbine Farm in Winster Lane. On the outskirts of the village were Henry Yates in Gratton, Albert Houseley at Cliff Farm (on the road beyond Burycliff) and Ben Yates at Leadmines Farm on Elton Moor. As a result of these and any others I might have forgotten, there was a steady stream of tractors up and down the road all day throughout the year. At haymaking time the village would come alive with activity and farm traffic as everyone mucked in to literally make hay when the sun shone. It was not unusual for people with other jobs in the daytime to assist particular farmers in the evening with the haymaking - and earn a few extra bob into the bargain.

In less busy times, some of the farmers would excavate old lead mining spoil hillocks on their property in search of fluorspar which was in demand from the steel plants in Sheffield. In a world before mini-diggers, this work was mostly done by pick and shovel. It was not easy money.

Another important change from the Elton of almost 60 years ago would only be apparent to our long lost visitor on Sundays! In those days Elton people would make their way to chapel in good numbers every Sunday – and they had a choice of three! Of course each of the chapels had official titles (Wesleyan, Primitive etc) but they were more commonly referred to by the names of the people from the village who ran each of them. Thus we had Mr Arnold Prince's chapel at the top of Milner Yard. The present Village Hall was Mrs Cora Ashton's chapel and the tiny one across the road from it in West End was Mrs Frances Furniss's chapel. The post-Harvest Festival auction of the produce donated at Mrs Furniss's chapel was always well attended by the kids in the village. We were in search of something called 'Thor cakes' which were always on sale there. They were unusual and delicious and I have to confess that I have never seen nor heard the name since those long gone days.

As kids in the 1960's we had a nice problem which those around today don't have. We had to decide where to go after school to spend our pocket money. We had a choice. Closest to school was the Post Office / shop which was then sited in what subsequently became Elton Cafe. Alternatively, we could wait until Mrs Mount re-opened her shop at Nelson House in Main Street at 4pm. My recall is that Milky Ways were threepence and that Mars Bars, Bounties, Crunchies and Cadbury's Milk Chocolate Bars were each sixpence. Crisps were fourpence a bag. I would generally head for Mrs Mount's where I was partial to milky chews which were a halfpenny each (two for a penny after the halfpenny was withdrawn). Needless to say – all of these prices are stated in coinage which existed before decimalisation of the currency in 1971 (but that's a wholly different story!).

Our present-day visitor would probably be disappointed to be unable to locate the fondly remembered old chip shop. This was operated in Main Street near the bottom of Ivy Lane on Tuesday and Friday evenings by Mr & Mrs Leopold ('Poly') Phillips who lived in Well Street. The fish and chips were delicious when they finally arrived but there was nearly always a problem getting the fat hot enough to fry and the place was nearly always full of impatient children not entirely sympathetic to Mr & Mrs Phillip's problems with their equipment.

The only bus service to and from Elton in the 1960's was the North Western company's Matlock service. Anyone wanting to shop in Bakewell would have to walk to the Lane Ends to catch a Silver Service bus on the Matlock to Bakewell route (which for some unknown reason avoided Elton!).

I have to mention another major change which, in Ivy Lane where I was brought up, came about at the very beginning of the 1960's. It is a rather delicate matter but one which was very significant – not to say life-changing – so it certainly deserves a mention. This was the coming of the water toilet. I won't go into the system which prevailed before the change. Suffice to say it was not particularly pleasant. As young children at the time we were very excited as the installation of the new toilets proceeded and greatly fascinated as we observed all the trench digging and pipe laying in Ivy Lane.

Along with five or six other young people, my sister and I were members of the church choir in the 1960's under the guidance of the then organist and choirmaster, Mr Ellingworth, who was head of music at Charles White School in Matlock but lived in Well Street. The evening services varied in length according to the duration of the sermon. If the sermon went on longer than we members of the choir considered acceptable, we would grow very restless. There would be whispering, giggling and noisy exchanges of sweets and associated unwrapping sounds. Try as he might, there was not much Mr Ellingworth could do to settle us down – even after he fitted a sort of rear-view mirror to the organ in order that he could keep a beady eye on us.

The morning services tended to be agreeably shorter (no sermon!) but on occasions, just as we were finally making our escape, we would be called back by Mr Ellingworth so he could acquaint us with some complicated melody he had decided to apply to the psalm at evensong. This unscheduled 'overtime' made me very grumpy but back home my weekly protests that I was 'packing up the choir' cut no ice at all. This was a different time and, by and large, we did as we were told.

In 1964 a young language teacher moved into Joules Croft with his wife Ena. The coming of Mick Patterson was simply manna from heaven for teenagers in the village. In short – Mick livened the place up. Almost immediately he got the Elton Youth Club back up and running and it quickly went from strength to strength. Meeting weekly in the upper floor of the Old Joiners Shop on West End (which doubled as the school canteen), the Club also boasted a talented six-a-side football team. As a service to the village generally, Mick and the Youth Club organised the November bonfire and firework display for a number of years. A particularly memorable occasion was a special Youth Club concert held on a stage built in the School in which members performed entertaining sketches and songs in a show written, produced and brilliantly compared by Mick.

Scribbling away merrily, I seem to have run out of space. I haven't even got on to Elton School in the 1960's. That will have to wait until another time.

John Stone

ELTON KEEP FIT

Tuesdays 1.45pm - 2.45pm
Elton Village Hall
£3.00 per session

- Stamina Improvement
- Body Toning
- Core Strengthening
- Balance Improvement
- Stretching & Relaxation

Exercises are adapted to suit a varied range of health & fitness levels and abilities, with chair based alternatives also given.

Come along and join our friendly group, making exercise fun and sociable.

For further details contact:
Helen Emmerson on 07957 369691 or email
helen.emmerson@derbyshiredales.gov.uk



Outreach Service, Elton

located at:

**The School House, Elton Primary School,
Main Street, Elton**

NEW Opening time

Every Thursday between 12:30pm and 2:30pm

Services include:

**Postal services, stamps, pensions, benefits, council tax & bill payments,
Plus car tax & cash withdrawals**

(Some services may be subject to change)

Village News and Views

Elton Keep Fit

Tuesdays 13.45-14.45pm Elton Village Hall

Are you looking at becoming a bit fitter, want to lose weight, tone up, or just simply become more mobile? Elton Keep Fit would be ideal for you. The classes are adapted to suit a varied range of health and fitness levels and abilities, with chair based alternatives given too. The classes last for 1 hour, and you aim to do as much as you're comfortable with. We focus on stamina improvement, body toning, core strengthening, balance improvement and stretching and relaxation. We have use of some great pieces of equipment such as a rowing machine, exercise trampoline, steps, weights, resistance bands, ankle weights, stability balls and discs, and agility ladders.

The group is extremely friendly and the sessions are always fun and varied. These classes are particularly suitable for anyone over the age of 50. If you're interested, but not sure it's suitable for you, why not pop along for a FREE trial session. Classes are £3 per session, paid on a pay as you go basis.

- 'Helen the instructor has the skill to find exercises to meet all abilities regardless of age, she covers balance, cardio vascular and strength workouts. I find it exhausting and yet pleasurable and would recommend it to anyone over 60.' - Peter Bell
- 'I am an OAP, disabled and go to the Tuesday Keep Fit. Helen is very good with me and the special exercises I have to do. I recommend these classes to anyone of any age or ability. If I can do it, anyone can!' - Rose Musgrave
- 'I really enjoy the classes because Helen focuses on everyone's different abilities and she has improved my fitness. I would recommend the class to anyone.' - Anne Wellington

For further information please contact:

Helen Emmerson on 07957 369691 or email:
helen.emmerson@derbyshiredales.gov.uk



**Want to see family and friends
without the hassle?**

**Homestead Farm
B&B and Self-catering Cottage**

Book them in with Jean or Alan Carson

Tel. 650359

The Secret @ Peak Serenity

A Christian retreat for 2 people situated in a tranquil, rural setting, 'Off the beaten track', on Harthill Moor, near Chatsworth and Bakewell. Family owned and run. Idyllic location perfect for walkers, lovers of wildlife, photographers, artists, etc.

For details and bookings, phone/text me on 07837 725337

Email: relax@peakserenity.co.uk

Web: www.thesecret-peakserenity.co.uk

Thank you...

Christine Earl, Cliff Farm, nr. Elton, DE45 1LL

Village News and Views

Your Village. Your Community. Your Shop.

Winster Village Shop staff are pleased to announce that we now stock a variety of meats from E.W.Coates of Two Dales and also from Redferns of Harpur Hill, Buxton. Both are locally sourced and highly regarded.

The variety includes joints, steaks, mince,sausages. We expect them to be popular so if when you come to buy you can't see what you are looking for just let us know and we'll make sure it's on the next order -
just for you!

FREE Music and Movement Sessions for Pre-School Children

As a registered charity South Darley and Winster Pre-School has been fortunate enough to receive funding from Colin Swindell's Local Councillor's Fund and Winster Secret Gardens to host a series of music and movement sessions for pre-school children.

Held at the Burton Institute in Winster the sessions are FREE to all pre-school children aged 12 months and above. You do not need to be attending the pre-school to join us. The sessions will be held on Thursday mornings from 10-11am followed by a healthy snack and drink. Come along to just one, a few, or all of ours sessions. Our next dates are the 15th Feb, 1st, 8th, 15th and 22nd March.

Please do let our manager Kirsty know if you plan to attend (so that she can plan snacks accordingly) by phoning or texting 07863771636, emailing info@southdarleypreschool.co.uk or messaging our Facebook page (simply search South Darley and Winster Pre-School).

We look forward to seeing some of you there!

Come along to our Open Day on Thursday 1st March

To coincide with our musical session we are also holding an Open Day on Thursday 1st March from 10am-2pm. Pop in anytime and join us for some fun and learn about the pre-school.

Join us for our Easter Duck Hunt

We are holding our annual Duck Hunt this year on the 18th March. Join us at the Burton Institute, Winster at 10am where we will meet before heading to a nearby field for the Duck Hunt. Afterwards there will be snacks and crafts back at the Burton Institute. All pre-school age children are welcome.

Village News and Views

Peak Pre School has a cosy and Stimulating environment with a capacity for ten children helping them feel safe and secure whilst they learn through play. We offer a wide range of activities and promote outdoor learning in our wonderful garden and allotment.

Ofsted rated GOOD in December 2015.

15 and 30 hours funded places available for 2,3 and 4 year olds.

Other funding options available.

£4 per hour for non-funded places.

3 hour sessions of 8.45am-11.45am or 11.45am- 2.45pm

Or

6 hour full days from 8.45am- 2.45pm Monday to Thursday.

To arrange a visit contact Sarah on 07799084244 or email peakpreschool@outlook.com

Attached to Stanton in the Peak Primary School,

School Lane, Stanton in the Peak,

Derbyshire, DE4 2LX

South Darley & Winster Pre-School

At

The Burton Institute, West Bank, Winster

A small friendly, family like atmosphere for children aged 2-4 years to learn, play and grow together.

Funded places available for all 3 year olds and eligible 2 year olds.

Open Term time.

Monday - Thursday 9am-12pm, 12pm -3pm.

Morning, afternoon or full day sessions available.

Please contact Kirsty on 07863771636 or 01629650867
or email info@southdarleypreschool.co.uk for information.

Have a look at our website www.southdarleypreschool.co.uk

What's behind the name?

Most Elton residents will have taken a walk along Islington Lane towards the Miners Standard and I suppose that many know that the pub got its name from the dish that was used to measure lead ore. The original standard brass dish was made around 1512 by order of Henry VIII and hangs in the Old Moot Hall in Wirksworth, the administrative centre of lead mining in the Elton area.

In the early 18th century many of Winster's self-employed lead miners lived in a hamlet on common land next to the Miners Standard, close to their mines on Winster Moor. From 1720 the London Lead Company (LLC) invested in mines in Winster Bank Pasture resulting in a considerable influx of miners and supporting tradesmen into Winster. Lead mining expert, Lynn Willies,* estimates that by the 1750s the population of Winster was as many as 2,000 (there are 600 today). The hamlet near the Miners Standard would have grown and it's possible that it gained its name of Islington in that period. I haven't been able to find out why it was so called but I wouldn't be surprised if there's a connection through the LLC to Islington in London. The LLC was a Quaker concern renowned for its benevolence towards its employees and also towards local independent miners. Maybe it had some input into the hamlet by the Miners Standard. The company withdrew from Derbyshire in the 1770s and by 1800 the population of Winster had fallen to not much more than it is today. Islington was practically uninhabited by 1810, the year of publication of Cary's map of Derbyshire (extract below).



Judging by the height of the vegetation growing on it in June, the footpath that branches off Islington Lane to the west of the Miners Standard is seldom used. In the 17th to 19th centuries though, it was well trod by miners going to and from their mines on Winster Moor, mines called Bell Holes, Brown Edge, Whitelow, Grissels and the one that gives the lane its name, Lickpenny. Lickpenny means a devourer of money and that's what most of the mines in our area did, although some were profitable some of the time. Lickpenny mine

goes back to before 1661 and was still being worked in the 1850s.

In the early 18th century there was a six-acre field called Lickpenny Wessels on the north side of Lickpenny Lane, Wessels being a corruption of Westhills. The present day Westhills Farm was known as 'The Wessels' when a 'daring robbery' took place there, so the *Derby Mercury* of 15 May 1850 tells us. At midnight the daughter of the farmer, John Smith, alerted by the dog, went to the top of the stairs and saw two men at the bottom. Quick-thinking Grace had a makeshift weapon to hand when, "*She immediately seized a cheese to throw at them but they didn't mind this*". The men entered the farmer's bedroom and stole gold and silver worth £20. "*They then rifled the pockets of his daughter and took two sovereigns and some silver and afterwards did the same to the servant boy and took 2½d. They also stole a ham, part of a cheese and some bacon.*" The newspaper didn't

Continued on page 10

Continued from page 9

say whether the burglars were apprehended, but I expect they made short work of the ham, cheese and bacon. I hope Mr Smith was kind enough to compensate the lad for his lost tuppence ha'penny (1p in modern money).

Lynn Burnet

**Winster and 18th Century Lead Mining in Mining History, the journal of the Peak District Mines Historical Society Volume 3 No 5 1968, available to download from <https://pdmhs.co.uk>*

Continued from page 2

Councillors Corner

I want to hear your views on these proposals. My job is to represent you at Council, so please let me know your comments and what you think. You can contact me using the details below. You can drop me an email with your views or contact me by telephone for a more detailed discussion.

Can I help you?

I am always here to help in any way I can. If you need help, have an issue of concern or know of a problem that needs fixing, please contact me. My contact details are below. If I can't help you, I will always try to point you in the right direction.

Thank you

Colin Swindell
District Councillor
Winster and South Darley Ward

Address: Laburnum Cottage, Well Street, Elton, Matlock DE4 2BY
 Telephone : 07816 986 956
 Email : colin.swindell@derbyshiredales.gov.uk

Stanton in Peak School PTA invites you to join us for.....

A Night at the Races



Saturday 21st April at Stanton in Peak Village Hall

Tickets £8.00 includes 2 course meal

Wine and soft drinks also available.

Doors open 7pm

For more information and to purchase tickets contact:

Janice Kingston 07920 572857 or jdcowburn@hotmail.com

All proceeds to benefit Stanton in Peak CE Primary School.

GARDENING SERVICE

- Garden Maintenance:- weeding borders, grass cutting, shrub pruning, planting, hanging baskets
- RHS qualified
- Small gardens only

Rate £15 per hour

- Planting Design - fixed fee on application.

Contact :- Mandy Tel. 07864 077209

Email :- mandyg3@sky.com

Village News and Views

A recent email received

Having lived abroad I have only recently found your site. I attach a photo taken by the Matlock paper in either 1960 or 61.



Standing L to R:

Glyn Yates. Ray Webster. Janice Dakin (?). ?? . Alan Glossop in Dress. ? Rouse. Raymond Rouse.

Front Row:

Jimmy Wright. ?? . Barry Andrews. Richard Binns (in Cat costume). Barry Hedges. David Buxton.
Ann Wright (I think). Me (at far end).

I know Ray and Richard are no longer with us but as for the others ?

Regards

Kelvin M Wilson PS if anyone wants to email me that's ok

Kelvin's email address is: kelvinmurraywilson@gmail.com



Paws First Pet Care
Professional Pet Services

- 1-2-1 Dog walking
- Home boarding for dogs
- Home visits for small animals
- Fully insurer & llicenced

Email: pawsfirstpetcare@hotmail.com
www.pawsfirstpetcare.co.uk
Tel: 01629 650693 / 07885 709074

JPB SERVICES
Property Maintenance, Decorating &
Gardening

4 East End
Elton
Matlock
Derbyshire

Home: 01629 650 593
Mobile: 07966526946

jpb-services@hotmail.co.uk



Frances Burton
BSc(Hons) MNIMH
Medical Herbalist



Herbal Medicine Consultations

Consultation: £40, follow-ups £20 plus herbal medicine @ £7/week

Elton residents: 25% discount on consultations, home visits available

Practice based in Ashbourne and Wirksworth

Tel: 07791326212

francesburton.burton@gmail.com

Facebook: Frances Burton the Herbalist Derbyshire Dales

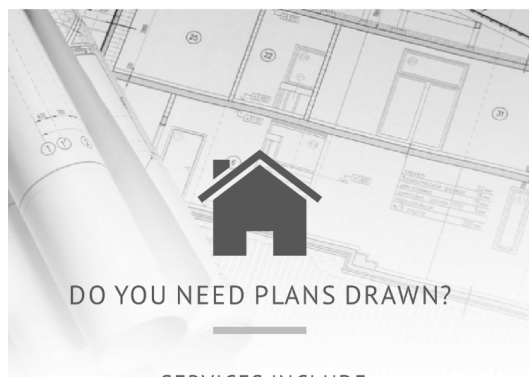

SERVICES INCLUDE

- Site Consultation & Design Advice
- Drawings for: Conversions, Extensions, refurbishments etc.
- Sketch to CAD Drawings
- Planning Advice and Application Submission
- Building Regulations Advice & Submission
- Planning Appeals

Please call: 01629 700487

For a free site consultation.

enquiries@apestates-design.co.uk

www.apestates-design.co.uk

Calling all holiday accommodation providers in Elton and Gratton

If you would like copies of the Elton Village Guide leaflet and the Elton Village Trail booklet for your clients please contact eltonhistory@talk21.com or phone Lynn on 650015.

The Sanctuary

Cliff Farm, Cliff Lane, between Elton and Alport. DE45 1LL

Here at Cliff Farm, a Christian place of peace has been created for use by anyone in need of relief from the worries of everyday life, or relaxation.

Come for a coffee and experience the stillness and the quietness.

Small community groups, church groups (for away days), small businesses with little funds looking for a place to meet are welcome (great for workshops, seminars, fundraising, etc.)

Phone or text me Christine Mob. 07837 725337

Email 1: thesanctuary@peakserenity.co.uk

2: relax@peakserenity.co.uk

Christine Earl

07816 201746 / 07541 541708

Neils Taxi

Personal logistics

Reliable Private hire / Hackney carriage
Airports - Business / Holidays



Comfortable & spacious 6 seated Galaxy's

www.neils-taxi.co.uk

neilstaxi@btinternet.com

Priority Services Register in case of a power cut or water supply disruption.

If you are vulnerable to a power cut or disruption to your water supply due to your health, age or circumstances then you can register for priority treatment from the electricity network and water supplier in the case of a service outage.

Electricity Supply

If you rely on electricity for medical equipment, are elderly, very ill or disabled then you can register for priority support in the case of a power cut. Western Power Distribution is the electricity distribution network for the midlands. Not to be confused with your electricity supplier, they are responsible for the maintenance and provision of the network and are therefore responsible for resolving any power cuts and are your first contact in the event of a power cut.

The Priority Services Register (PSR) is FREE to join and is aimed at the following people:

- Those who rely on electrical equipment for medical needs, like kidney dialysis or oxygen machines
- The elderly, disabled or chronically sick (including those with dementia)
- Those who need electrical equipment for their mobility, such as stair lifts or bath hoists
- If you have a communication need because you are blind, partially sighted, deaf or hearing impaired
- If you have temporary vulnerabilities like recent hospital leavers or have a new-born baby

By registering with the service you can be provided with:

- A direct number to call in the event of a power cut so you can get straight through to the network
- A password scheme, so you feel safe
- Special help, if needed, through the British Red Cross, with warm meals and drinks in the event of a prolonged power cut
- Personal contact ahead of any planned interruptions to your electricity supply
- Keep you as informed as possible in the event of an unplanned power cut

To register for this service call Western Power Distribution on 08000963080 or visit www.westernpower.co.uk/PSR

Continued on page 14

R. Stone - Joinery

*All types of joinery work undertaken
Free Quotations*

Robert Stone
3, Ivy Lane, Elton, DE4 2BX
Mobile: 07971 815683

FIREWOOD FOR SALE

Seasoned hardwood logs cut & split

Builders bulk bag (1m³) £60; £5 deposit on bag
Free delivery in Elton and Gratton
Elsewhere £10 for one, £15 for 2 or 3 bags

Tel: Simon 650209 or 07889 107008
Email: simonfowler1@btinternet.com

Continued from page 13

Water supply

Although disruptions to our water supply are rare, for some it can be distressing and difficult. Severn Trent Water also have a Priority Services Register to help the vulnerable in the case of a water disruption. Again this is FREE to join and is aimed at the following groups:

- Those with medical conditions
- Those with mobility issues
- Those with a visual impairment
- Those with mental health problems
- Those who need temporary support

Once registered Severn Trent can act quickly to ensure that you have water in the event of an incident. They also have a dedicated 24 hour priority services number, the ability to nominate someone for them to contact on your behalf and provide priority updates during a water incident.

To register for their scheme and check availability visit <https://priority.stwater.co.uk> Alternatively call Severn Trent on their general enquiry number 03457500500 (you will need your account number) and they will send out an application form.

YOULGRAVE PANTOMIME 2018 – PUSS IN BOOTS

My recent visit to this year's 'Pommie Panto' was greatly enhanced by the inclusion of an entire Elton family in the cast. Ten years old twins Erin and Yasmin Allsop and their thirteen years old brother Jacob are by now pantomime veterans. This was their third consecutive appearance on the Youlgrave stage. However, this year they were joined by their mother Louise who, having previously worked backstage, stepped into the limelight for the first time with an extremely confident performance as the Good Fairy Priscilla.

Erin and Yasmin, who are still at Elton School, jointly played Millie (the Princess's maid) with some panache while the important role of Bobbie the Royal Page enabled Jacob to showcase his undoubted talents in what was a thoroughly enjoyable production.

Julie Stone

If you feel you could make a contribution to the Echo in the form of an article of interest to readers or an upcoming event or photos of a past event, please contact me by email at eltonecho@tiscali.co.uk .

Articles should be in .doc, .docx (not .pdf) or in .jpg format for pictures, approximately 750 words would be ideal and received by the copy date which is always the start of the month prior to quarterly publication. However, I can always save them for future issues if not time sensitive, so any time will do.

I am most grateful to our regular contributors; without them the Echo would be full of blank spaces.

The Editor

Across

1. Intangible (4)
3. Monumental (7)
9. Pointy hatter (5)
10. Take notice (7)
11. Yellowhammer (8)
12. Masterstroke (4)
15. Tough as old boots (5)
16. Adam's wine (5)
20. The hunted (4)
21. Destruction of one tenth (8)
23. Inherence (7)
25. Stigma (5)
26. Active contestant (7)
27. Nobbut (4)

Down

1. Twenty-four-seven (6)
2. Pay-back (9)
4. Thalassic (6)
5. Peeling enthusiasm (4)
6. Fresh up front (3)
7. Acted riddle (7)
8. Nobody's fool (5)
13. Procedural undertaking (9)
14. Pot-pourri (7)
17. Four in a dozen (5)
18. Strapped up (6)
19. Door man (6)
22. Teeny-bopper (4)
24. Willow-whacker from Hell (3)

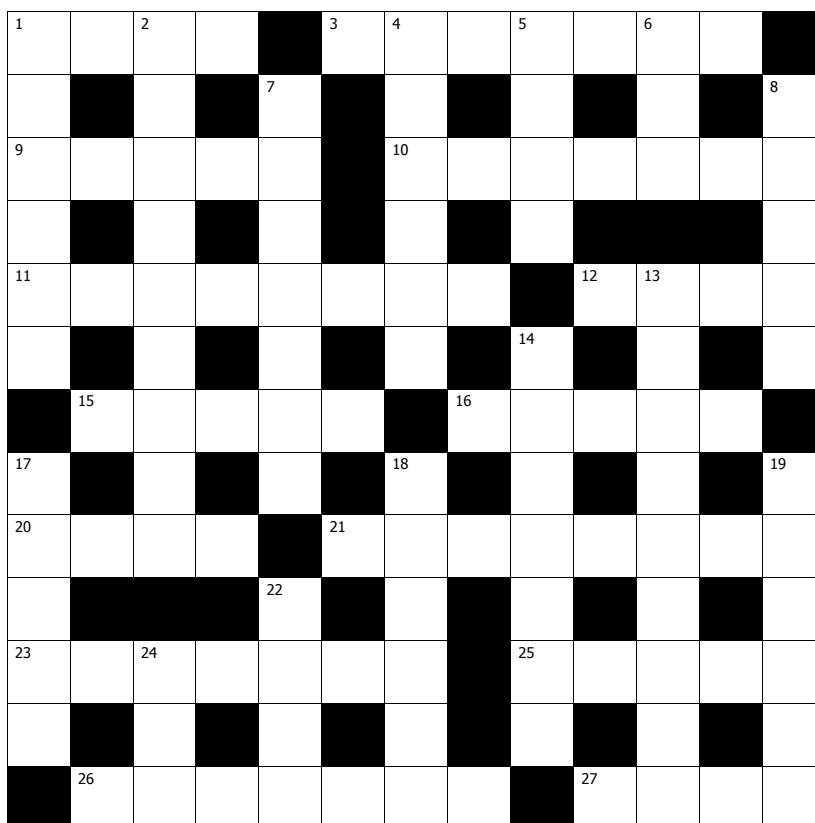
ROBIN'S KNOTTY CROSSWORD

Note: This crossword is published here with the kind permission of its compiler, Robin Hemmingway.

SOLUTION ON BACK PAGE

A J Kidd
Plumbing and Heating

Reliable, local professional service from a fully-qualified and experienced tradesman

Call Alex on
07873 583550 for a free, no obligation quotation

DJG Taxis

4 & 8 seater Taxi Service

Airports, Days/Nights out, etc.

Contact John Gladwin

Tel: 01629 650025 or
07767238331

Website: www.djg-taxis.co.uk

Email: john@djg-taxis.co.uk

The Small Ads

For Sale/Wanted

Non-business adverts in this section are free to village residents

Contact the editor if you wish to place an advert here

Resources

Community Transport

A Dial-a-Bus service for elderly &/or disabled people operates on the 1st and 3rd Thursday each month to Buxton arriving 11.15am & departing 1.15pm. To reserve a seat, contact 641920

Jubilee Field

The pitches & pavilion are available for hire. For all bookings, contact Colin Swindell on 07816 986956

Mobile Library

Once every 4 weeks on a Friday from 9th March
Duke of York - 10.10 - 10.40am
Call 01629 533190 for details.

Post Office

Outreach Service

Every Thursday in the School House
From 12.30 - 2.30pm

Village Hall

Hire of hall: **New Rates** £7.50 per session or £20 all day for residents & village organisations. Non-residents at reasonable rates.

For bookings or more information contact Sue Lightfoot 650641

Winster Surgery Hours

Mon – Fri 8.30am to 12noon
Mon & Wed only 2.00pm to 6.00pm

CROSSWORD SOLUTION

Clues Across: 1. Airy 3. Amazing 9. Witch 10. Respond 11. Yoldring 12. Coup 15. Hardy 16. Water 20. Frey 21. Declimate 23. Inbeing 25. Taint 26. Athlete 27. Only
Clues Down: 1. Always 2. Retaliates 4. Marine 5. Zest 6. Neo 7. Charade 8. Adept 13. Operation 14. Variety 17. April 18. Degat (Tagged) 19. Sentry 22. Gift 24. Bat

Village Directory

- **Badminton** Kate French 650273
- **Bell Ringers** Richard Freemantle 07871450149
- **Bus services** Timetable 0870 6082608
- **Community transport** 641920
- **County Council** 08456 058 058
- **Cricket Club** Glynn Yates 650494
- **Crime Stoppers** 0800 555 111
- **Darts Teams** Paul Carson 650359
- **District Council** 761100
- **Doctors** (Winster) 650207 Emergencies 733205 or NHS Direct 0845 4647
- **Electrical emergencies** 0800 6783 105 or New national 3 digit number 105
- **Energy Efficiency Grants** 761304
- **Fire advice** 582849
- **Gas leaks** 0800 111999
- **History Group** Lynn Burnet 650015
- **Hospital** The Whitworth, Darley Dale (minor injury only) 580211
- **Housing advice** 761311
- **Jubilee Field** Colin Swindell 07816 986956
- **Mobility Scooter** (Tissington Trail) for more details contact 01335 343156 - seasonal only
- **Pre-schools locally** - see page 8 for details
- **Police** For emergencies dial 999 otherwise dial the NEW number 101 (It's confidential)
- **Power Cut?** Call 105
- **Rail services** Enquiries 0845 7484950
- **Refuse collection** DDDC 761122
- **School** 650282
- **School PTFA** Natalie Cooper 650561
- **Swimming pool** Bakewell - 814205 Matlock - Arc Leisure - 581322
- **Taxi Service** - Kate or Neil 07816 201746
- **Tourist information** Bakewell - 813227 Matlock - 583388
- **Village Hall** Bookings Sue Lightfoot 650641
- **Water emergencies** 0800 7834444