

Summer Flowers

# The Elton Echo

A voice for everyone in Elton and Gratton

Summer 2018

www.eltonderbyshire.com

Issue No. 54

## ELTON BEER FESTIVAL

**Saturday 21st July 2018**

**2pm until 11.30pm**

### REAL ALES

Ciders, Prosecco and a well stocked bar

### LIVE MUSIC

Bouncy castle and henna artist during the afternoon

### BBQ & PORK COBS

Vegetarian options available

#### Admission

Adults - £5  
Under 18's - £2.50  
Under 12's - FREE

#### Village Discount

For Elton & Gratton  
residents with I.D.  
Admission - £2

#### Elton Jubilee Sports & Recreation Field

Registered Charity  
No. 507662

**Camping available at £1/ person**

## Diary Dates

### June

- 7 Parish Council meeting 7.30pm VH
- 8 Elton Quiz Night 7.30pm VH
- 19 ELHG guided walk around Winster 7pm  
Contact Lynn Burnet for details

### July

- 5 Parish Council meeting 7.30pm VH
- 13 Elton Quiz Night 7.30pm VH
- 15 Community BBQ 2pm on church croft  
ELHG lunch (time and date t.b.a.)
- 21 Elton Beer Festival on the Jubilee Field

### August

- No Parish Council meeting this month
- 10 Elton Quiz Night 7.30pm VH
- No ELHG meeting this month

### September

- Church Gift Day date t.b.a.
- 6 Parish Council meeting 7.30pm VH
- 14 Elton Quiz Night 7.30pm VH

### Weekly events

**Tea/Coffee & Toast in Church** - every  
Thursday morning 10.30am - 12.00pm  
Everyone is welcome

**Gentle Keep Fit** - every Tuesday from  
1.45pm to 2.45pm in the Village Hall - £3.00  
per session. See full details on page 5

### Fortnightly events

**Grey Bin & Food Caddy Collection**  
Every other Wednesday - from 6th June  
**Blue & Green Bin & Food Caddy Collection**  
Every other Wednesday - from 13th June

**Four-weekly Mobile Library** - see back page

### Editorial Policy

We welcome your news, views and articles of interest, provided they are not anonymous, libellous or offensive. Views expressed are not necessarily those of the editorial team. Items may be condensed where necessary.

News items, for sale/wanted adverts and announcements are free to Parish residents. For business advertising rates please contact John Wellington 650857.

If you would like to join the editorial team please contact one of us.

## Echo Editorial Team

John Moseley 650760  
John Wellington 650857  
Please send us your news, views, stories and diary events **(for September, October, November and December)** no later than:-

**Next Copy Date**  
**1st August 2018**

to: John Wellington  
Stride Cottage,  
Main Street, Elton.  
by email in .doc or .jpg (not .pdf) format  
to: eltonecho@tiscali.co.uk  
or handwritten

# Village News and Views

## Councillors Corner

### **Council Tax Increase**

At the District Council budget meeting in March, councillors unanimously voted to increase its share of council tax by 2.99%. This is the equivalent of an 11p increase per week on a band D property.

Nobody wants to see council tax go up and the decision wasn't taken lightly. With central government funding to local councils reducing year-on-year, councillors were left with little choice but to accept the increase. The additional money will enable the council to bridge the gap in its budget and maintain as many services as possible.

### **Changes to your supply of caddy liners and sack collections**

A reminder to all residents on sack collections, that the District Council is no longer supplying households with rolls of black sacks. Residents are now asked to present waste for collection in black sacks purchased from local retailers.

By now, all households should have received a roll of 52 food caddy liners. These continue to be provided free of charge. For those residents who have registered for a roll of 42 green compostable sacks for garden waste, these will be delivered at the same time as your caddy liners. If you have not registered for your compostable green sacks, you can do so on the District Council website.

If you have not received your supply of caddy liners or compostable sacks by the end of May, please contact Derbyshire Dales District Council on 01629 761100. **You must have notified the Council about your missing sacks by the 30 June 2018 otherwise you will be charged after this date.**

An additional roll of caddy liners and compostable sacks can be purchased at Town Hall, Matlock or any of the District Council leisure centres.

### **Residents parking permit**

Each household across the Derbyshire Dales should have received their new Residents Parking Permit with their latest council tax bill. I want to remind all residents to replace the old permit with the new one. The old permit is no longer valid. Any vehicle found parking with the old permit displayed will receive an on-the-spot fine.

### **Can I help you?**

I am always here to help in any way I can. If you need help, have an issue of concern or know of a problem that needs fixing, please contact me. My contact details are below. If I can't help you, I will always try to point you in the right direction.

Colin Swindell

**District Councillor**

**Winster and South Darley Ward**

Address: Laburnum Cottage, Well Street, Elton, Matlock DE4 2BY

Telephone : 07816 986 956

Email : [colin.swindell@derbyshiredales.gov.uk](mailto:colin.swindell@derbyshiredales.gov.uk)

#### **Parish Councillors**

John Moseley Chair	650760
Colin Swindell V.Ch	07816 986956
Cath Dawe	650649
Nigel Mason	650440
Janet Mallichan	650034
Maralyn Marsden	650589

All correspondence to the Clerk:  
Janice Jackson Tel: 650727  
8 Bradley Close  
Birchover  
DE4 2BG

#### **District Councillor**

Colin Swindell 07816 986956

#### **County Councillor**

Simon Spencer 01335 324324

#### **Member of Parliament**

Patrick McLoughlin,  
Derbys West Constituency Office  
01332 558125

## Village News and Views

### All Saints Church

Team Rector: Canon David Truby 824707

Church Wardens:  
Anne Wellington 650857

### Monthly Services

1st Sunday 9.30am Book of Common Prayer

2nd Sunday 6.00pm Sanctuary

3rd Sunday 9.30am Parish Eucharist

4th Sunday 6.00pm Evensong

5th Sunday See church noticeboard

### A word about hospitality.

At this time of the year, our part of the world is full of tourists. Many of them come from our surrounding cities, seeking something of the peace and quiet of the countryside which is a huge draw to them.

There is some concern about the countryside becoming simply a playground, and many of those who have to work there can sometimes be frustrated by the

numbers of people clogging up the roads in the summer.

There is something, however, about hospitality which is important at this time of the year. As people come and go through our villages they will be looking around and wondering who might live here. They will be thinking that they might wish to live here themselves and be envious of those who are lucky enough to live in Elton or any of the surrounding villages.

Like it or not the countryside is changing, and tourism is fast becoming the key factor in our local economy. There are things that we can do to welcome our visitors. It's interesting to see how many of them call in to the 'tea and toast' morning at church every Thursday, mingling with the regulars who are always ready to welcome them. Please remember that hospitality is something which is important to those who come to visit. The Bible is full of occasions when the stranger is welcomed into the midst of the community.

The presence of the stranger is a gift rather than the threat. How we make visitors to our community welcome is one of the key issues which we need to face living, as we do, in the countryside.

With best wishes

Canon David Truby

### Community BBQ

Our traditional BBQ in conjunction with the Parish Council will be held again in the afternoon of Sunday the 15th July.

As usual we will hold this on the croft in Well Street at the rear of the church.

**Everyone is welcome**

### Elton Church Gift Day

will take place early in September  
(date t.b.c but probably the 2nd or 8th).

There will be an Arts & Crafts exhibition, vintage motorcycles (hopefully), History Group display plus try your hand at bell ringing

Refreshments will be available

Everyone is welcome

# Village News and Views

## YOUR VILLAGE. YOUR COMMUNITY. YOUR SHOP.

Home deliveries start on 1<sup>st</sup> May, you can pick up an order form in the shop, request a copy to be emailed directly to you or phone your order in whichever is easiest for you.

As part of the launch Winster and Elton will be free delivery

- Delivery charge outside of Winster within a 5 mile radius is £5.00
- Minimum order value is £5.00 within Winster, £10.00 outside of Winster
- Cigarettes are excluded on delivery unless order over £10.00
- Must be over the age of 18 for alcohol and cigarettes

Don't forget you can also order your goods for collection. We are here to help, if you have any questions please call Jayne or Katrina or speak to a member of staff or volunteer.

Bottle milk has been a great success; we also now stock full and skimmed milk in bottles. If you would like to see any other items stocked in the shop which we do not currently stock please let us know.

- Fresh Bread & Milk
- Beers, Wine & Spirits
- Cooked Meats & Pies
- News Papers reserved or delivered
- Hot & Cold Drinks
- Post Office (Closed on Thurs/Sat Afternoons and Sunday)

### Shop Opening Times:

Mon – Sat	8.00am – 7.00pm
Sun & B/H	8.00am – 6.00pm

**From Jayne, Katrina, Staff and all the Volunteers**



Winter Village Shop  
[www.winstervillageshop.com](http://www.winstervillageshop.com)  
 Tel: 01629 650683

## Can you help restore pride in our Village?

Elton is a lovely place to live. But over recent months, people have been telling me that our village is looking a bit run down and could do with a tidy up. More importantly, people tell me they want to help restore some pride in where they live.

### Why have things got like this?

Sadly, both the District and County Councils are getting less and less money from the government to run services. So, they are reducing services in an effort to balance their budget. This means it is down to Parish Council's and communities to fill in the gaps.

### So what can we do?

The situation will only get worse before it gets better. So, it's down to local residents to help keep Elton tidy.

One solution would be to have working parties that do litter picks, grass mowing, etc. This was trialled a couple of years ago, but it took too much time to organise and not everybody was free when needed.

A new idea is for local residents to come forward to adopt-a-job or part of the village to look after/keep tidy. This could be mowing a grass verge, strimming a hedge, sweeping a pavement, painting noticeboards, wiping down a bus shelter, cleaning street signs, planting a trough, filling a grit bin or anything else you think needs doing.

### How much would I be expected to do?

What you want, when you want. It's up to you. Anybody who takes on a job can do it when it suits them - when you have the time or feel it needs doing. Some jobs might need doing every week, once a fortnight, once a year and others just as and when.

Nobody will be checking up or asking 'when will you do that?' or 'why aren't you doing this?'. It's down to you. And you can give it up if you feel you no longer can or want to do it. All jobs are voluntary and we will be relying on goodwill. Sadly, any expense cannot be reimbursed.

### So what jobs want doing?

Below is a list of jobs that you could take up to help keep our village tidy. Some people might want to think about adopting an area of the village instead of jobs. You might want to take up one of these or several. You might even want to suggest something of your own. You might just want to look after a small area outside your home.

Some people are already helping by doing odd bits around the village. If you already do a job or look after a part of the village, please let me know who you and what you do so we don't end up with somebody else doing it as well.

*Continued on next page*

### **ELTON KEEP FIT**

Tuesdays 1.45pm - 2.45pm

Elton Village Hall

£3.00 per session

- Stamina Improvement
- Body Toning
- Core Strengthening
- Balance Improvement
- Stretching & Relaxation

Exercises are adapted to suit a varied range of health & fitness levels and abilities, with chair based alternatives also given.

Come along and join our friendly group, making exercise fun and sociable.

For further details contact:

Helen Emmerson on 07957 369691 or email  
helen.emmerson@derbyshiredales.gov.uk



## Outreach Service, Elton

located at:

**The School House, Elton Primary School,  
Main Street, Elton**

**NEW** Opening time

**Every Thursday between 12:30pm and 2:30pm**

**Services include:**

**Postal services, stamps, pensions, benefits, council tax & bill payments,  
Plus car tax & cash withdrawals**

*(Some services may be subject to change)*

## Village News and Views

### What do I do if I want to help?

Please contact me using the details below. I'm happy to talk through what you would like to do, allocate you a job or an area to look after or tell you what jobs still need taking up.

If there is enough interest, a list of who is doing what will be kept so we know what is being done and what still needs doing.

### Will this work?

That's down to you. This is an ambitious idea and I hope enough people will come forward to contribute. If it doesn't work, at least we can say we tried. The more people that contribute a little, the better our village will be for everybody.

### A note of understanding

Finally, I appreciate that some people may begrudge this idea on the grounds of having already paid Council Tax for these services. I couldn't agree more and understand if people decline to take part on these grounds.

I too wish that this wasn't something we had to suggest and do. Sadly, this is how things are and services will only continue to reduce. As your district councillor I will continue to argue against any reduction in services, but for now I hope we can work together to restore some pride in our village.

Thanks for reading.

Colin Swindell  
**District Councillor**

Address: Laburnum Cottage, Well Street, Elton, Matlock DE4 2BY  
Mobile: 07816 986 956  
Email: [colinswindell@hotmail.co.uk](mailto:colinswindell@hotmail.co.uk)

### List of Jobs that need doing in Elton...

- Cutting, strimming or mowing grass verges
- Weeding along pavements (wherever you feel you can do)
- Sweeping out/cleaning a bus shelter
- Painting a bench
- Painting a noticeboard
- Planting a trough
- Wiping down street signs and 'street furniture'
- Filling a grit bin from village salt supply (winter only)
- Litter picking

Anything you can see wants doing that you would like to do! Let me know.

**Want to see family and friends  
without the hassle?**

**Homestead Farm  
B&B and Self-catering Cottage**

Book them in with Jean or Alan Carson

**Tel. 650359**

### **The Secret @ Peak Serenity**

A Christian retreat for 2 people situated in a tranquil, rural setting, 'Off the beaten track', on Harthill Moor, near Chatsworth and Bakewell. Family owned and run.

Idyllic location perfect for walkers, lovers of wildlife, photographers, artists, etc.

For details and bookings, phone/text me on 07837 725337

Email: [relax@peakserenity.co.uk](mailto:relax@peakserenity.co.uk)

Web: [www.thesecond-peakserenity.co.uk](http://www.thesecond-peakserenity.co.uk)

Thank you...

Christine Earl, Cliff Farm, nr. Elton, DE45 1LL

## Votes for Women - The Elton Connection

Who would have thought there could be a connection between a small village in the hills of Derbyshire and the passing of an Act of Parliament one hundred years ago that granted voting rights to women over the age of 30? That connection is a curate's daughter, born in the house where I am writing this.

In 1838 Elton's new curate moved into his newly-built Parsonage House in Well Street. Two years previously John Fisher Garrett married Elizabeth Pidcock, one of the daughters of the vicar of Youlgreave and they lived in Dudwood Lane while awaiting completion of their new home, a two-up, two-down cottage built on the site of a former farmhouse. Son Samuel was the first child to be born in the Parsonage House, in February 1838. As the Garrett family grew, their home would be enlarged twice, first about 1850 and again in 1871.

John Fisher Garrett came from Suffolk and was related to Elizabeth Garrett Anderson (1836-1917), the first woman to qualify as a physician and surgeon in England and the first female mayor in England, and Millicent Garrett Fawcett (1847-1929), a leading suffragist and co-founder of Newnham College, Cambridge. John Fisher Garrett (J.F.G.) was in regular contact with his Suffolk family and many of the relatives probably came for the marriage of J.F.G.'s cousin's daughter, Elizabeth Garrett, in Elton church in 1843. Her 6-year-old son was staying here at the Parsonage House on census night 1851 with J.F.G.'s children Rhoda (aged 10) and Frank (aged 7). Samuel was already at boarding school. As a girl, there was no question of Rhoda getting a public school education; she received her education at home from a governess. This girl, *The Remarkable Rhoda Garrett*, is the subject of a recently published, thoroughly researched biography with that title, written by Graeme Taylor.\*

Rhoda was the second child to be born at the Parsonage House, on 28th March 1841. She was only 12 when her mother died, and seven years later, in 1860, her father married again. His new young wife was Mary Gray from Grantham, just nine years older than Rhoda. The couple soon started a family and it appeared to Rhoda's Suffolk cousins that her future would be little more than her half-siblings' nursemaid. As a poorly paid curate J.F.G. could give little financial help to his eldest daughter. His income increased a little when his status was raised to Rector in 1866 after which the Parsonage House became known as the Rectory.

The Suffolk branch of the Garretts could see potential in Rhoda and soon after the first of five new babies arrived in the parsonage, the eldest sister, Louie, arranged for Rhoda to leave Elton for London to continue her education, at Louie's expense. Rhoda spent some time as a pupil teacher at a school in London where the two youngest sisters, Millicent and Agnes were pupils.

Even as a teenager Millicent Garrett was actively involved in the campaign for women's rights. At the age of 19 she married politician Henry Fawcett and Rhoda was a bridesmaid. Millicent Garrett Fawcett became one of the most influential suffragists and in April this year her statue was unveiled in Parliament Square, London, the first woman to be so honoured. A modest memorial to her cousin, supporter and co-activist, Rhoda Garrett, can be seen in Elton church.

In 1871 Rhoda began touring the country making speeches in crowded halls in support of women's suffrage and campaigning for better educational opportunities for girls. She became so well known and respected as a speaker that when John Fisher Garrett died in 1878 the author of his obituary described him as, 'father of Miss Garrett, of lecturing celebrity'.

## Village News and Views

**Peak Pre School** has a cosy and Stimulating environment with a capacity for ten children helping them feel safe and secure whilst they learn through play. We offer a wide range of activities and promote outdoor learning in our wonderful garden and allotment.

Ofsted rated GOOD in December 2015.

15 and 30 hours funded places available for 2,3 and 4 year olds.

Other funding options available.

£4 per hour for non-funded places.

3 hour sessions of 8.45am-11.45am or 11.45am- 2.45pm

Or

6 hour full days from 8.45am- 2.45pm Monday to Thursday.

To arrange a visit contact Sarah on 07799084244 or email [peakpreschool@outlook.com](mailto:peakpreschool@outlook.com)

Attached to Stanton in the Peak Primary School,

School Lane, Stanton in the Peak,

Derbyshire, DE4 2LX

## South Darley & Winster Pre-School

At

The Burton Institute, West Bank, Winster

A small friendly, family like atmosphere for children aged 2-4 years to learn, play and grow together.

Funded places available for all 3 year olds and eligible 2 year olds.

**Open Term time.**

**Monday - Thursday 9am-12pm, 12pm -3pm.**

**Morning, afternoon or full day sessions available.**

Please contact Kirsty on 07863771636 or 01629650867  
or email [info@southdarleypreschool.co.uk](mailto:info@southdarleypreschool.co.uk) for information.

Have a look at our website [www.southdarleypreschool.co.uk](http://www.southdarleypreschool.co.uk)



Continued from page 7

Contemporary reports on several of Rhoda's speeches can be found in Graeme Taylor's book. In her audience at Manchester's Free Trade Hall in 1874 was 15-year-old Emmeline Goulden, attending her first public gathering in support of women's suffrage. Emmeline was to become Mrs Pankhurst. Unlike Mrs Pankhurst's militant suffragettes Rhoda and her cousins were suffragists, who campaigned by lawful means.

Rhoda's four surviving half-siblings were left orphaned in Elton Rectory on J.F.G.'s death. Despite her busy life, Rhoda was close to the children, then aged between 7 and 14, and took them all to London to live in the house in Gower Street that she shared with Agnes Garrett. The children's mother had died in 1872 and the beautiful window on the south side of our church, near the altar, is the memorial to her. The children were much influenced by Rhoda and her cousins and also became ardent supporters of the women's movement. One of them, Amy, together with her husband, established the first non-denominational co-educational boarding school in England, Bedales.

Rhoda and Agnes Garrett shared an artistic temperament and wanted to pursue careers in architecture but it was not usual for women to get apprenticeships. After much prejudice against their sex they eventually did succeed, specialised in interior decoration and design and set up in business in Gower Street together in 1874. They were amongst the first women in England to start a business on their own account and they were able to provide a few apprenticeships, for women. They wrote and illustrated an influential book, *Suggestions for House Decoration in Painting, Woodwork and Furniture*, published in 1876.

Through her work as an interior designer and decorator Rhoda became friendly with the composer Sir Hubert Parry, perhaps best known for the hymn tune 'Jerusalem'. Parry wrote a piece dedicated to the memory of Rhoda, which was performed at the Gloucester Festival in 1883, the year following her death. Henry Fawcett died in office as Postmaster-General in 1884 and Parry's music was published the following year with the dedication, "To the Memory of Rhoda Garrett and Henry Fawcett". Rhoda died of typhoid fever in London and lies in an unmarked grave in the West Sussex village of Rustington where she and Agnes spent their holidays together. Rhoda is remembered in the village where she spent the first half of her life, on the window showing Ezekiel and St Paul in the north wall of Elton church (the only pointed window on that side). At the bottom it is just possible to make out the names of Rhoda and her parents.

Graeme Taylor paints a picture of a woman with determination, dedication, talent, perseverance in the face of opposition, courage and compassion, all combined with a charming personality, a truly remarkable woman. Had she lived beyond the age of 41 this daughter of Elton might have become almost as well known as Elizabeth Garrett Anderson and Millicent Garrett Fawcett. It's appropriate that Graeme Taylor has brought Rhoda out of obscurity for this 100th anniversary year of the extension of the franchise to women.

Lynn Burnet

\* *The Remarkable Rhoda Garrett (Women's Suffrage)* by Graeme Taylor, Writersworld, 2017, 195 pages, ISBN 978-0-9933555-3-0. Available to order from bookshops and through Amazon. £9.99 paperback, £12.99 hardback and £5.99 for the Kindle version.

There is a booklet available in Elton church, *Rectors Remembered*, containing a short account of John Fisher Garrett, his two wives and nine children, price £2.50.

## THE ELTON "100 CLUB"

**We have a number of unused numbers available to purchase at a cost of £1 per month (£12 for the year). A monthly draw takes place with the top prize being £25. All remaining proceeds go towards the maintenance of the Jubilee Field.**

**We are looking for new members who would like to join or existing members who wish to purchase more numbers.**

**Just contact Cath Dawe on 01629 650649 or Carolyn Wilson on 01629 650757 to choose your numbers.**

**We are also looking for a volunteer to make collections in the east end of the village. It's not a monthly task, it can be done to suit yourself. Please contact one of the above to discuss.**

**Thank you.**

### Peak Advertiser Delivery

I am looking to finish distributing the Peak Advertiser before next winter. Anyone who may be interested in taking this on is welcome to contact me for further details and/or Peak Advertiser.

Carolyn Wilson - 01629 650757

### GARDENING SERVICE

- Garden Maintenance:- weeding borders, grass cutting, shrub pruning, planting, hanging baskets
- RHS qualified
- Small gardens only

Rate £15 per hour

- Planting Design - fixed fee on application.

Contact :- Mandy Tel. 07864 077209

Email :- mandyg3@sky.com

## ELTON SCHOOL – TALES FROM THE CLASSROOM AND THE PLAYGROUND

I started at Elton School in 1957. It was a time of fundamental change. In 1957 children were still staying at Elton up to the age of 14 and the school was divided into three classes. By the time I left in 1963, the completion of a brand new secondary modern school on 'The Parkway' in Darley Dale meant that children were leaving Elton School at 11 and that there were now just two classes – as there are today. Sadly - barely two decades after its completion the still pristine Parkway School was deemed surplus to requirements (following the construction of Highfields School in Matlock) and it was subsequently demolished. The former school site is now a housing estate.

Prior to the advent of the school at 'The Parkway', the three class structure at Elton had been achieved by drawing a retractable screen across the middle of the main room (there was no office then). The long serving headmaster, Norbury ('Nobby') Buxton taught the 'top' class. His wife Elizabeth was in charge of the 'middle' class and Mrs Wright, my first teacher, taught the infants. Mr & Mrs Buxton, who lived at Lea Hay at the East End of Elton, retired a short time after I started school so I remember very little of them. My sister is a little older than me. She recalls that Mrs Buxton suffered greatly with her legs and taught mostly from a sedentary position with her legs supported on a stool. Some thirty years earlier Mr Buxton had taught my father up until he left school at the age of 14 and I know that Dad held him in the very highest regard. They subsequently became friends and I particularly remember my father visiting his old teacher frequently, both at home and in hospital, during Mr Buxton's final illness.

As a consequence of his very long period of service in charge of Elton School, stories about Nobby Buxton are many and varied. I can't resist mentioning one which my father was fond of recounting. It concerned two of Dad's rather mischievous classmates – Bob Haywood and Roy Bibby. At that time, pupils sat at individual desks arranged in rows. Mr Buxton was assisting the pupil sitting immediately in front of Bob and was leaning over in such a way that his rear end was just a few inches from the front of Bob's desk. Seeking to amuse his classmates, Bob took out his compass and held its point a couple of inches from the headmaster's bottom. Sitting one desk behind Bob, Roy decided to add to the fun by pretending to push Bob's hand - and the compass point it was holding - still closer towards its 'target'.....but something went horribly wrong. The most likely explanation is that Roy missed his footing and lurched forward but, whatever the cause, the effect was that he stumbled onto Bob's arm and, as a result, the compass point made disastrously firm contact with Nobby's behind.

Apparently, all hell then let loose. The furious headmaster span round to see Bob's hand still holding the 'weapon'. Bob immediately implicated Roy and the two of them were dragged to the front of the class to await their fate. There they stood trembling for several minutes while Nobby withdrew to inspect his wounds. I am unsure whether this



**Paws First Pet Care**  
Professional Pet Services

- **1-2-1 Dog walking**
- **Home boarding for dogs**
- **Home visits for small animals**
- **Fully insurer & licenced**

**Email: [pawsfirstpetcare@hotmail.com](mailto:pawsfirstpetcare@hotmail.com)**  
**[www.pawsfirstpetcare.co.uk](http://www.pawsfirstpetcare.co.uk)**  
**Tel: 01629 650693 / 07885 709074**

## JPB SERVICES

Property Maintenance, Decorating & Gardening

4 East End  
Elton  
Matlock  
Derbyshire

Home: 01629 650 593  
Mobile: 07966526946

[jpb-services@hotmail.co.uk](mailto:jpb-services@hotmail.co.uk)



**Frances Burton**  
BSc(Hons) MNIMH  
Medical Herbalist



## Herbal Medicine Consultations

Consultation: £40, follow-ups £20 plus herbal medicine @ £7/week

Elton residents: 25% discount on consultations, home visits available

Practice based in Ashbourne and Wirksworth

Tel: 07791326212

francesburton.burton@gmail.com

Facebook: Frances Burton the Herbalist Derbyshire Dales

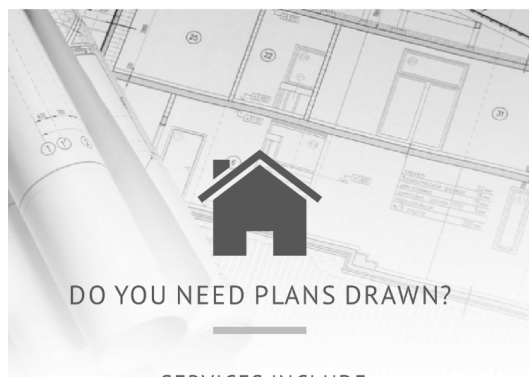

## SERVICES INCLUDE

- Site Consultation & Design Advice
- Drawings for: Conversions, Extensions, refurbishments etc.
- Sketch to CAD Drawings
- Planning Advice and Application Submission
- Building Regulations Advice & Submission
- Planning Appeals

Please call: 01629 700487

For a free site consultation.

enquiries@apestates-design.co.uk

www.apestates-design.co.uk

## Calling all holiday accommodation providers in Elton and Gratton

If you would like copies of the Elton Village Guide leaflet and the Elton Village Trail booklet for your clients please contact [eltonhistory@talk21.com](mailto:eltonhistory@talk21.com) or phone Lynn on 650015.

### The Sanctuary

Cliff Farm, Cliff Lane, between Elton and Alport. DE45 1LL

Here at Cliff Farm, a Christian place of peace has been created for use by anyone in need of relief from the worries of everyday life, or relaxation.

Come for a coffee and experience the stillness and the quietness.

Small community groups, church groups (for away days), small businesses with little funds looking for a place to meet are welcome (great for workshops, seminars, fundraising, etc.)

Phone or text me Christine Mob. 07837 725337

Email 1: [thesanctuary@peakserenity.co.uk](mailto:thesanctuary@peakserenity.co.uk)

2: [relax@peakserenity.co.uk](mailto:relax@peakserenity.co.uk)

Christine Earl

07816 201746 / 07541 541708

# Neils Taxi

Personal logistics

Reliable Private hire / Hackney carriage  
Airports - Business / Holidays



Comfortable & spacious 6 seated Galaxy's

[www.neils-taxi.co.uk](http://www.neils-taxi.co.uk)

[neilstaxi@btinternet.com](mailto:neilstaxi@btinternet.com)

*Continued from page 11*

involved the use of a mirror or Mrs Buxton's assistance. At that time corporal punishment in school was rife. Suffice to say that Bob and Roy received their fair share that afternoon.

Incidentally - thirty years or so later by the time I was at Elton School - corporal punishment was still around. By then Harold Lomas had succeeded Nobby Buxton as headmaster. The old lead mining workings (long since demolished) situated between the rear school yard and Joules Croft were strictly out of bounds - even after school. However, boys will be boys and a small group of us were practising our climbing skills there one evening when one of our number (who still resides in the village) fell and broke his arm. At school next morning five of us confessed to being with him at the time and we were each 'sentenced' by Mr Lomas to a single stroke of his cane to the hand. Did it hurt? Briefly - yes. Did I feel abused? Not really. Did it make any difference? Probably no. Did we play there again? Almost certainly.

A significant difference between Elton School in my time and the school now were the school dinner arrangements. At noon each day we would assemble in two's and walk to the Old Joiners Shop on West End, the upper floor of which was the school canteen. This being Elton, there would certainly have been many cold, windy, wet days but - the memory can play funny tricks - I only remember walking on to the canteen on lovely sunny days!

May Ball sounds like a rather grand school event. In fact she was the school dinner lady who lived in Back Lane. Meanwhile Mrs Anders, who lived in the Old Red Lion Yard off Main Street, was the school cleaner. In my final year at Elton I was entrusted with the important task of delivering their wage packets to Miss Ball and Mrs Anders every Friday morning. This was straightforward in relation to Miss Ball but at Mrs Anders house I was always ushered inside to sit and wait while she checked the contents of her wage packet. I am not sure whether Mrs Anders imagined that I had made up the wages myself or whether perhaps she suspected me of rifling her cash on the short walk down from school. Fortunately, the monetary contents always balanced to the accompanying wage slip and I was duly rewarded with a threepenny bit. If there was not such a thing amongst the coins in the wage packet, Mrs Anders would hand me one from the substantial pile of threepenny bits she seemed to accumulate on her very crowded mantelpiece. At this late stage, I can only hope that I was as grateful at the time as I should have been but - at ten years old - who knows?

Digressing for a moment - my association with Mrs Anders was to take a turn for the worse some years later when as a young teenager I was somehow persuaded to try my hand at the monthly Whist Drives run by the WI and held in the school. The first couple of occasions passed without incident but on the next, as we moved from table to table between games, I found myself in opposition to Mrs Anders. I had no idea that a lady, so seemingly pleasant in normal day-to-day matters, could transform into someone so aggressive over the small matter of a game of cards. Without getting into too much detail I made an innocent mistake by playing a trump card when I was not entitled to do so. The technical term for this is 'revoked'. By the end of the game Mrs Anders had somehow identified the error - seemingly having a photographic memory of every card played and by whom. She dressed me down in no uncertain terms before clambering to her feet and shouting 'He's revoked!' across the room to the MC at the top of her voice - jabbing her

*Continued on page 14*

## R. Stone - Joinery

*All types of joinery work undertaken  
Free Quotations*

**Robert Stone**  
3, Ivy Lane, Elton, DE4 2BX  
**Mobile: 07971 815683**

## FIREWOOD FOR SALE

Seasoned hardwood logs cut & split

Builders bulk bag (1m<sup>3</sup>) £60; £5 deposit on bag  
Free delivery in Elton and Gratton  
Elsewhere £10 for one, £15 for 2 or 3 bags

**Tel: Simon 650209 or 07889 107008**  
**Email: [simonfowler1@btinternet.com](mailto:simonfowler1@btinternet.com)**

*Continued from page 13*

finger aggressively in my direction. I was too confused (and still am) to understand what went on next to resolve matters but that particular occasion was certainly my very last Whist Drive.

Back now to my time at Elton School - balls were constantly disappearing over the wall when we were playing football or cricket in the front school yard. Health & Safety was a little more relaxed in those days, the only rule being that we should stay on the pavement as we leapfrogged the wall to chase balls down the road. The elderly Henry Carson had been a notable cricketer in his day and he would often stand observing the game he so loved being very loosely attempted in the school yard. Occasionally he would come through the gate and try to demonstrate the finer points of the forward defensive shot but we carried on regardless and eventually - he gave up!

JOHN STONE

## ELTON SCHOOL PANTOMIME (ALADDIN) - CHRISTMAS 1962



Pictured (from left to right) are John Stone, Stephanie Roose, Isobel Haywood, Jean Glossop, Sheila Allen, Rita Webster, Joanne Eley, Stephen Elliott, Alan Buxton

**If you feel you could make a contribution to the Echo in the form of an article of interest to readers or an upcoming event or photos of a past event, please contact me by email at [eltonecho@tiscali.co.uk](mailto:eltonecho@tiscali.co.uk) .**

**Articles should be in .doc, .docx (not .pdf) or in .jpg format for pictures, approximately 750 words would be ideal and received by the copy date which is always the start of the month prior to quarterly publication. However, I can always save them for future issues if not time sensitive, so any time will do.**

**I am most grateful to our regular contributors; without them the Echo would be full of blank spaces.**

*The Editor*

## Across

1. Not as planned (4)
3. Cut off (7)
9. Quietly intelligible (5)
10. One with minority religion (7)
11. State of stupor (8)
12. Go no further (4)
15. Cowardly (5)
16. Cold and cunning (5)
20. Wild cat (4)
21. Merry-go-round (8)
23. Light mauvish-crimson (7)
25. Copy (5)
26. Inflamm (7)
27. Capture in retreat (4)

## Down

1. Be there (6)
2. A going back (9)
4. Incorporeal drink (6)
5. Port (4)
6. Not much (3)
7. Obstreperous (7)
8. Lovers go quietly (5)
13. Weigh up (4,5)
14. Connected (2,5)
17. Gain height (5)
18. Gem count (6)
19. Customer (6)
22. Single moment (4)
24. Connections with 4 down (3)

## ROBIN'S KNOTTY CROSSWORD

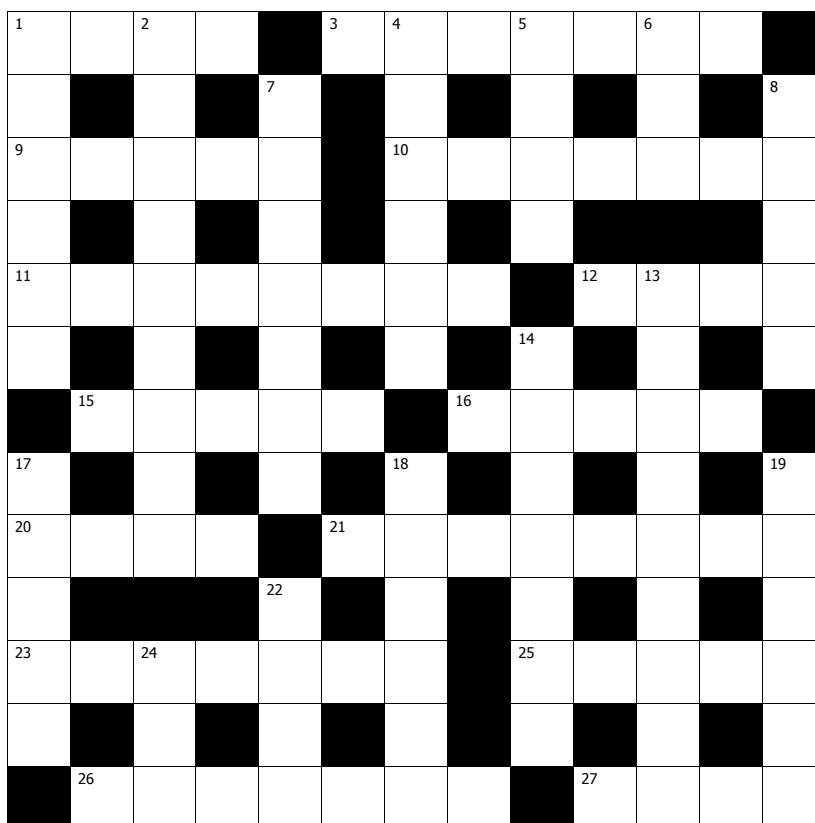

**Note:** This crossword is published here with the kind permission of its compiler, Robin Hemmingway.

**SOLUTION ON BACK PAGE**



**A J Kidd**  
Plumbing and Heating

Reliable, local professional service from a fully-qualified and experienced tradesman

Call Alex on  
07873 583550 for a free, no obligation quotation

**DJG Taxis**

**4 & 8 seater Taxi Service**

Airports, Days/Nights out, etc.

Contact John Gladwin

Tel: 01629 650025 or  
07767238331

Website: [www.djg-taxis.co.uk](http://www.djg-taxis.co.uk)

Email: [john@djg-taxis.co.uk](mailto:john@djg-taxis.co.uk)

## The Small Ads

### For Sale/Wanted

**Non-business adverts in this section are free to village residents**

**Contact the editor if you wish to place an advert here**

### Resources

#### Community Transport

A Dial-a-Bus service for elderly &/or disabled people operates on the 1st and 3rd Thursday each month to Buxton arriving 11.15am & departing 1.15pm. To reserve a seat, contact 641920

#### Jubilee Field

The pitches & pavilion are available for hire. For all bookings, contact Colin Swindell on 07816 986956

#### Mobile Library

Once every 4 weeks on a Friday from 1st June  
Duke of York - 10.10 - 10.40am  
Call 01629 533190 for details.

#### Post Office

#### Outreach Service

Every Thursday in the School House  
From 12.30 - 2.30pm

#### Village Hall

Hire of hall: **New Rates** £7.50 per session or £20 all day for residents & village organisations. Non-residents at reasonable rates.

For bookings or more information contact Sue Lightfoot 650641

#### Winster Surgery Hours

Mon – Fri 8.30am to 12noon  
Mon & Wed only 2.00pm to 6.00pm

### CROSSWORD SOLUTION

Clues Across: 1. Awry 3. Isolate 9. Tacit 10. Infidel 11. Narcosis 12. Stop 15. Wimpy 16. Snaky 20. Lynx 21. Carousel 23. Magenta 25. Clone 26. Incense 27. Ekot (Take)  
Clues Down: 1. Attend 2. Recursion 4. Spirit 5. Left 6. Tad 7. Strop 8. Elope 13. Take stock 14. In touch 17. Climb 18. Carats 19. Client 22. Once 24. Gin

## Village Directory

- **Badminton** Kate French 650273
- **Bell Ringers** Richard Freemantle 07871450149
- **Bus services** Timetable 0870 6082608
- **Community transport** 641920
- **County Council** 08456 058 058
- **Cricket Club** Glynn Yates 650494
- **Crime Stoppers** 0800 555 111
- **Darts Teams** Paul Carson 650359
- **District Council** 761100
- **Doctors** (Winster) 650207 Emergencies 733205 or NHS Direct 0845 4647
- **Electrical emergencies** 0800 6783 105 or New national 3 digit number 105
- **Energy Efficiency Grants** 761304
- **Fire advice** 582849
- **Gas leaks** 0800 111999
- **History Group** Lynn Burnet 650015
- **Hospital** The Whitworth, Darley Dale (minor injury only) 580211
- **Housing advice** 761311
- **Jubilee Field** Colin Swindell 07816 986956
- **Mobility Scooter** (Tissington Trail) for more details contact 01335 343156 - seasonal only
- **Pre-schools locally** - see page 8 for details
- **Police** For emergencies dial 999 otherwise dial the NEW number 101 (It's confidential)
- **Power Cut?** Call 105
- **Rail services** Enquiries 0845 7484950
- **Refuse collection** DDDC 761122
- **School** 650282
- **School PTFA** Natalie Cooper 650561
- **Swimming pool** Bakewell - 814205 Matlock - Arc Leisure - 581322
- **Taxi Service** - Kate or Neil 07816 201746
- **Tourist information** Bakewell - 813227 Matlock - 583388
- **Village Hall** Bookings Sue Lightfoot 650641
- **Water emergencies** 0800 7834444