

Summerblooms

The Elton Echo

A voice for everyone in Elton and Gratton

Summer 2019

www.eltonderbyshire.com

Issue No. 58

Elton's 15th Beer Festival

Saturday 20th July

From 2pm - 11.30 pm

on the Jubilee Field

Real Ales, Ciders, Wines & Prosecco

Burgers, Sausages, Pies etc.

Entertainment with 5 live bands

**Entry costs £5
(under 18's £2, under 12's free)**

Camping available

Editorial Policy

We welcome your news, views and articles of interest, provided they are not anonymous, libellous or offensive. Views expressed are not necessarily those of the editorial team. Items may be condensed where necessary.

News items, for sale/wanted adverts and announcements are free to Parish residents. For business advertising rates please contact John Wellington 650857.

If you would like to join the editorial team please contact one of us.

Echo Editorial Team

John Moseley 650760
John Wellington 650857
Please send us your news, views, stories and diary events **(for September, October, November and December)** no later than:-

Next Copy Date
1st August 2019

to: John Wellington
Stride Cottage,
Main Street, Elton.
by email in .doc or .jpg (not .pdf) format
to: eltonecho@tiscali.co.uk
or handwritten

Diary Dates

June

6 Parish Council meeting 7.30pm VH
14 Elton Quiz Night 7.30pm

July

4 Parish Council meeting 7.30pm VH
12 Elton Quiz Night 7.30pm
20 Elton Beer Festival 2pm - 11.30 pm JF

August

4 Community BBQ on the Church Croft from 3pm onwards
9 Elton Quiz Night 7.30pm

September

5 Parish Council meeting 7.30pm VH
13 Elton Quiz Night 7.30pm

Weekly events

Tea/Coffee & Toast in Church - every Thursday morning 10.30am - 12.00pm
Everyone is welcome

Gentle Keep Fit - every Tuesday from 1.45pm to 2.45pm in the Village Hall - £4.00 per session. See full details on page 5

Fortnightly events

Grey Bin & Food Caddy Collection
Every other Wednesday - from 5th June
Blue & Green Bin & Food Caddy Collection
Every other Wednesday - from 12th June

Four-weekly Mobile Library - see back page

Councillors Corner

Tribute to Cath Dawe

In May, the Parish Council lost one of its longest serving members. Cath Dawe sadly passed away after being unwell for several weeks. Cath served on Elton Parish Council for over 15 years and represented Elton All Saints Church.

Cath loved Elton and everybody in the community. She was a friend to anyone she met, cared greatly about people and would always go that extra mile to help anyone. Even after facing great challenges and sadness herself in recent months, having suffered a stroke and enduring the loss of her husband John, Cath never complained. She remained her happy and positive self and was soon back to thinking of others and doing her bit for the community.

She was a calm and collected member of the Parish Council with a great sense of humour, but never afraid to speak her mind or voice her opinion when the time arose. And she always made Christmas in Elton extra special with her famous mulled wine brew.

Cath, will be very hard to replace – both on the Parish Council and in the community. We will miss her greatly and with much sadness, but remember her with fondness and affection.

Clarification on Garden Waste Charges

A number of people have recently contacted me wanting to know when charges for the collection of garden waste will come into effect and how much it will be. The charges and effective date have not yet been agreed. At this stage these are only proposals which have been set out in the new waste contract which will begin in August 2020 when the current contract with Serco will come to an end.. If charges are brought in for garden waste, they might not even start until 2021.

The new contract is currently being reviewed by potential contractors and hasn't yet gone through a formal tendering process. This could still change in the months ahead and I will continue to keep you updated as things begins to take shape. For now, garden waste collections remain free of charge for at least another year.

Food caddy Liners

Free food caddy liners are currently being delivered to households across Derbyshire Dales. Residents who have subscribed to the District Council's compostable sack scheme for garden waste will also receive a free roll of 42 compostable sacks. Properties that currently use black sacks for household waste can subscribe to the compostable sack scheme for garden waste online. Any

Continued on page 7

Parish Councillors

John Moseley Chair 650760
Colin Swindell V.Ch 07816 986956
Nigel Mason 650440
Maralyn Marsden 650589

All correspondence to the Clerk:
Janice Jackson Tel: 650727
8 Bradley Close
Birchover
DE4 2BG

District Councillor

Colin Swindell 07816 986956

County Councillor

Simon Spencer 01335 324324

Member of Parliament

Patrick McLoughlin,
Derbys West Constituency Office
01332 558125

Village News and Views

YOUR VILLAGE. YOUR COMMUNITY. YOUR SHOP.

Summer is on its way, it's time to get out and enjoy those summer evenings. We are now stocking a variety of local Ales from Aldwark, Peak Ales, Dancing Duck, Birchover Brewery and Matlock Wolds Farm. Why not treat yourself. What more could you want than a cold beer and a BBQ, we sell disposable BBQ's and Charcoal along with burgers and sausages from Coates and Ginger Butchers.

If you would like us to order any meat or burger buns just pop in or call us to place your order.

Remember **Father's Day on Sunday 16th June**, you can buy a box of 3 local ales which you can choose from any of the above suppliers. We will also be stocking other father's day gifts.A

Secret Gardens, Wakes week and Carnival is just around the corner. For all you stall holders let us take the strain, we can order you any goods for your stalls for example wines, beer, pop, burger buns, meat. Just let Jayne or Katrina know what you require and we can order them and store them until the day. (Limited storage space).

- Fresh Bread & Milk
- Beers, Wine & Spirits
- Cooked Meats & Pies
- News Papers reserved or delivered
- Hot & Cold Drinks
- Post Office (Closed on Thurs/Sat Afternoons and Sunday)

Look out for more special offers in June!!

Shop Opening Times:

Mon – Sat	8.00am – 7.00pm
Sun & B/H	8.00am – 6.00pm

From Jayne, Katrina, Staff and all the Volunteers



Winter Village Shop
www.winstervillageshop.com
 Tel: 01629 650683

Village News and Views

All Saints Church

Team Rector: Canon David Truby 824707
Church Warden:

Monthly Services

2nd Sunday 9.30am Parish Eucharist
4th Sunday 6.00pm Evensong

Everything Changes

The Annual Meeting of the Parochial Church Council took place early in April and were unable to appoint a churchwarden for the next year. We are grateful to Mrs Anne Wellington for the hard work that she has put in in these last years. As the only warden, she had the responsibility all on her shoulders, and it is only right that she should step down after having shared her part of the burden associated with the care and maintenance of the church.

We are particularly grateful for the way in which she was always

ready to offer a warm welcome, especially to visitors. It was gratifying to receive an email from a young mum who recently visited with her family for a service. She wanted to share how delighted she was with the welcome that she and her family received.

For the moment, then, All Saints is without a churchwarden based in the village. Any legal responsibilities will be undertaken by the churchwardens in the rest of the Team Ministry. They will only ratify any decisions made by the Church Council at All Saints.

One of the decisions made at the Annual Meeting was the need to move from a pattern of weekly worship to one where there will be just two Sundays of the month when services will take place. From June there will be a morning Eucharist at 9.30am on the second Sunday of the month, and a service of evensong on the fourth Sunday at 6pm. Other services such as weddings, baptisms and funerals will still take place by arrangement, though any enquiries should be made, in the first instance, to the Team Office on 01629 824707. Festivals such as Christmas and Easter will, of course, still be celebrated in addition to the Sunday services.

Now that the work on providing a toilet in church is complete, we will be holding an informal thanksgiving service on the afternoon of Sunday 19th May at 3pm, followed by refreshments in church. Please do come along and join us to celebrate. It's a chance for us to thank everyone for their support of the Flush Fund.

With every blessing.

Canon David Truby

The Annual Community BBQ

will be held on the

Sunday 4th August 2019

on the Church Croft, Well Street

from 3pm onwards

in conjunction with the Parish Council

Everyone is welcome

JESSIE BUXTON AND ELTON WI

Jessie Buxton was a much-loved and respected member of Elton WI. She was a founder member in 1951 and was there until the final meeting in 2016. She was a hard worker throughout, being a Committee member with several spells as President.

Jessie was always a doer. She organised members to embroider a WI tablecloth and she was always involved with the WI table at village fundraising events. Her house became the venue for our monthly Committee meetings. She also helped start the monthly Whist Drives held in the school and the Annual over 60s outing.

She was not shy of speaking at meetings and would always give a vote of thanks when asked.

Jessie was generous in providing refreshments for Group meetings, our Christmas party and Bakewell Town Hall Coffee mornings and liked to join in Carol singing around the village just before Christmas.

Members showed their appreciation of Jessie's work and commitment by presenting her with a garden seat. She will be greatly missed.

Winifred Woodward
Former WI member

Editor's note:

You may be interested to know that Jessie kept handwritten notes of the yearly events and Committee members for each year from 1951 to 2001. I was privileged to be able to bring these notes together in booklet form to mark the WI 50th Anniversary. If anyone would like a copy, I would be pleased to provide an 'MSWord' format version by email. Contact me on 01629 650857 or at eltonecho@tiscali.co.uk.

ELTON KEEP FIT

Tuesdays 1.45pm - 2.45pm
Elton Village Hall
£4.00 per session

- Stamina Improvement
- Body Toning
- Core Strengthening
- Balance Improvement
- Stretching & Relaxation

Exercises are adapted to suit a varied range of health & fitness levels and abilities, with chair based alternatives also given.

Come along and join our friendly group, making exercise fun and sociable.

For further details contact:
Helen Emmerson on 07957 369691



Outreach Service, Elton

located at:

**The School House, Elton Primary School,
Main Street, Elton**

NEW Opening time

Every Thursday between 12:30pm and 2:30pm

Services include:

**Postal services, stamps, pensions, benefits, council tax & bill payments,
Plus car tax & cash withdrawals**

(Some services may be subject to change)

Election Thanks

I want to say a big thank you to everybody who voted for me in the recent local elections. For those of you who have not yet seen the results for the Winster and South Darley Ward, it was as follows...

Charlie Foster Philips (Labour) 22 votes (3%)

Colin Swindell (Independent) 758 votes (97%)

Turnout for 57.6% - the highest for any ward across the district

The vote I received was far greater than anything I imagined. I was overwhelmed when I saw the number of ballot papers being counted and very grateful for the trust that residents have put in me.

I want to thank everybody who took the time to vote and to those people who supported me through leafleting, putting up posters, garden boards and spreading messages of support. I couldn't have done it without you and I will continue to work tirelessly and represent you to the best of my ability.

Now that the elections are over, its back to work and getting on with the job. Throughout the campaign a lot of problems, concerns and issues were raised with me. I have already begun the work of addressing these. If you raised an issue of concern with me, I will be in touch with you in the coming weeks to update you.

With the controlling conservative groups majority reduced to just one councillor I hope that the new council will adopt a more cooperative approach where there is cross-party consensus to tackle the challenges we face and opposition councillors are listened to more.

I will keep my promise of not siding with any party and will not join any voting block or coalition. I will vote, for or against, items on a case by case basis. I will only support policies, ideas and services that benefit my constituents, our communities and the wider Derbyshire Dales.

Overall Summary of the Derbyshire Dales Results

Overall across the Derbyshire Dales, the Conservative group have retained control of Derbyshire Dales District Council with a reduced majority - they now have a majority of 1 down from 9.

The Liberal Democrats take over from Labour as the official opposition. The Lib Dems gained 5 new councillors on their 2015 return and Labour have gained one. The Greens were winners too, taking two seats, and the voters also returned 3 Independent councillors. It means the Conservatives hold control by a single seat, taking 20 of the available 39 seats.

The last result of the Count at Wirksworth Leisure Centre was declared at 4.45am - a single vote victory for the Green Party candidate Matthew Buckler in Stanton.

So the final result was:- • Conservatives 20 seats • Lib Dems 8 • Labour 6 • Independents 3 • Green Party 2

The overall Derbyshire Dales turnout was 41.6%.

Thanks again

Colin Swindell

District Councillor

colin.swindell@derbyshiredales.gov.uk

07816 986 956

**Want to see family and friends
without the hassle?**

**Homestead Farm
B&B and Self-catering Cottage**

Book them in with Jean or Alan Carson

Tel. 650359

APRIL 1st and Each Monday. 11am - 3pm .

TEA & CHAT @ the CLIFF. Cliff Farm, Cliff Lane, nr. Elton DE45 1LL

Thank you for bearing with me during my recuperation period.

TEA & CHAT @ the Cliff will re-open on Monday, 1st April. (That's right.

It's not an April Fool's Day joke... we Really are opening on April 1st.)

Come and share a cuppa with us in beautiful, calm surroundings. (Sit outside if the weather is pleasant!). Come on your own, or bring a friend, for a little bit of companionship. Stay as long as you like. It will be good to see you!

For information phone/text me Christine M 07837 725337

01629 650712 ansaphone. email: relax@peakserenity.co.uk

Continued from page 2

household that has not received their caddy liners or compostable sacks by the end of May should contact the District Council no later than the end of June on 01629 761100.

As always, please get in touch with me if you have any issues with waste collection services or the delivery of your caddy liners and compostable sacks.

Plans for new children's play equipment

I'm sure many people in Elton, particularly those with young children, will agree that the play equipment on Elton Jubilee Field needs replacing with something new and modern. On behalf of the Jubilee Field Committee, I have been researching the cost of new equipment, what is currently available, who are the best suppliers and how it could be funded. I have recently met on site with a provider to discuss these points and see what they have to offer. Plans and costings for new play equipment are now being drawn up and I will look to see if this is something we can realistically pursue.

If the project was to go ahead, it will not happen overnight. The cost of new equipment will run into the 10's of thousands and a lot of work will have to go into fundraising and applying for grants. A new play area on the Jubilee Field would be a worthwhile project, which would help to encourage outdoor activities and provide a safe environment for toddlers and young people to play.

If you have any thoughts or ideas on how this money could be raised, know of local business that might be interested in making a donation or have fundraising ideas, please let me know.

Can I help you?

I am always here to help in any way I can. If you need help, have an issue of concern or know of a problem that needs fixing, please contact me. My contact details are below. If I can't help you, I will always try to point you in the right direction.

Colin Swindell
District Councillor
Winster and South Darley Ward

Address: Laburnum Cottage, Well Street, Elton, Matlock DE4 2BY
Telephone : 07816 986 956
Email : colin.swindell@derbyshiredales.gov.uk

Village News and Views



Peak Pre School has a cosy and Stimulating environment with a capacity for ten children helping them feel safe and secure whilst they learn through play. We offer a wide range of activities and promote outdoor learning in our wonderful garden.

Ofsted rated GOOD in December 2015.

15 and 30 hours funded places available for 2,3 and 4 year olds. Other funding options available.

£4 per hour for non-funded places.

3 hour sessions of 8.45am-11.45am or 11.45am- 2.45pm

Or

6 hour full days from 8.45am- 2.45pm Monday to Friday.

To arrange a visit contact Sarah on 07799084244 or email peakpreschool@outlook.com

Attached to Stanton in the Peak Primary School,

School Lane, Stanton in the Peak,

Derbyshire, DE4 2LX

Facebook search: "Peak Pre School"

South Darley & Winster Pre-School

At

The Burton Institute, West Bank, Winster

A small friendly, family like atmosphere for children aged 2-4 years to learn, play and grow together.

Funded places available for all 3 year olds and eligible 2 year olds.

Open Term time.

Monday - Thursday 9am-12pm, 12pm -3pm.

Morning, afternoon or full day sessions available.

Please contact Kirsty on 07863771636 or 01629650867
or email info@southdarleypreschool.co.uk for information.

Have a look at our website www.southdarleypreschool.co.uk

1914 – ELTON CRICKET CLUB AND THE ONSET OF WAR

‘The lamps are going out all over Europe. We shall not see them lit again in our lifetime’ the British Foreign Secretary, Sir Edward Grey, famously remarked on the eve of the UK entering the First World War in August 1914. So the Annual Report of Elton Cricket Club for 1914 is a particularly interesting read – not least because that season was played out against this most sinister of backdrops. Indeed, before stumps were drawn at the conclusion of the final game of that unusual summer, war had been formally declared. By the time the Club’s 1914 Annual Report was finalised and printed in the early months of 1915, it is highly likely that at least some Elton cricketers were amongst the hundreds of thousands of men who had already volunteered for service by then and who were well into their initial period of basic training. I will return to the subject of the war later in this piece but first – a few words about the cricket.

Ironically, the 1914 season saw Elton Cricket Club going from strength to strength – running a second team for the first time in the history of the club. Given that communication, transport and ground preparation would be very much more challenging than is the case today – one can only admire the effort which must have gone into keeping two teams up and running at that time. Prizes for the 1914 season were presented at the club’s annual supper later that year which rather indicates that it was business as usual, at least for a time, following the declaration of war on 4 August.

The 1914 Club accounts were boosted by donations of one pound one shilling (one guinea) by the club president, Mr C H Britton and of 10 shillings and sixpence (a half guinea) by Earl Kerry MP. I assume that, as now, the players enjoyed a post match beer or three. I am not sure which pub they favoured - and the accounts offer no direct clue as there were donations of five shillings each from both Mr Joseph Stone (my grandfather) who kept the Duke of York, and from his counterpart at the Red Lion pub, Mr Reuben Bunting.

The accounts list the 29 players who each paid a member’s subscription of two shillings and sixpence and it is a quick scan of their names which re-ignites the connection with the First World War. I doubt whether Harry Allison or John William Boam regarded themselves as the shining lights of Elton Cricket. Certainly their respective playing contributions in 1914 were fairly modest. Harry - just 16 years of age in 1914 - batted for the first eleven on six occasions for a total aggregate of 10 runs. John turned out for the first eleven just twice scoring only three runs in total. Although their names were little more than footnotes at the lower end of that season’s batting averages, these two men will endure in this village long after most of us are forgotten. For both of them would lose their lives in the service of their country within

Continued on page 11

A Gift to Elton

This building was a familiar landmark in Elton for over 90 years. It's still here but was transformed in 1923 when the top storey was removed and the windows 'Gothicized'. Yes, it's the old Wesleyan chapel, now the village hall.



This splendid oil painting hung in the chapel and in 1982 when the village hall trustees purchased the building it was given to the oldest member of the congregation, Mrs Francis

THE ELTON "100 CLUB"

Continued on page 13

We have a number of unused numbers available to purchase at a cost of £1 per month (£12 for the year). A monthly draw takes place with the top prize being £25. All remaining proceeds go towards the maintenance of the Jubilee Field.

We are looking for new members who would like to join or existing members who wish to purchase more numbers.

Just contact Cath Dawe on 01629 650649 or Carolyn Wilson on 01629 650757 to choose your numbers.

We are also looking for a volunteer to make collections in the east end of the village. It's not a monthly task, it can be done to suit yourself. Please contact one of the above to discuss.



Paws First Pet Care
Professional Pet Services

Bespoke and tailored premium pet care specialising in:

- ***Home visits for small animal care - cats, guinea pigs, rabbits, chickens, reptiles etc***
- ***1-2-1 Dog walking and canine enrichment sessions***
- ***Puppy visits***
- ***Fully insured***

Tel: 01629 650693 / 07885 709074
enquiries@pawsfirstpetcare.co.uk
www.pawsfirstpetcare.co.uk

Continued from page 9

the space of a couple of months towards the end of 1916. Each Remembrance Sunday, the names of the eleven Elton men who perished in the First World War and the two who lost their lives in the Second World War are remembered in Elton Church. Harry Allison and John William Boam are, of course, among the names read out aloud on that day each year.

John William Boam was born and baptised in Elton and worked as a farmer prior to enlisting in the army. He was 23 years old when he died at the Somme on 15 September 1916. John's name is listed on the Thiepval Memorial in France which commemorates those who lost their lives at the Somme but who have no marked grave. One historian estimates that only around half of the British Empire dead on the Somme battlefields were found and identified.

Harry Allison lost his life on 21 November 1916, aged 18. Although he had joined up, he was in the UK at the time he died. Alone amongst the Elton war dead, Harry Allison was actually buried in Elton churchyard. Whereas several of the other Elton men lost in the wars are remembered on family gravestones here in the village, their official headstones stand at the place where they are buried overseas. It is only Harry Allison's grave at Elton which is marked by the familiar 2 feet 6 inches high, 15 inches wide Portland Stone military headstone designed by the Imperial War Graves Commission shortly after hostilities ended in 1918 and which, of course, stand row upon row in War Grave Cemeteries all over the world. Harry Allison's funeral was a significant moment in Elton's history. He was buried in our churchyard with military honours which included the playing of 'The Last Post'. The children were allowed out of school to watch the impressive proceedings. It would not have escaped the notice of the teachers that, less than five years earlier, young Harry had been at school with them.

JOHN STONE

Don't forget

You can advertise items
for sale on the back page
or if there is something you want
that can be included as well

And it's all FREE for non-business adverts

A hand-written note will do or email to
eltonecho@tiscali.co.uk



Frances Burton
BSc(Hons) MNIMH
Medical Herbalist



Herbal Medicine Consultations

Consultation: £40, follow-ups £20 plus herbal medicine @ £7/week

Elton residents: 25% discount on consultations, home visits available

Practice based in Ashbourne and Wirksworth

Tel: 07791326212

francesburton.burton@gmail.com

Facebook: Frances Burton the Herbalist Derbyshire Dales

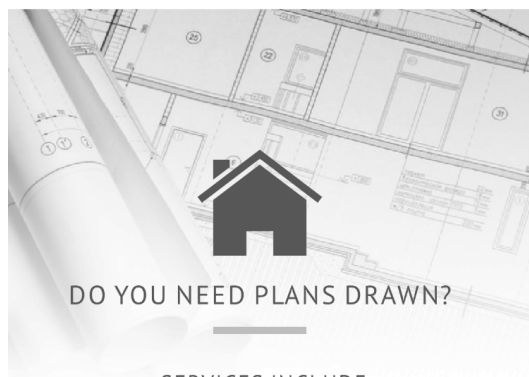

SERVICES INCLUDE

- Site Consultation & Design Advice
- Drawings for: Conversions, Extensions, refurbishments etc.
- Sketch to CAD Drawings
- Planning Advice and Application Submission
- Building Regulations Advice & Submission
- Planning Appeals

Please call: 01629 700487

For a free site consultation.

enquiries@apestates-design.co.uk

www.apestates-design.co.uk

Calling all holiday accommodation providers in Elton and Gratton

If you would like copies of the Elton Village Guide leaflet and the Elton Village Trail booklet for your clients please contact eltonhistory@talk21.com or phone Lynn on 650015.

The Sanctuary

Cliff Farm, Cliff Lane, between Elton and Alport. DE45 1LL

Here at Cliff Farm, a Christian place of peace has been created for use by anyone in need of relief from the worries of everyday life, or relaxation.

Come for a coffee and experience the stillness and the quietness.

Small community groups, church groups (for away days), small businesses with little funds looking for a place to meet are welcome (great for workshops, seminars, fundraising, etc.)

Phone or text me Christine Mob. 07837 725337

Email 1: thesanctuary@peakserenity.co.uk

2: relax@peakserenity.co.uk

Christine Earl

07816 201746 / 07541 541708

Neils Taxi

Personal logistics

Reliable Private hire / Hackney carriage
Airports - Business / Holidays



Comfortable & spacious 6 seated Galaxy's

www.neils-taxi.co.uk

neilstaxi@btinternet.com

Continued from page 10

Watson who lived in the School House with her family. It wasn't until the 1950s that the chapel was registered for the solemnisation of marriages and Mrs Watson's daughter Joan was the first to be married there. Joan and her daughter Andrea have kindly returned the painting to Elton to hang once again for all to see.

Until 1831 the only place of worship in Elton was All Saints church although there had been a Quaker meeting house at Well Street Farm for a few years in the 1720s. The Methodist movement founded by John Wesley (1703-1791) became extremely popular amongst working people in Derbyshire villages and by the 1820s there were many Methodists in Elton. They managed to raise the £90 necessary to build their first chapel and school room in 1831 on land that had previously been part of the village green. The school room was the same dimensions as the main part of the hall today and above it was the chapel, reached by exterior stone steps with wooden rails. According to a religious census taken in the 1850s there was a service every Sunday evening at which the average attendance was 55. Methodists recognised the importance of education and accepted any child into the Sunday school, whether Methodist or Anglican. The class size was about 40 and would also include some adults keen to become literate. This was a decade before the Church of England day school was built.

By the mid 1850s two other sects of Methodists had built their own chapels, the Primitive Methodists on West End and the Wesleyan Reformers in Milner Yard. They were all well attended in the 1940s and 50s. Margaret Cooper recalls that in those days families found most of their entertainment within the village and the highlight of the year was Whit week, beginning on the 7th Sunday after Easter, known as Whitsunday. On a different day of that week each chapel put on what was called a 'Sitting Up Day'. Despite general financial hardship parents would provide their children with new outfits for the special day. A tier of seats would be raised next to the pulpit and the children would sit up on these, with the smallest at the front, all dressed in their best. This was a time when the different sects of Methodists would visit each other's chapels to be entertained by the children singing and performing recitals.

Lynn Burnet

R. Stone - Joinery

*All types of joinery work undertaken
Free Quotations*

Robert Stone

3, Ivy Lane, Elton, DE4 2BX

Mobile: 07971 815683

FIREWOOD FOR SALE

Seasoned hardwood logs cut & split

Builders bulk bag (1m³) £60; £5 deposit on bag

Free delivery in Elton and Gratton

Elsewhere £10 for one, £15 for 2 or 3 bags

Tel: Simon 650209 or 07889 107008

Email: simonfowler1@btinternet.com

Village News and Views

JUST A THOUGHT

If you are not one of the residents who receive the Elton Echo electronically did you know that you may be missing out

Despite all our efforts ,we cannot always guarantee to deliver hard copies on time for events which are happening early in the first month of each quarterly edition.

If you sign up you will receive each edition as soon as it goes to the printers. You can then either read it on your laptop, tablet or even on your smart phone/TV. If you still want a hard copy you can always print it off and if you want to save paper just select '2 pages per sheet' in your printer properties when printing. It comes out as 2 pages in A5, so just cut it in half and staple it together. But if your printer has 'Booklet printing' facilities, it's even easier!

For residents with no computer facilities we are still very happy to provide you with a hard copy to read.

To sign up, just send your name and address to Colin Swindell at elton@live.co.uk or to the Editor at eltonecho@tiscali.co.uk. We look forward to hearing from you.

If you feel you could make a contribution to the Echo in the form of an article of interest to readers or an upcoming event or photos of a past event, please contact me by email at eltonecho@tiscali.co.uk .

Articles should be in .doc, .docx (not .pdf) or in .jpg format for pictures, approximately 750 words would be ideal and received by the copy date which is always the start of the month prior to quarterly publication. However, I can always save them for future issues if not time sensitive, so any time will do.

I am most grateful to our regular contributors; without them the Echo would be full of blank spaces.

The Editor

The Haven @ Peak Serenity

Cliff Farm,Cliff Lane, nr. Elton DE45 1LL.

Available to rent on Harthill Moor. (Elton within walking distance, Bakewell & Chatsworth ,5 miles ..come to Chatsworth Show !).

Comfortable, secluded, ground floor,self-catering apartment for 2 people. Lounge, kitchen, 1 bedroom, shower room with toilet.

Walk into the beauty of Harthill Moor and surrounding area from your door... sit and watch the world go by...

Ideally situated for walking, photography, visiting world famous places of interest, ie. Chatsworth House, Haddon Hall & Bakewell with its Farmers' Market, Agricultural Show fetes, etc.

The Haven is Dog friendly.(1 dog) and is available to rent Thursday - Sunday (min. 3 nights)

For information/booking, please text/phone, me. Mrs. Christine Earl M.07837 725337.

Or email: relax@peakserenity.co.uk

Across

1. Deceptive publicity (4)
3. Bang on (7)
9. Get it down (5)
10. Latently tarnished (7)
11. Comprehensive reversal (8)
12. Move of faith (4)
15. Frequently backward (5)
16. Turmoil (5)
20. Dream on (4)
21. Impudence (8)
23. Conniver (7)
25. Freak out (5)
26. What it takes (7)
27. Honesty around (4)

Down

1. Short stroke (6)
2. Inestimable (9)
4. Take your pick (6)
5. Wet stuff (4)
6. Mog (3)
7. Knock for six (7)
8. Settle in (5)
13. Vindicate (9)
14. Blueprint (7)
17. Stylish (5)
18. Animal rummage (6)
19. If one's not enough (3,3)
22. Upwardly green (4)
24. A male 18 down (3)

ROBIN'S KNOTTY CROSSWORD

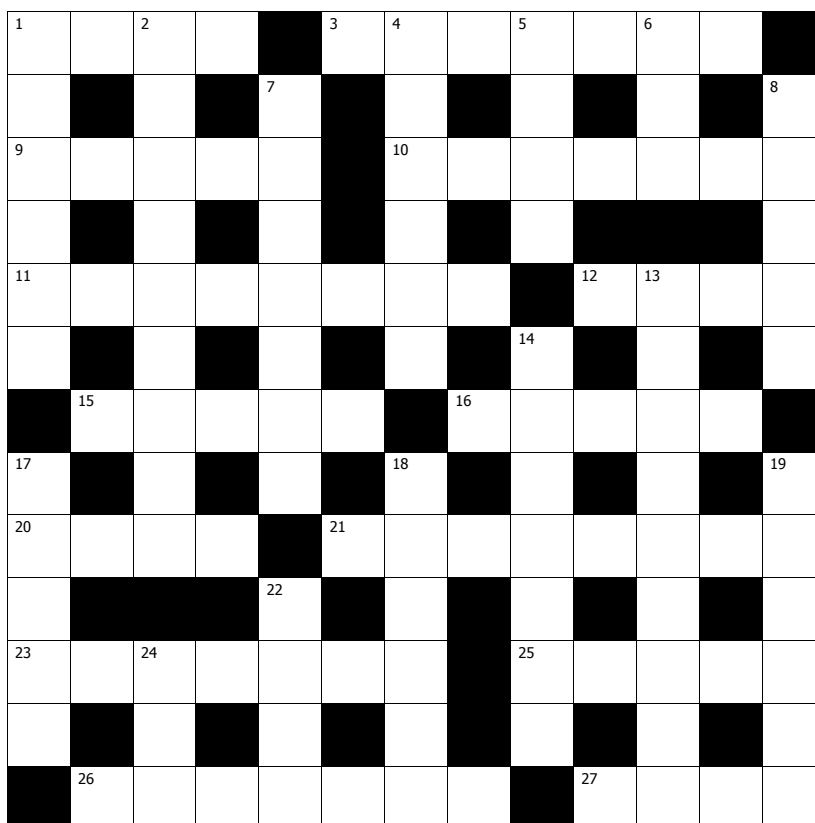

Note: This crossword is published here with the kind permission of its compiler, Robin Hemmingway.

SOLUTION ON BACK PAGE

Lifeboat for the Bereaved

If you are struggling with the loss of a loved one, husband, wife, friend, relative, well-loved pet and would like to talk with someone who has 'been there', phone me, Christine and come and have a coffee.

M.07837 725337/01629 650712,
email: relax@peakserenity.co.uk or
peace@lifeboatforthebereaved.co.uk

DJG Taxis

4 & 8 seater Taxi Service

Airports, Days/Nights out, etc.

Contact John Gladwin

**Tel: 01629 650025 or
07767238331**

Website: www.djg-taxis.co.uk

Email: john@djg-taxis.co.uk

The Small Ads

For Sale/Wanted

Non-business adverts in this section are free to village residents

Contact the editor if you wish to place an advert here

Resources

Community Transport

A Dial-a-Bus service for elderly &/or disabled people operates on the 1st and 3rd Thursday each month to Buxton arriving 11.15am & departing 1.15pm. To reserve a seat, contact 641920

Jubilee Field

The pitches & pavilion are available for hire. For all bookings, contact Jasmine Banks on 07580005179 or email her at jazzb22@hotmail.co.uk

Mobile Library

Calls once every 4 weeks on a Friday from 28th June
Duke of York - 10.10 - 10.40am
Call 01629 533190 for details.

Post Office

Outreach Service

Every Thursday in the School House
From 12.30 - 2.30pm

Village Hall

Hire of hall: **New Rates** £7.50 per session or £20 all day for residents & village organisations. Non-residents at reasonable rates. For bookings or more information contact Sue Lightfoot 650641

Winster Surgery Hours

Mon – Fri 8.30am to 12noon
Mon & Wed only 2.00pm to 6.00pm

Each month one Wednesday is not open in the afternoon. See list on Surgery door

CROSSWORD SOLUTION

Clues Across: 1.Hype 3.Correct 9.Print 10.Tainted 11.Etelpmoc (Complete) 12.Leap 15.Netto (Often) 16.Havoc 20.Wish 21.Perthness 23.Schemer 25.React 26.Ability 27.Nepo (Open)
Clues Down: 1.Hypphen 2.Priceless 4.Option 5.Rain 6.Cat 7.Stupely 8.Adapt 13.Exonerate 14.Pattern 17.Swish 18.Ferret 19.Use two 22.Emil (Lime) 24.Hob

Village Directory

- **Badminton** Kate French 650273
- **Bell Ringers** Richard Freemantle 07871450149
- **Bus services** Timetable 0870 6082608
- **Community transport** 641920
- **County Council** 08456 058 058
- **Cricket Club** Glynn Yates 650494
- **Crime Stoppers** 0800 555 111
- **Darts Teams** Paul Carson 650359
- **District Council** 761100
- **Doctors** (Winster) 650207 Emergencies 733205 or NHS Direct 0845 4647
- **Electrical emergencies** 0800 6783 105 or New national 3 digit number 105
- **Energy Efficiency Grants** 761304
- **Fire advice** 582849
- **Gas leaks** 0800 111999
- **History Group** Lynn Burnet 650015
- **Hospital** The Whitworth, Darley Dale (minor injury only) 580211
- **Housing advice** 761311
- **Jubilee Field** Jasmine Banks 07580005179
- **Mobility Scooter** (Tissington Trail) for more details contact 01335 343156 - seasonal only
- **Pre-schools locally** - see page 8 for details
- **Police** For emergencies dial 999 otherwise dial the NEW number 101 (It's confidential)
- **Power Cut?** Call 105
- **Rail services** Enquiries 0845 7484950
- **Refuse collection** DDDC 761122
- **School** 650282
- **School PTFA** Natalie Cooper 650561
- **Swimming pool** Bakewell - 814205 Matlock - Arc Leisure - 581322
- **Taxi Service** - Kate or Neil 07816 201746
- **Tourist information** Bakewell - 813227 Matlock - 583388
- **Village Hall** Bookings Sue Lightfoot 650641
- **Water emergencies** 0800 7834444