



The Elton Echo

A voice for everyone in Elton and Gratton

Winter 2019/20

www.eltonderbyshire.com

Issue No. 60

THE EDITORIAL TEAM

would like to wish all our
Readers, Contributors, Advertisers
Distributors and Printers

A VERY MERRY CHRISTMAS
and a
HAPPY, HEALTHY &
PROSPEROUS
NEW YEAR



Editorial Policy

We welcome your news, views and articles of interest, provided they are not anonymous, libellous or offensive. Views expressed are not necessarily those of the editorial team. Items may be condensed where necessary.

News items, for sale/wanted adverts and announcements are free to Parish residents. For business advertising rates please contact John Wellington 650857.

If you would like to join the editorial team please contact one of us.

Echo Editorial Team

John Moseley 650760
John Wellington 650857
Please send us your news, views, stories and diary events (for March, April, May & June) no later than:-

Next Copy Date
1st February 2020

to: John Wellington
Stride Cottage,
Main Street, Elton.
by email in .doc or .jpg (not .pdf) format
to: eltonecho@tiscali.co.uk
or handwritten

Diary Dates

December

- 2 Compline service 8pm CH
- 5 Parish Council meeting 7.30pm VH
- 8 Turning on the Christmas Tree lights 6pm
- 13 Elton Quiz Night 7.30pm
- 22 Lesson & Carols by candlelight 6pm CH
- 24 Crib Service 4pm CH
- 25 Christmas Morning Service 9am CH
- 31 Ringing in the New Year 11.45pm CH

January

- 2 Parish Council meeting 7.30pm VH
- 10 Elton Quiz Night 7.30pm
- tba ELHG 7.30pm VH

February

- 6 Parish Council meeting 7.30pm VH
- 14 Elton Quiz Night 7.30pm
- tba ELHG 7.30pm VH

March

- 5 Parish Council meeting 7.30pm VH
- 13 Elton Quiz Night 7.30pm
- tba ELHG 7.30pm VH

Weekly events

Tea/Coffee & Toast in Church - every
Thursday morning 10.00am - 12.00pm
Everyone is welcome

Gentle Keep Fit - every Tuesday from
1.45pm to 2.45pm in the Village Hall - £4.00
per session. See full details on page 5

Fortnightly events

Grey Bin & Food Caddy Collection
Every other Wednesday - from 4th December
Blue & Green Bin & Food Caddy Collection
Every other Wednesday - from 11th December

Four-weekly Mobile Library - see back page

Councillors Corner

Christmas Tree Light-up

Elton Parish Council would like to invite the residents of Elton and Gratton to the lighting of Elton's Christmas trees. This year's event will take place on Sunday 8 December starting at 6pm. We will begin by lighting the Christmas Tree at the Town Mere (by the telephone box) before moving on to light the second tree at the Church.

There will be carol singing with the Youlgrave Silver Band and afterwards everybody is warmly invited to the Village Hall for mulled wine, mince pies and cakes. We hope you will join us.

Winter Maintenance

Elton Parish Council is preparing for the winter months. We have a large supply of grit in storage which will be used to keep our grit bins fully stocked throughout winter. We will again be asking people to adopt a grit bin and make sure it is topped up. This will allow residents to clear snow and ice on the roads and pavements around their homes.

The Parish Council would like to remind everybody taxpayers' money is spent on the grit that is in our public bins and should only be used on roads and pavements - not on private property.

Christmas bin collections

This year, Christmas and New Year's Day fall on a Wednesday – which is the usual collection day for Elton and Gratton. Because of this, there will be significant changes to the day your bins will be emptied during the Christmas period.

The Wednesday collection scheduled for Christmas Day will take place earlier on Saturday 21 December. The Wednesday collection scheduled for New Year's Day will take place later on Thursday 2 January.

- Garden waste collections will be suspended from 21 December to 4 January inclusive.
- Food waste will still be collected weekly over the Christmas period on the collection dates outlined above.
- REAL Christmas trees will be collected from the edge of your property between Monday 6 January and Friday 31 January on the same day your garden waste is collected. Please make sure the tree is cut down to at least 5ft in height and all decorations are removed!
- Non-glitter cards and wrapping paper can be left in your blue bin insert or blue bag.
- Crews WILL NOT collect any additional household waste. Please make sure all household waste is contained in your grey bin or 4 black standard sized sacks on collection day.
- Crews WILL take excess recycling. Simply place extra materials at the side of your recycling containers, making sure it is easily identifiable as recycling materials.

Continued on page 7

Parish Councillors

John Moseley Chair 650760
Colin Swindell V.Ch 07816 986956
Nigel Mason 650440
Maralyn Marsden 650589

All correspondence to the Clerk:
Janice Jackson Tel: 650727
8 Bradley Close
Birchover
DE4 2BG

District Councillor

Colin Swindell 07816 986956

County Councillor

Simon Spencer 01335 324324

Member of Parliament

Patrick McLoughlin,
Derbys West Constituency Office
01332 558125

Village News and Views

YOUR VILLAGE. YOUR COMMUNITY. YOUR SHOP.

Halloween was a great success with amazing carved pumpkins and scary fancy dress costumes. Congratulations to all the winners.

It's that time again... "Santa's Grotto" will be on Sunday 8th December at Winster Shop from 5.00pm to 6.00pm followed by switching on the Christmas tree lights. Come along all welcome.

Christmas pre-orders are now being taken, please pick up an order form from the shop. Last date for Christmas orders is Thursday 19th December for collection on Tuesday 24th December from 12.00 until 3.30pm.

Once again we will have a selection of Christmas cakes for sale from Luke Evans or order now for Christmas. We will also be stocking:-

- Mince Pies, Christmas Puddings
- Tinned Shortbread Biscuits, Boxes of Biscuits
- Homemade Pickles, Chutney & Chilli Jam
- A wide variety of Chocolates
- Hand Knitted Animals
- Boxed Local Beers
- Cards, Gift Wrap, Tags

Shop Opening Times:

Mon – Sat	8.00am – 7.00pm
Sun & B/H	8.00am – 6.00pm

Opening times over the Christmas period:-

- Christmas Eve - Tuesday 24th December – 8.00 – 4.00
- Christmas Day - Wednesday 25th December – 9.30 – 12.30
- Boxing Day - Thursday 26th December – 9.00 – 3.00
- New Years Eve - Tuesday 31st December – 8.00 – 4.00
- New Years Day - Wednesday 1st January – 9.00 – 3.00

Otherwise normal shop opening times

Look out for our Prosecco & Wine, Cheese & Biscuits evening in December, evening to be confirmed.

From Jayne, Katrina, Staff and all the Volunteers



Winter Village Shop
www.winstervillageshop.com
 Tel: 01629 650683

All Saints Church

Team Rector: Canon David Truby 824707
Church Warden:

Monthly Services

2nd Sunday 9.30am Parish Eucharist
4th Sunday 6.00pm Evensong

December

December in a vicar's life is simply Christmas. During the Christmas week alone we will have 28 services across the Wirksworth Team Ministry Benefice! Make sure you get to one, they are great community events, and a great reminder of God's love. And in Elton, before Christmas we also have the special celebration of John Spreadborough being ordained a Deacon. December is all go! I love the "over-the-topness" of it all! But for some, December is a month of "too much". Too much loneliness, too much stress, too much food...

January

And then January comes around again, a time to start over – often seen as the month of new beginnings. In reality though, it's often the month to deal with leftovers – and not just of the food variety! Don't get me wrong, I quite like leftovers... you can make lovely new meals out of your leftovers. But often we can make a meal out of other things too: negative comments from difficult family members, or sibling rivalry, or pushy bosses, or ungrateful children, or loved ones that just don't appreciate us... you know what I mean. I have found that when dealing with leftovers (food or otherwise) there are only ever three approaches: they are either something you can deal with straight away (fridge option), or something that is too big to deal with now (freezer option) or something you really don't need and you decide to discard immediately (bin option).

Fridge: Deal with these things now. The emotional leftover equivalent is the saying: "don't let the sun go down on a disagreement".

Freezer: Some things need time to process - like the death of a loved one. You need time to grieve. Eventually though, these experiences can leave us with memories and feelings that pepper who we are.

Bin: this option requires honesty. Have you ever left ½ tin of baked beans in the back of the fridge only to uncover it two weeks' later, covered in mould? Well, unfriendly comments from a colleague or a put down from a family member are the half-tins of baked beans of the soul. If you leave them to fester they become a health hazard. Bin, bin, bin – let them go, don't hold grudges and set yourself free.

Jesus had a simple approach to human interactions, his motto was: "always do to others as you'd have them do to you".

February

In contrast I always think of February as a month of enforced calm. Let's be frank, by the time February comes around, any attraction Winter might have held in December is long gone. So, my suggestion is, instead of fighting it, wrap up warm, watch the snowdrops coming through in the garden and put the kettle on, because a cup of tea makes even the longest of darkest nights better!

Happy Winter everyone.

Rev'd Carla Vicêncio Prior
07767087530

Congratulations to John Spreadborough of Alice's Cottages who is to be ordained as a Church Deacon on Sunday 15th December at 3pm in Elton Church

**Everyone is welcome to attend the service
and join him in the Village Hall for
refreshments afterwards**

RSVP on 650829

ELTON KEEP FIT

Re-starts Tuesday 3rd September

1.45pm - 2.45pm

Elton Village Hall

£4.00 per session

- Stamina Improvement
- Body Toning
- Core Strengthening
- Balance Improvement
- Stretching & Relaxation

Exercises are adapted to suit a varied range of health & fitness levels and abilities, with chair based alternatives also given.

Come along and join our friendly group, making exercise fun and sociable.

For further details contact:
Helen Emmerson on 07957 369691



Outreach Service, Elton

located at:

**The School House, Elton Primary School,
Main Street, Elton**

NEW Opening time

Every Thursday between 12:30pm and 2:30pm

Services include:

**Postal services, stamps, pensions, benefits, council tax & bill payments,
Plus car tax, paying in cheques to your bank and cash withdrawals**

(Some services may be subject to change)

Village News and Views

The late Jean Gladwin

Unfortunately I was away on holiday when I was asked to do the eulogy for Jean's funeral so I would like to write a few words in memory of her.

Jean was born on the 4th October, 1941, the third of four children to Vera and Jack Evans. We shared the same birthday and were born in the same year.

She lived the first few years of her life opposite the church in Milner Yard and went to school in the village, moving later to the other end of the village until her marriage to Ron in 1964, when they went to live in Matlock and then coming back to live in Elton at Woodbine Farm in 1982. They had four children, Steven, Dianne, Lynda and John. Tragically their eldest child Steven died when he was eleven years old.

Jean led a very active life with four young children and whilst in Matlock she also spent a few years commuting back to Elton to help her mother look after her father who had suffered a stroke. She was a good cook and her roast Sunday dinners were a speciality, but I have it on good authority the chip pan will be sorely missed!

Jean and I were very good friends. She was always full of fun and had the same happy outlook on life. We worked together on the Village Hall Committee when it was first formed and I have known her for over forty years.

In 1991 she was critically ill but survived to have a fabulous 50th birthday party and many more years with her family and friends. One of her main interests was flower arranging and she and her sister Marg were very involved with both Matlock and Bakewell Flower Clubs and helped with various church flower festivals together with flowers for weddings in Elton. Both of them helped arrange the flowers with other people from the village for both our children's weddings. They also enjoyed quizzes.

Jean leaves behind her siblings Gor, Marg and Chris, children Dianne, Lynda and John, grandchildren Louise, Rachel and Harry and step grandchildren Ben and Becky .

Jean loved Elton and her life here and will be greatly missed by us all and we offer our condolences to the family at this sad time.

John Bent

**Want to see family and friends
without the hassle?**

**Homestead Farm
B&B and Self-catering Cottage**

Book them in with Jean or Alan Carson

Tel. 650359

**Calling all holiday accommodation
providers
in Elton and Gratton**

If you would like copies of the Elton Village Guide leaflet and the Elton Village Trail booklet for your clients please contact eltonhistory@talk21.com or phone Lynn on 650015.

Continued from page 2

Free Parking throughout December

Derbyshire Dales District Council is once again providing free parking everyday throughout December from 2pm. This is on top of the free parking provided through your residents parking permit which allows free parking up to 11am and after 4pm.

The scheme starts on 1 December and is available on **all Derbyshire Dales car parks** throughout the District. Please make sure that the car park is operated by the District Council by looking for the Council's logo on the pay and display boards. Charges might apply on private car parks or those operated by other local authorities. Furthermore, please make sure that if you are using the car park before 11am that your Dales parking permit is clearly displayed on your vehicle's dashboard.

Christmas wishes

On behalf of the Parish Council and myself, we wish everybody a Merry Christmas and a Happy New Year.

Can I help you?

I am always here to help in any way I can. If you need help, have an issue of concern or know of a problem that needs fixing, please contact me. My contact details are below. If I can't help you, I will always try to point you in the right direction.

Colin Swindell

District Councillor

Winster and South Darley Ward

Address: Laburnum Cottage, Well Street, Elton, Matlock DE4 2BY

Telephone : 07816 986 956

Email : colin.swindell@derbyshiredales.gov.uk



ELTON PARISH COUNCIL

invites all Elton & Gratton residents, family and friends



Xmas tree lighting carol singing with the Youlgrave Silver Band mulled wine & mince pies

6 pm on Sunday 8th December 2019

meet and sing and light the tree at the Mere (telephone box)
walk to the church and light our second tree
proceed to the Village Hall for mince pies and merry-making



Sausage rolls, savoury snacks, buns and mince pie
donations to the Village Hall

4-6 pm on the day would be much appreciated



Village News and Views



Peak Pre School has a cosy and Stimulating environment with a capacity for ten children helping them feel safe and secure whilst they learn through play. We offer a wide range of activities and promote outdoor learning in our wonderful garden.

Ofsted rated GOOD in December 2015.

15 and 30 hours funded places available for 2,3 and 4 year olds. Other funding options available.

£4 per hour for non-funded places.

3 hour sessions of 8.45am-11.45am or 11.45am- 2.45pm

Or

6 hour full days from 8.45am- 2.45pm Monday to Friday.

To arrange a visit contact Sarah on 07799084244 or email peakpreschool@outlook.com

Attached to Stanton in the Peak Primary School,

School Lane, Stanton in the Peak,

Derbyshire, DE4 2LX

Facebook search: "Peak Pre School"

South Darley & Winster Pre-School

At

The Burton Institute, West Bank, Winster

A small friendly, family like atmosphere for children aged 2-4 years to learn, play and grow together.

Funded places available for all 3 year olds and eligible 2 year olds.

Open Term time.

Monday - Thursday 9am-12pm, 12pm -3pm.

Morning, afternoon or full day sessions available.

Please contact Kirsty on 07863771636 or 01629650867
or email info@southdarleypreschool.co.uk for information.

Have a look at our website www.southdarleypreschool.co.uk

Smerrill

There's nothing new about climate change. What's different this time is that we know what's causing it and also what we can do about it. I don't propose to write about a global issue in a parish newsletter but I shall take the liberty of straying outside Elton and Gratton into our neighbouring parish of Middleton and Smerrill. I've always thought it odd that Smerrill still appears in the name of the parish, the village having been deserted more than 600 years ago.

Low, linear, grass-covered banks in the field on the east side of Smerrill Grange are all that remains of the medieval village of Smerrill. These earthworks mark the walls of 17 enclosures containing the foundations of former houses and barns. The enclosures aren't haphazard but were laid out on either side of a main street; the village was deliberately planned, and built between AD 1200 and 1230, most likely under the direction of the lord of the manor of Middleton. Middleton itself had its origins some 250 years earlier.

What follows is a possible explanation for the rise and fall of the village of Smerrill.

Between 1075 and 1275 Britain, together with the rest of Europe, enjoyed a mild climate, milder than it is today, enabling reliable arable farming at high altitudes in the Peak District. Severe winters were infrequent, summers were warm and dry and harvests were bountiful. The people of the Peak thrived and multiplied. More land around villages was ploughed up to grow more food for the expanding population. But Middleton found itself hemmed in, by the parishes of Youlgreave to the north and Gratton to the east, land belonging to Leicester abbey to the west and to the south a deep ravine in Kenslow Wood. There was good land available further to the south in the area now occupied by Mount Pleasant Farm but it would be a long trek from the village with oxen and ploughs to work a new field out there. The obvious solution would be to establish an overflow village nearer to the new open field - Smerrill. Why call it Smerrill? Because Anglo-Saxon settlers had recognised the excellence of the grazing on the hill, the cows producing fat-rich milk. In Old English *smeoru* means grease or fat. *Smeoruhyll* became Smerrill. The new village took its name from the pasture above it.

It wasn't an ideal location, exposed and windy, and with its water supply, Rowlow Brook, inconveniently in the bottom of a 30-metre deep ravine. The serfs of Middleton belonged to the lord of the manor and so those he selected to be the first inhabitants of Smerrill just had to go - they had no choice. We know of one of the 17 or so families making a living there in 1292. Robert Dyote with his sons Ralph, Elyas and Nicholas and daughter Agnes cultivated 12 acres of arable and kept cattle on the common grazing land. Harvests were good and their animals grew fat. But this wasn't to last. Ten years into the new century a bitterly cold winter hit England, so cold that the River Thames froze over. The climate continued to deteriorate over the next 20 years. Harvests failed, animals died of disease, people starved to death and just to add to the general misery, along came the Black Death in 1349. There were hardly enough serfs left to cultivate the fields close to Middleton and so no longer was there any need for an overflow village. Yields of grain were poor on the higher-altitude land near Smerrill and the village was abandoned. At least one couple moved to Youlgreave, where farmer Robert Smerhull and his wife were assessed for the Poll Tax in 1381.

The close relationship between the two villages as suggested here would account for why, centuries ago, the parish became known as Middleton and Smerrill.

Lynn Burnet

Further reading: L. Burnet (2018), *The inhabited medieval village of Smerrill*, Bakewell & District Historical Society Journal 45, p.72-78.

ELTON CRICKET CLUB – 2019 SUNDAY LEAGUE RESULTS

Elton's second season in the Mansfield Sunday League was not only very enjoyable but also successful in terms of results. The team could be well pleased with themselves, finishing runners-up to champions Blackwell in Division Two. There was only one defeat in the entire season when Elton somehow failed to chase down a meagre target of 69 runs at Langwith on 11 August. It was just one of those days!

With the football and skiing clubs now no longer functioning there is only the cricket club keeping the Elton sporting flag flying. It is important that we keep it going rather than join the likes of so many of the surrounding villages which are without any sort of sports team at all. So hats off to all those involved in keeping the Elton Sunday afternoon show on the road. To the players themselves of course but also to the tea ladies and supporters. A special shout too for the club's groundsmen, Ben Yates and Robert Stone, for their many hours of unseen work keeping the field in good playing order for cricket and, at the same time, in nice condition for general village use during the summer months. Finally – a huge thank you to all those involved in organising the excellent end of season 'do' in the new pavilion on 19 October.

Here is a full listing of Elton's Sunday League matches (where play was possible) during the 2019 season:

21.4.19 v Alfreton CC (Away) Losing Draw

Alfreton 236 for 7 in 40 overs (Rob Stone 4 for 60, Matt Heath 1 for 45, Brad Banks 1 for 38, Craig Elliott 1 for 20)

Elton 178 for 9 in 40 overs (Jack Stone 47, Matt Heath 39).

28.4.19 v South Wingfield (Away) Won by 30 runs

Elton 173 all out (Jack Stone 47, Sam Lightfoot 27)

South Wingfield 143 all out (Martin Firth 3 for 32, Dave Cooper 3 for 35, Rob Stone 2 for 30, Sam Lightfoot 1 for 28)

19.5.19 v Papplewick & Linby (Home) Winning Draw

Elton 99 all out (Jonathan Heath 30, Jack Stone 19 not out)

Papplewick & Linby 95 for 7 in 40 overs (Jonathan Heath 3 for 25, Rob Stone 2 for 42, Sam Lightfoot 1 for 12, Dave Cooper 1 for 5)

26.5.19 v Alfreton CC (Home) Losing Draw

Alfreton 114 for 7 in 40 overs (Sam Lightfoot 3 for 29, Dave Cooper 1 for 8, Rob Stone 2 for 20, Ben Jordan 1 for 8)

Elton 97 for 9 in 40 overs (Sam Lightfoot 25)

2.6.19 v Papplewick & Linby (Away) Match abandoned due to rain

Papplewick & Linby 193 for 4 in 40 overs (Dave Cooper 2 for 26, Rob Stone 2 for 50)

Elton 98 for 3 in 34 overs (Jack Stone 61 not out)

9.6.19 v Mansfield Victorious (Home) Match abandoned due to rain

Mansfield Victorious 194 all out (Rob Stone 3 for 50, Matt Heath 3 for 38, Dave Cooper 1 for 34, Sam Lightfoot 1 for 29, Ben Jordan 1 for 20)

Elton did not bat (rain)

Continued on page 13

RICHARD CORFIELD (1964-2019)

Anyone who has played cricket and been obliged to take their turn on the scorebook rota will appreciate what a luxury it is to have an official scorer do the job for you. Such a possibility presented itself to Elton Cricket Club in 2008 from a most unexpected source. To almost everyone's great surprise, Winster man Richard Corfield, returning to the area following a career in the Navy, promptly volunteered for the job. 'Korky' proved not only willing but also extremely able. He was an excellent scorer – neat and meticulous. It is fair to say that Richard took scoring very seriously and his rather intimidating appearance ensured complete respect from the players – and not just the opposition! Sadly for us, by 2010 Richard's dog-training business had expanded so rapidly that his all-too-brief association with Elton CC came to an end. Before I finish this short tribute, it is important to explain that Richard's somewhat combative appearance was entirely misleading. He was generous to a fault, kind, friendly and ever ready with a cheery greeting. Very sadly, Richard died suddenly in October at the age of 54. Everyone connected with Elton Cricket Club sends their condolences to his family and his very many friends. RIP Korky.

JOHN STONE

Hello Eltonions!

Winster and Elton Luncheon Club is looking for more volunteers to help out on Mondays at the Burton Institute.

Our members come from Elton, Winster and surrounding areas. They meet from 11.30 to 2.15. Volunteers set up the room, greet the members, serve a meal (which is delivered from the Whitworth Hospital) and lead an activity. Sometimes we go out for a meal or a visit. We need 2/3 volunteers for each session.

At the moment volunteers are helping out 3/4 times over 3 months, but with more personnel the commitment would be less. If you think you could join us, please contact Rosie Strauss (650 564).

Don't forget

You can advertise items for sale on the back page or if there is something you want that can be included as well

And it's all FREE for non-business adverts

A hand-written note will do or email to eltonecho@tiscali.co.uk

Also for business adverts



Frances Burton
BSc(Hons)MNIMH
Medical Herbalist



Herbal Medicine Consultations

Herbal medicine combines traditional knowledge and scientific research to give an effective natural medicine supporting a wide range of health conditions. Herbalists select the most appropriate herbs to each person, making up individual prescriptions that are compatible to be taken alongside conventional medicines.

For more info see www.herbalmedicinederbyshiredales.com or to discuss how herbs can help your health, contact Frances Burton, 07791326212 or email francesburton.burton@gmail.com. Home visits possible in Elton, otherwise clinics in Coach House Studios, Wirksworth and Natural Choice, Ashbourne.

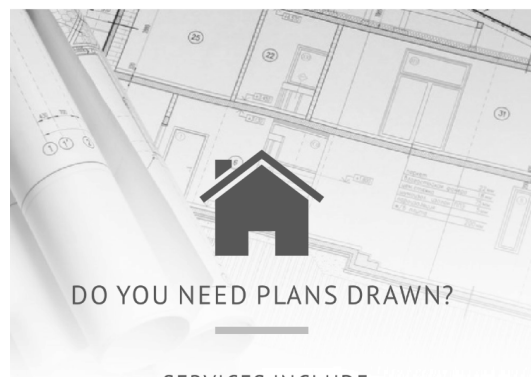

DO YOU NEED PLANS DRAWN?

SERVICES INCLUDE

- Site Consultation & Design Advice
- Drawings for: Conversions, Extensions, refurbishments etc.
- Sketch to CAD Drawings
- Planning Advice and Application Submission
- Building Regulations Advice & Submission
- Planning Appeals

Please call: 01629 700487

For a free site consultation.

enquiries@apestates-design.co.uk

www.apestates-design.co.uk

Post Office Outreach Service

A few years ago we lost our small Post Office run by Sarah Glossop. This was convenient to everyone in the village but of great hardship to older residents and those without transport.

With some effort we eventually secured our current Outreach Service supplied by Two Dales Post Office which still operates from the School House. However, this is only being used by a small number of residents.

We know it's only open for 2hrs on a Thursday, but we urge you to use it whenever you can for the sake of those that need it most.

Otherwise it's **'USE IT' or 'LOSE IT'**

07816 201746 / 07541 541708

Neils Taxi

Personal logistics

*Reliable Private hire / Hackney carriage
Airports - Business / Holidays*



Comfortable & spacious 6 seated Galaxy's

www.neils-taxi.co.uk

neilstaxi@btinternet.com

Continued from page 10

23.6.19 V Mansfield Victorious (Away) Won by 6 wickets

Mansfield Victorious 53 all out (Jonathan Heath 5 for 5, Rob Stone 3 for 23, Martin Firth 2 for 5)

Elton 55 for 4 (Jack Stone 23 not out)

07.07.19 v South Wingfield (Home) Won by 8 wickets

South Wingfield 130 for 9 in 40 overs (Sam Lightfoot 4 for 14, Brad Banks 2 for 30, Matt Heath 1 for 21, Rob Stone 1 for 42)

Elton 135 for 2 in 26 overs (Ben Jordan 62 not out, Ashley Mays 20 not out)

21.07.19 v Selston (Away) Won by 8 wickets

Selston 91 all out (Brad Banks 4 for 22, Sam Lightfoot 2 for 24, Rob Stone 2 for 20, Matt Heath 2 for 19)

Elton 94 for 2 (Jack Stone 37, Craig Elliott 37 not out)

4.8.19 v Shirebrook (Away) Won by 6 wickets

Shirebrook 147 all out (Brad Banks 3 for 51, Rob Stone 2 for 30, Matt Heath 2 for 30, Sam Lightfoot 1 for 25)

Elton 148 for 4 (Lee Marsden 66 not out, Matt Heath 41 not out)

11.8.19 v Langwith (Away) Lost by 2 runs

Langwith 69 all out (Rob Stone 4 for 21, Brad Banks 2 for 12, Dave Musgrave 1 for 21, Martin Firth 1 for 3, Dave Cooper 2 for 1)

Elton 67 all out (Jonathan Heath 20, Dave Cooper 16 not out)

18.8.19 v Langwith (Home) Won by 2 wickets

Langwith 110 for 9 in 40 overs (Sam Lightfoot 2 for 14, Jonathan Heath 1 for 18, Dave Cooper 2 for 6, Martin Firth 2 for 22, Ash Mays 2 for 19)

Elton 111 for 8 (Lee Marsden 25, Ash Mays 36 not out)

1.9.19 v Blackwell Miners Welfare (Home) Losing draw

Blackwell MW 192 for 5 in 40 overs (Jonathan Heath 1 for 53, Sam Lightfoot 1 for 41, Ash Mays 3 for 23)

Elton 187 for 9 in 40 overs (Craig Elliott 66, Steve Blair 52)

JOHN STONE

R. Stone - Joinery

*All types of joinery work undertaken
Free Quotations*

Robert Stone
3, Ivy Lane, Elton, DE4 2BX
Mobile: 07971 815683

FIREWOOD FOR SALE

Seasoned hardwood logs cut & split

Builders bulk bag (1m³) £60; £5 deposit on bag
Free delivery in Elton and Gratton
Elsewhere £10 for one, £15 for 2 or 3 bags

Tel: Simon 650209 or 07889 107008
Email: simonfowler1@btinternet.com

Village News and Views

The 100 Club was re-launched at the beginning of October

and is now called

'The Jessie Buxton 100 Club'

Jessie was a founder member of The 100 Club back in 1977. This fundraiser was set up to help fund the upkeep of the Jubilee Field. It will continue to do so and will raise over £100 annually (depending on level of subscription).

We would like to thank everyone who has kept their number and also welcome and thank new members. A special thank you goes to Margaret Barnsley, Maralyn Marsden, Carolyn Wilson and Kate Barlow our wonderful collecting team! Without them this wouldn't be possible.

Elton Jubilee Field Trustees - Charity Number: 507662

October Winners

No. 23 Iris Wright - £50

No. 74 Matt Thomas - £25

No. 64 Lynda Gladwin - £10

November Winners

No. 46 David Treasure - £50

No. 100 Bev Shimwell - £25

No. 79 Rosemary Janes - £10

If you feel you could make a contribution to the Echo in the form of an article of interest to readers or an upcoming event or photos of a past event, please contact me by email at eltonecho@tiscali.co.uk .

Articles should be in .doc, .docx (not .pdf) or in .jpg format for pictures, approximately 750 words would be ideal and received by the copy date which is always the start of the month prior to quarterly publication. I am most grateful to our regular contributors; without them the Echo would be full of blank spaces.

The Editor

The Sanctuary p.s. (Christian Retreat)
at Cliff Farm, Cliff Lane, nr Elton.

A small, restful Christian Retreat, nestling on Harthill Moor.

Come, have a coffee (or tea), rest and revitalise your spirit in this peaceful, inspirational place. Come on your own or with others. Bring your church or community groups for Away-days.

(Quiet space available and 'breakout' areas in garden).

Contact me, Christine Earl, for details and directions.

M: 07837 725337 e:relax speak serenity.co.uk

Closed between Nov.1st-March 1st.(we get a lot of snow)

Thank you ..Christine

Across

1. First light (4)
3. Centrally placed (7)
9. Scrounge (5)
10. Hangs down (7)
11. Equestrian discipline (8)
12. Fixed place (4)
15. Swap around (5)
16. Power push (5)
20. Bonny boat Isle (4)
21. Bang on (8)
23. Leave behind (7)
25. Roulade of birdsong (5)
26. Unworthy (7)
27. Master returns

Down

1. Noughties for example (6)
2. As 3 across (9)
4. Colour of the rainbow (6)
5. Harry's stick (4)
6. Slippery one (5)
7. Assess (7)
8. Put away on end (5)
13. Unbelievably fast (9)
14. Bites the bullet (7)
17. Habitual (5)
18. Piano fixers climb up (6)
19. Goes on two wheels (6)
22. Eric the Python (4)
24. Barley broth (3)

ROBIN'S KNOTTY CROSSWORD

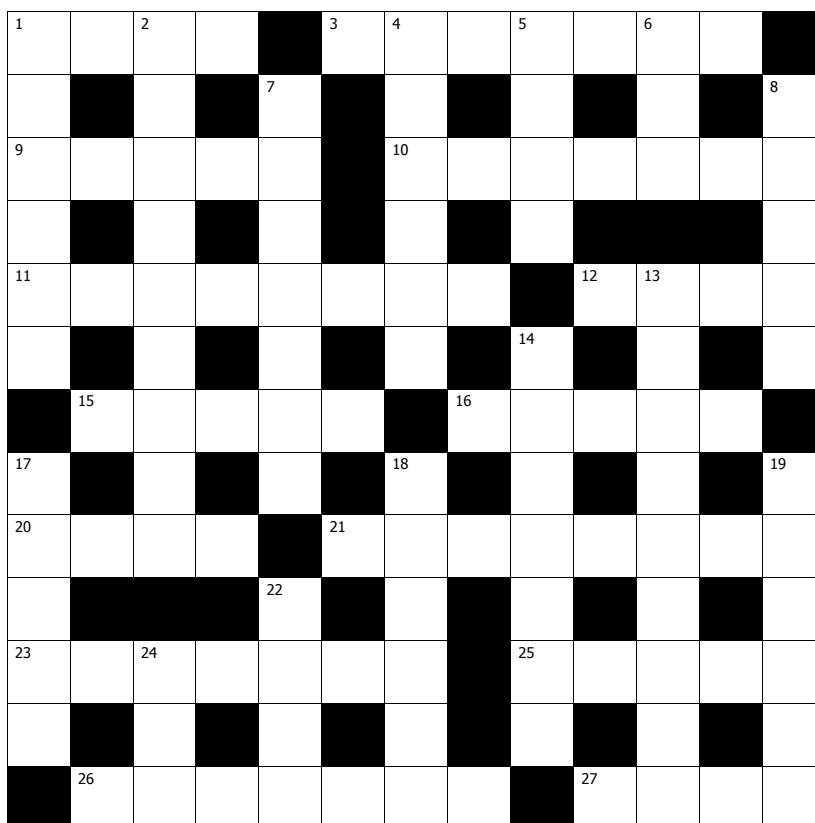

Note: This crossword is published here with the kind permission of its compiler, Robin Hemmingway.

SOLUTION ON BACK PAGE



Paws First Pet Care
Professional Pet Services

Bespoke and tailored pet minding services specialising in:

- *Home visits to care for your for small animals - cats, rabbits, guinea pigs, chickens, small rodents, reptiles*
- *Small holder visits – sheep, goats, alpacas, fowl, vegetable plots*
- *Fully insured*

Tel: 01629 650693 / 07885 709074
enquiries@pawsfirstpetcare.co.uk
www.pawsfirstpetcare.co.uk

DJG Taxis

4 & 8 seater Taxi Service

Airports, Days/Nights out, etc.

Contact John Gladwin

**Tel: 01629 650025 or
07767238331**

Website: www.djg-taxis.co.uk

Email: john@djg-taxis.co.uk

The Small Ads

For Sale/Wanted

FOR SALE

Solid Oak roll top desk. 54 inches long by 30 inches wide by 40 inches high. Excellent condition £300 o.n.o
Contact 07849 240682 or 01629 650790 for more details

Non-business adverts in this section are free to village residents

Contact the editor if you wish to place an advert here

Resources

Community Transport

A Dial-a-Bus service for elderly &/or disabled people operates on the 1st and 3rd Thursday each month to Buxton arriving 11.15am & departing 1.15pm. To reserve a seat, contact 641920

Jubilee Field

The pitches & pavilion are available for hire. For all bookings, contact Jasmine Banks on 07580005179 or email her at jazzb22@hotmail.co.uk

Mobile Library

Calls once every 4 weeks on a Friday from 20th September
Duke of York - 10.10 - 10.40am
Call 01629 533190 for details.

Post Office

Outreach Service

Every Thursday in the School House
From 12.30 - 2.30pm

Village Hall

Hire of hall:**New Rates** £7.50 per session or £20 all day for residents & village organisations. Non-residents at reasonable rates. For bookings or more information contact Sue Lightfoot 650641

Winster Surgery Hours

Mon – Fri 8.30am to 12noon
Mon & Wed only 2.00pm to 6.00pm

**Each month one Wednesday is not open in the afternoon.
See list on Surgery door**

CROSSWORD SOLUTION

Clues Across: 1.Dawn 3.Midweek 9.Cadage 10.Dangles 11.Dressage 12.Slot 15.Edart (trade) 16.Surge 20.Skye 21.Promptly 23.Abandon 25.Trill 26.Beneath 27.Egas (sage)
Clues Down: 1.Decade 2.Wednesday 4.Indigo 5.Wand 6.Eel 7.Measure 8.Hsats (stash) 13.Lightning 14.Submits 17.Usual 18.Strenut (tuners) 19.Cycles 22.Idle 24.Ale

Village Directory

- **Badminton** Kate French 650273
- **Bell Ringers** Richard Freemantle 07871450149
- **Bus services** Timetable 0870 6082608
- **Community transport** 641920
- **County Council** 08456 058 058
- **Cricket Club** Glynn Yates 650494
- **Crime Stoppers** 0800 555 111
- **Darts Teams** Paul Carson 650359
- **District Council** 761100
- **Doctors** (Winster) 650207 Emergencies 733205 or NHS Direct 0845 4647
- **Electrical emergencies** 0800 6783 105 or New national 3 digit number 105
- **Energy Efficiency Grants** 761304
- **Fire advice** 582849
- **Gas leaks** 0800 111999
- **History Group** Lynn Burnet 650015
- **Hospital** The Whitworth, Darley Dale (minor injury only) 580211
- **Housing advice** 761311
- **Jubilee Field** Jasmine Banks 07580005179
- **Mobility Scooter** (Tissington Trail) for more details contact 01335 343156 - seasonal only
- **Pre-schools locally** - see page 8 for details
- **Police** For emergencies dial 999 otherwise dial the NEW number 101 (It's confidential)
- **Power Cut?** Call 105
- **Rail services** Enquiries 0845 7484950
- **Refuse collection** DDDC 761122
- **School** 650282
- **School PTFA** Natalie Cooper 650561
- **Swimming pool** Bakewell - 814205 Matlock - Arc Leisure - 581322
- **Taxi Service** - Kate or Neil 07816 201746
- **Tourist information** Bakewell - 813227 Matlock - 583388
- **Village Hall** Bookings Sue Lightfoot 650641
- **Water emergencies** 0800 7834444